



# COUNTY OF IMPERIAL

## ROAD REHABILITATION PROJECT FOR VARIOUS COUNTY ROADS AT GATEWAY OF THE AMERICAS COUNTY PROJECT NO. 6622GTW



### GENERAL NOTES

#### STREET IMPROVEMENT GENERAL NOTES

- COUNTY ENCROACHMENT PERMIT CONDITIONS AND PROVISIONS SHALL TAKE PRECEDENCE OVER THE APPROVED PLANS AND SPECIFICATIONS FOR ANY CONFLICTS.
- THE STRUCTURAL SECTIONS SHALL BE IN ACCORDANCE WITH IMPERIAL COUNTY STANDARDS (OR CALTRANS IF IN STATE ROW) AND AS APPROVED BY THE PUBLIC WORKS DIRECTOR (OR CALTRANS).
- APPROVAL OF THESE IMPROVEMENT PLANS AS SHOWN DOES NOT CONSTITUTE APPROVAL OF ANY CONSTRUCTION OUTSIDE THE PROJECT BOUNDARY.
- ALL UNDERGROUND UTILITIES WITHIN THE STREET RIGHT-OF-WAY SHALL BE CONSTRUCTED, CONNECTED AND TESTED PRIOR TO CONSTRUCTION OF BERM, CURB, CROSS-GUTTER AND PAVING.
- THE EXISTENCE AND LOCATION OF EXISTING UNDERGROUND FACILITIES SHOWN ON THESE PLANS WERE OBTAINED BY A SEARCH OF THE AVAILABLE RECORDS. TO THE BEST OF OUR KNOWLEDGE, THERE ARE NO OTHER EXISTING FACILITIES EXCEPT AS SHOWN ON THESE PLANS. HOWEVER, THE CONTRACTOR IS REQUIRED TO TAKE PRECAUTIONARY MEASURES TO PROTECT ANY EXISTING FACILITY SHOWN HEREON AND ANY OTHER WHICH IS NOT OF RECORD OR NOT SHOWN ON THESE PLANS.
- LOCATION AND ELEVATIONS OF IMPROVEMENTS TO BE MET BY WORK TO BE DONE SHALL BE CONFIRMED BY FIELD MEASUREMENTS PRIOR TO CONSTRUCTION OF NEW WORK. CONTRACTOR WILL MAKE EXPLORATORY EXCAVATIONS AND LOCATE EXISTING UNDERGROUND FACILITIES SUFFICIENTLY AHEAD OF CONSTRUCTION TO PERMIT REVISIONS TO PLANS IF REVISION ARE NECESSARY BECAUSE OF ACTUAL LOCATION OF EXISTING FACILITIES.
- UTILITIES COORDINATION

NO LESS THAN 3 WORKING DAYS PRIOR TO ANY EXCAVATION OR TRENCHING, EACH CONTRACTOR DOING SUCH WORK SHALL CONTACT THE FOLLOWING AGENCIES SO THAT EXISTING UNDERGROUND UTILITIES MAY BE LOCATED. THE AGENCY MAY REQUIRE AN INSPECTOR TO BE PRESENT.

GAS: TELEPHONE NO. 811  
ID POWER: TELEPHONE NO. (760) 339-9280  
ID WATER: TELEPHONE NO. (760) 339-6263  
AT&T TELEPHONE: TELEPHONE NO. (800) 422-4133  
SPECTRUM: TELEPHONE NO. (760)

#### EXISTING UNDERGROUND UTILITIES

BEFORE EXCAVATING FOR THIS CONTRACT, VERIFY LOCATION OF UNDERGROUND UTILITIES. THE EXISTENCE AND LOCATION OF ANY UNDERGROUND UTILITY PIPES OR STRUCTURES SHOWN ON THESE PLANS HAS BEEN OBTAINED FROM AVAILABLE RECORDS ONLY AND MAY NOT REFLECT ALL EXISTING UTILITIES. LOCATION OF ALL EXISTING UTILITIES SHALL BE CONFIRMED BY FIELD MEASUREMENTS BY CONTRACTOR PRIOR TO CONSTRUCTION OF WORK.

CONTRACTOR IS REQUIRED TO TAKE PRECAUTIONARY MEASURES TO PROTECT THE UTILITY LINES SHOWN HEREON AND ANY OTHER EXISTING LINES NOT OF RECORD OR NOT SHOWN ON THESE PLANS.

ACCURATE VERIFICATIONS AS TO SIZE, LOCATION AND DEPTH OF EXISTING UNDERGROUND SERVICES SHALL BE THE CONTRACTOR'S RESPONSIBILITY. THE CONTRACTOR SHALL NOTIFY THE SOUTHERN CALIFORNIA GAS COMPANY, IMPERIAL IRRIGATION DISTRICT AND ANY OTHER AFFECTED UTILITY AGENCIES PRIOR TO STARTING HIS WORK NEAR SUCH UTILITY FACILITIES AND SHALL COORDINATE HIS WORK WITH UTILITY REPRESENTATIVES. FOR LOCATION OF UNDERGROUND UTILITIES AND APPURTENANCES, CONTACT "UNDERGROUND SERVICE ALERT" AT 811.

- IT SHALL BE THE RESPONSIBILITY OF THE DEVELOPER TO CONTACT THE UTILITY AGENCIES, ADVISE THEM OF THE PROPOSED IMPROVEMENTS AND BEAR THE COST OF RELOCATIONS, IF NEEDED.

- CONSTRUCT A PUBLIC STREET LIGHT SYSTEM CONFORMING TO APPROPRIATE STANDARDS AND STREET LIGHT SPECIFICATIONS. POWER SOURCES AND RUNS SHALL BE SHOWN ON THE "AS-BUILT" IMPROVEMENT DRAWINGS. ALL POWER SOURCES SHALL BE LOCATED WITHIN THE DEDICATED RIGHT-OF-WAY OR EASEMENT.

- NO PAVING SHALL BE DONE UNTIL EXISTING POWER POLES ARE RELOCATED OUTSIDE THE AREA TO BE PAVED.

- PRIVATE ROAD IMPROVEMENTS SHOWN HEREON ARE FOR INFORMATION ONLY. COUNTY OFFICIALS SIGNATURE HEREON DOES NOT CONSTITUTE APPROVAL OR RESPONSIBILITY OF ANY KIND FOR THE DESIGN OR CONSTRUCTION OF THESE PRIVATE IMPROVEMENTS.

- ALL SIGNS TO BE ALUMINUM WITH 3M HIGH INTENSITY TYPE REFLECTIVE FACE OR EQUIVALENT.

- CONTRACTOR WILL BE RESPONSIBLE FOR THE REPLACEMENT OF ANY STRIPING, PAVEMENT MARKERS, OR LEGENDS OBLITERATED BY THE CONSTRUCTION OF THIS PROJECT.

- THE CONTRACTOR SHALL DO ALL NEW STRIPING AND SANDBLASTING OF REDUNDANT STRIPING.

- THE CONSTRUCTION OF ONE POC STANDARD DRIVEWAY PER LOT. LOCATION TO BE DETERMINED IN THE FIELD BY THE ENGINEER OF WORK. POC SURFACING OF DRIVEWAY TO EXTEND FROM CURB TO PROPERTY LINE UNLESS OTHERWISE SHOWN.

- THE CONTRACTOR SHALL BE RESPONSIBLE TO SECURE AN ENCROACHMENT PERMIT FROM THE COUNTY OF IMPERIAL DEPARTMENT OF PUBLIC WORKS FOR ANY EXCAVATION OR CONSTRUCTION WITHIN COUNTY ROAD RIGHT-OF-WAY. FOR INSPECTIONS, 48 HOUR MINIMUM NOTICE IS REQUIRED, (760) 482-4482. ADDITIONALLY, UNDERGROUND SERVICE ALERT (USA) MUST BE CALLED TWO WORKING DAYS BEFORE THE CONTRACTOR MAY EXCAVATE. THEIR CONTACT NUMBER IS 811. ALL WORK AND MATERIALS ARE SUBJECT TO THE INSPECTION AND APPROVAL FROM THE COUNTY DEPARTMENT OF PUBLIC WORKS OR THEIR REPRESENTATIVE.

- NO REVISIONS OF ANY KIND SHALL BE MADE TO THESE PLANS WITHOUT THE PRIOR WRITTEN APPROVAL OF BOTH THE COUNTY ENGINEER (OR HIS REPRESENTATIVE) AND THE ENGINEER OF RECORD. A REPRODUCIBLE AS-BUILT PLAN SET WILL BE PROVIDED TO THE PUBLIC WORKS DEPARTMENT AS A CONDITION OF SUBSTANTIAL CONSTRUCTION COMPLETION AND PRIOR TO ACCEPTANCE.
- ALL WORK AND MATERIALS SHALL CONFORM TO THESE PLANS AND SPECIFICATIONS, THE IMPERIAL COUNTY DEPARTMENT OF PUBLIC WORKS STANDARDS AND ENCROACHMENT PERMIT CONDITIONS, ANY REFERENCED STANDARDS AND SPECIFICATIONS AND THE SPECIFICATIONS & THE REQUIREMENTS OF THE AGENCIES REFERRED TO HEREIN. ALL WORK SHOWN OR INDICATED BY THESE PLANS SHALL BE COMPLETED IN ACCORDANCE WITH THE STANDARDS, POLICIES AND REGULATIONS OF IMPERIAL COUNTY; WHERE, OR IF, CONFLICTS OCCUR, THEN THE IMPERIAL COUNTY REQUIREMENTS SHALL GOVERN.
- UNLESS SPECIFICALLY INDICATED OTHERWISE METHODS EMPLOYED AND MATERIAL USED IN THE CONSTRUCTION OF ALL OFFSITE IMPROVEMENTS SHALL CONFORM TO THE APPLICABLE PROVISIONS OF THE "STATE OF CALIFORNIA, DEPARTMENT OF TRANSPORTATION STANDARD SPECIFICATIONS DATED MAY 2008". ALL WORK IS SUBJECT TO INSPECTION AND APPROVAL AS REQUIRED.
- IT SHALL BE THE RESPONSIBILITY OF THE CONTRACTOR TO OBTAIN AN EXCAVATION PERMIT FROM THE STATE OF CALIFORNIA DIVISION OF SAFETY AND TO ADHERE TO ALL PROVISIONS OF THE STATE CONSTRUCTION SAFETY ORDERS AND STANDARDS.
- IT SHALL BE THE CONTRACTOR'S RESPONSIBILITY TO OBTAIN A GENERAL CONSTRUCTION ACTIVITY STORM WATER PERMIT FROM THE STATE WATER RESOURCES CONTROL BOARD DIVISION OF WATER QUALITY CONTACT "STATE WATER RESOURCES CONTROL BOARD, DIVISION OF WATER QUALITY, ATTENTION: STORM WATER PERMIT UNIT, P.O. BOX 1877, SACRAMENTO, CALIFORNIA, 95812".
- CONSTRUCTION PROJECTS DISTURBING MORE THAN ONE ACRE MUST OBTAIN A NATIONAL POLLUTANT DISCHARGE ELIMINATION SYSTEM (NPDES) PERMIT. OWNER/DEVELOPERS ARE REQUIRED TO FILE A NOTICE OF INTENT (NOI) WITH THE STATE WATER RESOURCES CONTROL BOARD, PREPARE A STORM WATER POLLUTION PREVENTION PLAN (SWPPP) AND MONITORING PLAN FOR THE SITE.

- AS DETERMINED BY THE COUNTY PUBLIC WORKS DIRECTOR/ROAD COMMISSIONER, THE DEVELOPER IS RESPONSIBLE, AS A MINIMUM, FOR ROAD IMPROVEMENTS TO CENTERLINE, AND MAY BE REQUIRED TO RECONSTRUCT EXISTING PAVEMENT, INCLUDING BASE, AND MATCHING OVERLAY REQUIRED TO MEET THE STRUCTURAL STANDARDS FOR THE CURRENT ASSIGNED TRAFFIC INDEX.

- EXISTING STORM DRAIN PIPES/CULVERTS WHETHER TO BE CONNECTED TO, EXTENDED, ADJUSTED, DRAINED TO, OR JUST IN PROJECT VICINITY SHALL BE REPAIRED AND/OR CLEANED TO MAKE THEM FUNCTIONAL AND ACCEPTABLE AS DIRECTED BY THE PUBLIC WORKS DIRECTOR.

- TRAFFIC CONTROL SHALL BE IN ACCORDANCE WITH THE CURRENT WORK AREA TRAFFIC CONTROL HANDBOOK OR AS DIRECTED BY THE IMPERIAL COUNTY TRAFFIC ENGINEER.

- ANY EXISTING SURVEY MONUMENTS OR COUNTY RECOGNIZED BENCHMARKS SHALL BE PROTECTED BY THE CONTRACTOR. SHOULD ANY SUCH MONUMENTS OR BENCHMARKS BE REMOVED, DAMAGED, OBLITERATED OR ALTERED BY THE CONTRACTOR'S OPERATIONS, THE CONTRACTOR SHALL BE RESPONSIBLE FOR PROPER RESETTLEMENT OF THE SAME AS PER THE SUBDIVISION MAP ACT, THE PROFESSIONAL LAND SURVEYORS ACT AND THE SATISFACTION OF THE COUNTY SURVEYOR/DIRECTOR OF PUBLIC WORKS. SUCH POINTS SHALL BE REFERENCED AND REPLACED WITH APPROPRIATE MONUMENTATION BY A LICENSED LAND SURVEYOR OR A REGISTERED CIVIL ENGINEER AUTHORIZED TO PRACTICE LAND SURVEYING. A CORNER RECORD OR RECORD OF SURVEY AS APPROPRIATE SHALL BE FILED BY THE LICENSED LAND SURVEYOR OR REGISTERED CIVIL ENGINEER.

- DUST SHALL BE CONTROLLED BY THE CONTRACTOR IN ACCORDANCE WITH ALL IMPERIAL COUNTY AIR POLLUTION CONTROL DISTRICT (APCD) FUGITIVE DUST CONTROL RULES AND REGULATIONS AND SHALL COMPLY WITH THEIR PERMITTING REQUIREMENTS, IF APPLICABLE.

- THE NOTES LISTED ABOVE ARE A MINIMUM LIST. THIS DOES NOT RELIEVE THE ENGINEER FROM COMPLYING ADDITIONAL NOTES THAT MAY BE REQUIRED FOR THE PROJECT.

#### GRADING PLAN GENERAL NOTES

- APPROVAL OF THIS GRADING PLAN DOES NOT CONSTITUTE APPROVAL OF VERTICAL OR HORIZONTAL ALIGNMENT OF ANY PRIVATE ROAD SHOWN HEREON FOR COUNTY ROAD PURPOSES.
- FINAL APPROVAL OF THESE GRADING PLANS SUBJECT TO FINAL APPROVAL OF THE ASSOCIATED IMPROVEMENT PLANS WHERE APPLICABLE. FINAL CURB GRADE ELEVATIONS MAY REQUIRE CHANGES IN THESE PLANS.
- IMPORT MATERIAL SHALL BE OBTAINED FROM A LEGAL SITE.
- THE CONTRACTOR SHALL BE RESPONSIBLE TO SECURE AN ENCROACHMENT PERMIT FROM THE COUNTY OF IMPERIAL DEPARTMENT OF PUBLIC WORKS FOR ANY EXCAVATION OR CONSTRUCTION WITHIN COUNTY ROAD RIGHT-OF-WAY. FOR INSPECTIONS, 48 HOUR MINIMUM NOTICE IS REQUIRED, (760) 482-4482. ADDITIONALLY, UNDERGROUND SERVICE ALERT (USA) MUST BE CALLED TWO WORKING DAYS BEFORE THE CONTRACTOR MAY EXCAVATE. THEIR CONTACT NUMBER IS 811. ALL WORK AND MATERIALS ARE SUBJECT TO THE INSPECTION AND APPROVAL OF THE COUNTY DEPARTMENT OF PUBLIC WORKS.
- THE CONTRACTOR SHALL VERIFY THE EXISTENCE AND LOCATION OF ALL UTILITIES BEFORE COMMENCING WORK. NOTICE OF PROPOSED WORK SHALL BE GIVEN TO THE FOLLOWING AGENCIES:

GAS: TELEPHONE NO. 811  
ID POWER: TELEPHONE NO. (760) 339-9280  
ID WATER: TELEPHONE NO. (760) 339-6263  
AT&T TELEPHONE: TELEPHONE NO. (800) 422-4133  
SPECTRUM: TELEPHONE NO. (760)  
CITY OF BRALEY PUBLIC WORKS: (760) 344-5800

- A SOILS REPORT MAY BE REQUIRED PRIOR TO THE ISSUANCE OF A BUILDING PERMIT AND/OR GRADING PLAN APPROVAL.
- APPROVAL OF THESE PLANS BY THE DIRECTOR OF PUBLIC WORKS DOES NOT AUTHORIZE ANY WORK OR GRADING TO BE PERFORMED UNTIL THE PROPERTY OWNER'S PERMISSION HAS BEEN OBTAINED AND VALID GRADING PERMIT HAS BEEN ISSUED BY THE COUNTY PLANNING DEPARTMENT.
- THE DIRECTOR OF PUBLIC WORKS' APPROVAL OF THESE PLANS DOES NOT CONSTITUTE COUNTY BUILDING OFFICIAL APPROVAL OF ANY FOUNDATION FOR STRUCTURES TO BE PLACED ON THE ITEMS COVERED BY THESE PLANS, INCLUDING ANY ONSITE OR PERIMETER SCREEN OR RETAINING WALLS.
- ALL MAJOR SLOPES SHALL BE ROUNDED INTO EXISTING TERRAIN TO PRODUCE A CONTOURED TRANSITION FROM CUT OR FILL FACES TO NATURAL GROUND AND ADJUTING CUT OR FILL SURFACES.
- NOTWITHSTANDING THE MINIMUM STANDARDS SET FORTH IN THE GRADING ORDINANCE AND NOTWITHSTANDING THE APPROVAL OF THESE GRADING PLANS, THE PERMITTEE IS RESPONSIBLE FOR THE PREVENTION OF DAMAGE TO ADJACENT PROPERTY. NO PERSON SHALL EXCAVATE ON LAND SO CLOSE TO THE PROPERTY LINE AS TO ENDANGER ANY SUCH PROPERTY FROM SETTLING, CRACKING, EROSION, SILTING, SCOUR OR OTHER DAMAGE, WHICH MIGHT RESULT FROM THE GRADING DESCRIBED ON THE PLAN. THE COUNTY WILL HOLD THE PERMITTEE RESPONSIBLE FOR CORRECTION OF NON-DEDICATED IMPROVEMENTS WHICH DAMAGE ADJACENT PROPERTY.
- SPECIAL CONDITION: IF ANY ARCHEOLOGICAL RESOURCES ARE DISCOVERED ON THE SITE OF THIS GRADING OPERATION, SUCH OPERATION WILL CEASE IMMEDIATELY AND THE PERMITTEE WILL NOTIFY THE DIRECTOR OF THE PLANNING DEPARTMENT AND THE DISCOVERY GRADING OPERATION WILL NOT COMMENCE UNTIL THE PERMITTEE HAS RECEIVED WRITTEN AUTHORITY FROM THE DIRECTOR OF PLANNING TO DO SO.

- THE CONSTRUCTION OF ONE POC STANDARD DRIVEWAY PER LOT. LOCATION TO BE DETERMINED IN THE FIELD BY THE ENGINEER OF WORK AND APPROVED BY COUNTY PUBLIC WORKS INSPECTOR. POC SURFACING OF DRIVEWAY TO EXTEND FROM CURB TO PROPERTY LINE.

- ALL GRADING SHALL CONFORM TO THE UNIFORM BUILDING CODE APPENDIX CHAP. 33, AS AMENDED BY TITLE 8 LAND USE ORDINANCE.

- ALL PROPERTY CORNERS SHALL BE CLEARLY DELINEATED IN THE FIELD PRIOR TO THE COMMENCEMENT OF ANY CONSTRUCTION AND/OR GRADING.

- DURING ROUGH GRADING OPERATIONS AND PRIOR TO THE CONSTRUCTION OF ANY PERMANENT DRAINAGE STRUCTURES, TEMPORARY DRAINAGE CONTROL SHALL BE PROVIDED TO PREVENT PONDING WATER AND DAMAGE TO CONTIGUOUS PROPERTIES.

- DUST SHALL BE CONTROLLED IN ACCORDANCE WITH THE APPROVED PM10 PLAN. APPROVAL SHALL BE BY IMPERIAL COUNTY AIR POLLUTION CONTROL DISTRICT.

- NO FILL SHALL BE PLACED ON EXISTING GROUND UNTIL THE EXISTING GROUND HAS BEEN CLEARED OF WEEDS, DEBRIS, TOPSOIL AND OTHER DELETERIOUS MATERIAL.

- THE MAXIMUM ALLOWABLE CUT AND FILL SLOPES ARE 2:1, UNLESS A SLOPE STABILITY ANALYSIS AUTHORIZES A STEEPER SLOPE AND HAS BEEN APPROVED.

- A 5' WIDE BY 1' HIGH BERM, OR EQUIVALENT, SHALL BE CONSTRUCTED ALONG THE TOP OF ALL FILL SLOPES OVER 5' IN VERTICAL HEIGHT. ALL SLOPES LESS THAN OR EQUAL TO 5' SHALL HAVE A BERM TO PREVENT DRAINAGE FROM ERODING SAME.

- A BROW DITCH DESIGNED TO HANDLE THE FLOWS (Q) FROM A 100-YR. STORM EVENT SHALL BE CONSTRUCTED ALONG THE TOP OF ALL CUT SLOPES.

- NO OBSTRUCTION OF FLOOD PLAINS OR NATURAL WATER COURSES WILL BE PERMITTED.

- ALL EXISTING DRAINAGE COURSES ON THE PROJECT SITE MUST CONTINUE TO FUNCTION DURING STORM CONDITIONS. PROTECTIVE MEASURES AND TEMPORARY DRAINAGE PROVISIONS MUST BE USED TO PROTECT CONTIGUOUS PROPERTIES DURING GRADING OPERATIONS.

- THE FINISHED GRADE SHALL BE SLOPED AWAY FROM ALL EXTERIOR BUILDING WALLS AT NOT LESS THAN 4% (1/2" PER FOOT) FOR A MINIMUM OF 3 FEET, UNLESS A SOIL REPORT PROVIDES ALTERNATE RECOMMENDATIONS.

- A SUITABLY QUALIFIED AND REGISTERED ENGINEER OR SURVEYOR SHALL SUBMIT A WRITTEN CERTIFICATION TO THE PUBLIC WORKS DEPARTMENT THAT THE FINAL GRADING HAS BEEN COMPLETED IN ACCORDANCE WITH THE APPROVED PLANS FOR ALL GRADING DESIGNATED AS "ENGINEERED GRADING". AS-BUILT PLANS SHALL BE PROVIDED PRIOR TO FINAL ACCEPTANCE.

- THE CONTRACTOR SHALL NOTIFY THE PUBLIC WORKS DEPARTMENT AT LEAST 48 HOURS IN ADVANCE OF REQUESTING A FINISH LOT GRADE AND DRAINAGE INSPECTION. THIS INSPECTION MUST BE APPROVED PRIOR TO THE BUILDING PERMIT FINAL INSPECTION BY PUBLIC WORKS FOR EACH LOT.

- THE CONTRACTOR SHALL NOTIFY "UNDERGROUND SERVICE ALERT" AT 811 A MINIMUM OF TWO DAYS PRIOR TO THE COMMENCEMENT OF ANY DIGGING OR EXCAVATION.



### VICINITY MAP

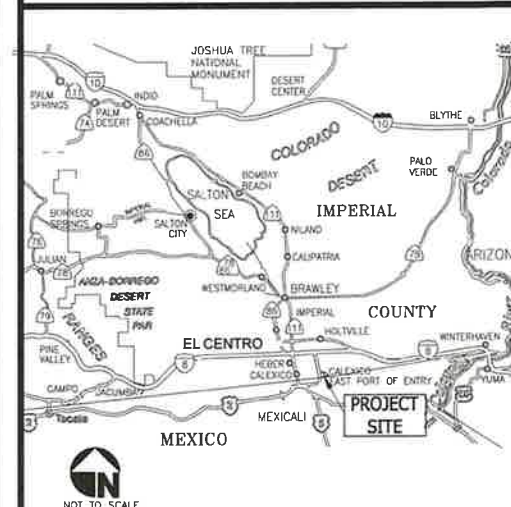

### ABBREVIATIONS

AGG.	AGGREGATE	MIN	MINIMUM
APPROX.	APPROXIMATE	N	NORTH
ASPH.	ASPHALT	NO	NORTH OF
B.M.	BENCHMARK	N.T.S.	NOT TO SCALE
C OR CL	CENTERLINE	OHE	OVER HEAD ELECTRIC
CLR	CLEARANCE	PROP.	PROPOSED
CONC.	CONCRETE	R/W OR ROW	RIGHT-OF-WAY
E	EAST	RD	ROAD
E/O	EAST OF	STA.	STATION
E.P.	EDGE OF PAVEMENT	S	SEWER
EL. OR ELEV.	ELEVATION	SD	STORM DRAIN
EX. OR EXIST.	EXISTING	T.P.	TOP OF PAVEMENT
F.L.	FLOW LINE	THK.	THICK
F.S.	FINISH SURFACE	TYP	TYPICAL
L.F.	LINEAL FEET	W	WATER
MAX	MAXIMUM	W/O	WEST OF

TOPOGRAPHICAL FIELD SURVEY AND AERIAL SURVEY CONDUCTED BY DYNAMIC CONSULTING ENGINEERS ON DECEMBER 2018  
MAP AND DIGITAL DATA PREPARED FOR: COUNTY OF IMPERIAL  
SURVEY GROUND CONTROL PROVIDED BY: DYNAMIC CONSULTING ENGINEERS, INC.

#### DECLARATION OF RESPONSIBLE CHARGE

I HEREBY DECLARE THAT I AM THE ENGINEER OF WORK FOR THIS PROJECT, THAT I HAVE EXERCISED RESPONSIBLE CHARGE OVER THE DESIGN OF THE PROJECT AS DEFINED IN SECTION 6703 OF THE BUSINESS AND PROFESSIONS CODE AND THAT THE DESIGN IS CONSISTENT WITH CURRENT STANDARDS.

I UNDERSTAND THAT THE CHECK OF PROJECT DRAWINGS AND SPECIFICATIONS BY THE COUNTY OF IMPERIAL IS CONFINED TO A REVIEW ONLY AND DOES NOT RELIEVE ME, AS ENGINEER OF WORK, OF MY RESPONSIBILITIES FOR THE PROJECT DESIGN.

CARLOS BELTRAN, P.E.  
R.C.E. 88121  
EXP. DATE: 06/30/2026

6/1/25  
DATE

### SYMBOLS

ITEM NO.	ITEM	SYMBOL
1	STREET RAW LINE	
2	STREET CV	
3	CABLE TV	CABLE
4	DRAIN (FIELD)	D
5	EX. EDGE OF ASPHALT	
6	PROP. EDGE OF ASPHALT	
7	EX. ASPHALT CONCRETE	
8	PROP. ASPHALT CONCRETE	
9	EDGE OF DIRT	
10	CONCRETE SECTION	
11	ROAD STRIPING	
12	CONTOURS - MAJOR	
13	CONTOURS - MINOR	
14	CONTROL	
15	SPOT ELEVATION	
16	BENCHMARK (SEE DESCRIPTION)	
17	BORROW PIT ELEVATIONS	
18	PROPOSED BORROW PIT	
19	LIMIT OF RECONSTRUCTION	

### SHEET INDEX

- TITLE SHEET AND GENERAL NOTES
- KEY MAP
- LOS ALAMOS ROAD
- PAN AMERICAN ROAD
- ROOD ROAD STA 10+55 TO STA 33+00
- ROOD ROAD STA 33+00 TO STA 47+75
- ZINETTA ROAD
- MENVILLE ROAD
- NINA LEE ROAD
- MAGGIO ROAD
- TRAFFIC CONTROL PLAN GENERAL NOTES
- TRAFFIC CONTROL PLAN PAN AMERICAN ROAD AND LOS ALAMOS ROAD
- TRAFFIC CONTROL PLAN ZINETTA ROAD
- TRAFFIC CONTROL PLAN ROOD ROAD
- TRAFFIC CONTROL PLAN MAGGIO ROAD PHASE 1
- TRAFFIC CONTROL PLAN MAGGIO ROAD PHASE 2
- TRAFFIC CONTROL PLAN MENVILLE ROAD PHASE 1
- TRAFFIC CONTROL PLAN MENVILLE ROAD PHASE 2
- TRAFFIC CONTROL PLAN NINA LEE ROAD PHASE 1 AND 3
- TRAFFIC CONTROL PLAN NINA LEE ROAD PHASE 2
- DETAILS

**Dynamic** CONSULTING ENGINEERS

CIVIL ENGINEERING - LAND SURVEYING - CONSTRUCTION MANAGEMENT  
2415 IMPERIAL BUSINESS PARK DRIVE, SUITE B,  
IMPERIAL, CA 92251

TEL (760) 545-0162

FAX (760) 545-0163

REV.	DATE	REVISION DESCRIPTION



PREPARED UNDER THE DIRECT SUPERVISION OF:

CARLOS BELTRAN, P.E.  
69121 R.C.E. No.

6/30/2026  
REG. EXP.



COUNTY OF IMPERIAL PUBLIC WORKS DEPARTMENT  
APPROVED FOR CONSTRUCTION BY:

JOHN A. GAY, P.E.  
62028 R.C.E. No.

6/2/25  
DATE



DATE: 6/14/2025

DRAWN: DB, FM

SCALE: AS SHOWN

CHECKED: CB

ROAD REHABILITATION PROJECT FOR  
VARIOUS COUNTY ROADS  
AT GATEWAY OF THE AMERICAS  
COUNTY PROJECT NO. 6622GTW

### TITLE SHEET

REFERENCE

R-999

PAGE  
1 OF 21



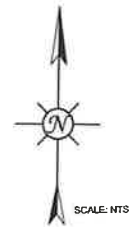
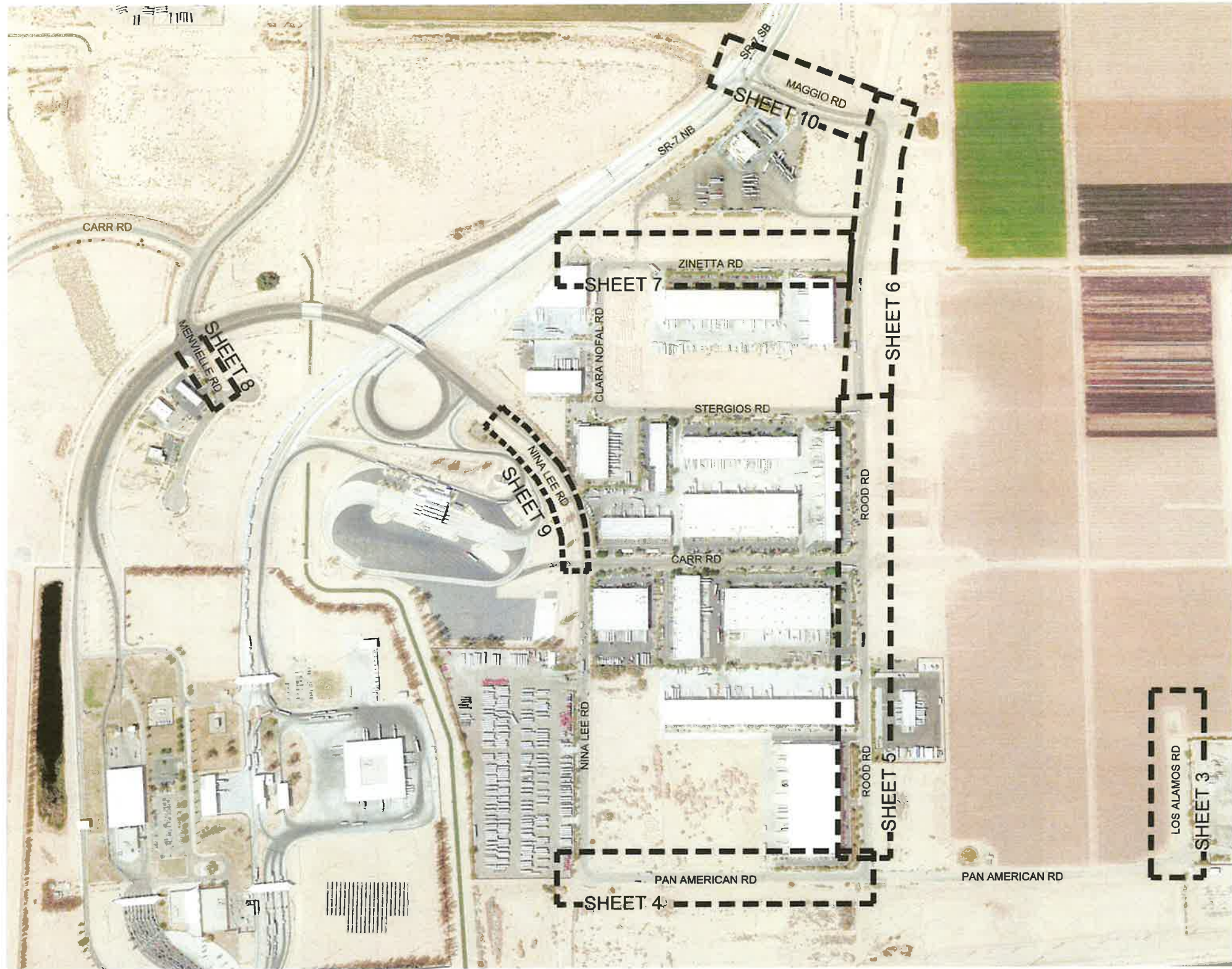

**Dynamic** CONSULTING ENGINEERS

CIVIL ENGINEERING - LAND SURVEYING - CONSTRUCTION MANAGEMENT  
2415 IMPERIAL BUSINESS PARK DRIVE, SUITE B.,  
IMPERIAL, CA 92251  
TEL (760) 545-0162 FAX (760) 545-0163

REV.	DATE	REVISION DESCRIPTION



PREPARED UNDER THE DIRECT SUPERVISION OF:  
  
CARLOS BELTRAN, P.E.  
69121 R.C.E. No.  
06/30/2026 REG. EXP.  
DATE



COUNTY OF IMPERIAL PUBLIC WORKS DEPARTMENT  
APPROVED FOR CONSTRUCTION BY:  
  
JOHN A. GAY, P.E.  
62028 R.C.E. No.  
09/30/2025 REG. EXP.  
DATE

PUBLIC WORKS DEPARTMENT  
**COUNTY OF IMPERIAL**  
EL CENTRO, CALIFORNIA

DATE	5/14/2025
DRAWN	DB FM
SCALE	AS SHOWN
CHECKED	CB

**ROAD REHABILITATION PROJECT FOR  
VARIOUS COUNTY ROADS  
AT GATEWAY OF THE AMERICAS**  
COUNTY PROJECT NO. 6622GTW

KEY MAP	
REFERENCE <b>R-999</b>	PAGE 2 OF 21



LEGEND

- TYPE II SLURRY SEAL
- 2" GRIND AND AC OVERLAY
- DIG OUT AREA, NEW AC AND CLASS II BASE

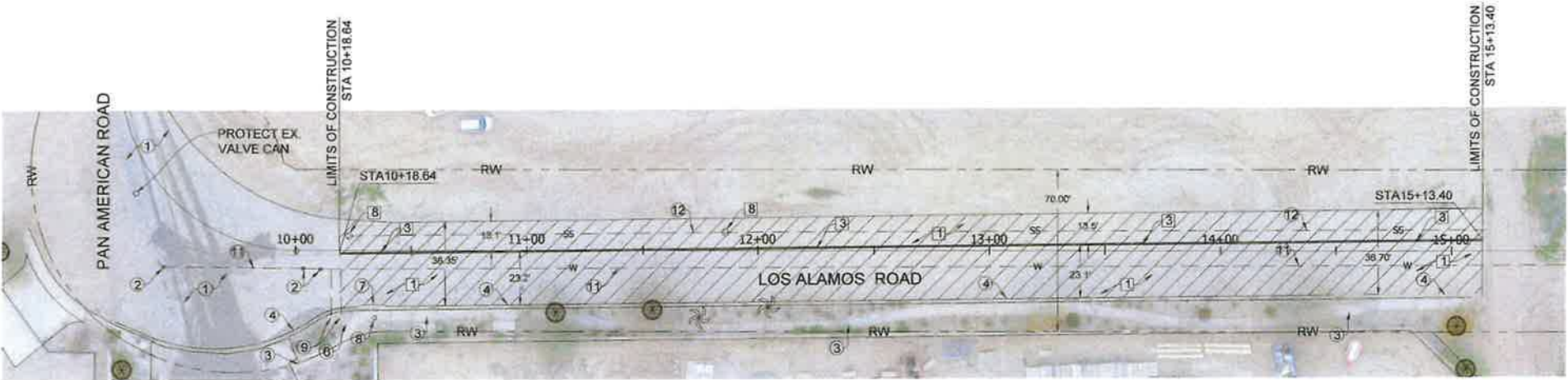

LOS ALAMOS ROAD  
STA 10+18.64 TO STA 15+13.40

EXISTING KEYNOTES:

- 1 EXISTING A.C. PAVEMENT TO REMAIN.
- 2 EXISTING WATER VALVE TO REMAIN.
- 3 EXISTING SIDEWALK TO REMAIN.
- 4 EXISTING CURB AND GUTTER TO REMAIN.
- 5 EXISTING POWER/TELEPHONE OR LIGHT POLE TO REMAIN.
- 6 EXISTING SIGN TO REMAIN.
- 7 EXISTING CATCH BASIN TO REMAIN.
- 8 EXISTING STORM DRAIN PIPE/MAINHOLE TO REMAIN.
- 9 EXISTING WATER METER TO REMAIN.
- 10 EXISTING WATER FIRE HYDRANT TO REMAIN.
- 11 EXISTING WATER LINE TO REMAIN.
- 12 EXISTING SEWER LINE/MAINHOLE TO REMAIN.
- 13 EXISTING UTILITY MANHOLE TO REMAIN.
- 14 EXISTING ELECTRICAL METER TO REMAIN.
- 15 EXISTING UTILITY BOX/METER TO REMAIN.
- 16 EXISTING AC DIKE TO REMAIN.
- 17 EXISTING STRIPING OR MARKING TO REMAIN.

CONSTRUCTION KEYNOTES

- 1 INSTALL TYPE II SLURRY SEAL. PRIOR TO INSTALLATION OF SLURRY SEAL, PROVIDE CRACK SEALANT. SEE CONSTRUCTION NOTES.
- 3 INSTALL DOUBLE YELLOW NO PASSING LINE PER CALTRANS STANDARD PLAN 420A DETAIL 21.
- 8 PROTECT IN PLACE. CONTRACTOR TO PROTECT MANHOLES, VALVES, SURVEY MONUMENTS AND MISCELLANEOUS FRAMES AND COVERS.

CONSTRUCTION NOTES:

- SLURRY SEAL SHALL NOT BE APPLIED OVER ANY MANHOLE, VALVE, SURVEY MONUMENT, OR MISCELLANEOUS FRAMES AND COVERS. ANY MATERIAL USED TO PROTECT SUCH DEVICES SHALL BE REMOVED AND DISPOSED OF LAWFULLY BY THE CONTRACTOR.
- WORK SHALL BE COMPLETED IN TWO PARTS (HALF STREET EACH PART) TO ALLOW FOR INGRESS TO TRAFFIC.
- ALL ROADS WHERE SLURRY SEAL WILL BE APPLIED SHALL BE PROPERLY SWEEPED AND BE FREE FROM DUST, MOISTURE, DEBRIS AND LOOSE PARTICLES PRIOR TO SLURRY SEAL PLACEMENT.
- ALL ROADS WHERE SLURRY SEAL IS APPLIED SHALL BE FULLY SWEEPED 5 TO 8 DAYS AFTER SLURRY IS COMPLETE, WITH RESIDUAL MATERIAL REMOVED AND DISPOSED TO A LEGAL DISPOSAL SITE.
- PRIOR TO APPLYING CRACK SEALANT, THE PAVEMENT SURFACE SHALL BE DRY. CRACKS AND JOINTS SHALL BE CLEANED USING APPROPRIATE ROUTING, BRUSHING OR BLOWING OPERATIONS TO PROVIDE SUFFICIENT CONTACT BONDING SURFACES. CRACKS SHALL BE FREE FROM DUST, MOISTURE, DEBRIS, LOOSE PARTICLES AND OTHER CONTAMINANTS.
- SURVEY MONUMENTS WITHIN SLURRY SEAL AREA
- A PER SECTION 8771(d) OF THE BUSINESS AND PROFESSIONAL CODE, A PERSON AUTHORIZED TO PRACTICE LAND SURVEYING SHALL REFERENCE SURVEY MONUMENTS AND A CORNER RECORD OF THE REFERENCE SHALL BE FILED PRIOR TO CONSTRUCTION.
- PER SECTION 8771(c) OF THE BUSINESS AND PROFESSIONAL CODE, ANY SURVEY MONUMENT THAT IS DESTROYED, DAMAGED, COVERED OR OBLITERATED SHALL BE REPLACED BY A PERSON AUTHORIZED TO PRACTICE LAND SURVEYING AND A CORNER RECORD OF THE MONUMENT SHALL BE FILED PRIOR TO A CERTIFICATE OF COMPLETION OF THE PROJECT IS ISSUED.

Dynamic CONSULTING ENGINEERS

CIVIL ENGINEERING - LAND SURVEYING - CONSTRUCTION MANAGEMENT  
2415 IMPERIAL BUSINESS PARK DRIVE, SUITE B.,  
IMPERIAL, CA. 92251

TEL (760) 545-0162

FAX (760) 545-0163

REV.	DATE	REVISION DESCRIPTION



PREPARED UNDER THE DIRECT SUPERVISION OF:  
  
CARLOS BELTRAN, P.E.  
6/2/25  
DATE

69121  
R.C.E. No.  
09/30/2028  
REG. EXP.



COUNTY OF IMPERIAL PUBLIC WORKS DEPARTMENT  
APPROVED FOR CONSTRUCTION BY:  
  
JOHN A. GAY, P.E.  
6/2/25  
DATE

62028  
R.C.E. No.  
09/30/2025  
REG. EXP.



DATE 6/14/2025  
DRAWN DB, FM  
SCALE AS SHOWN  
CHECKED CB

ROAD REHABILITATION PROJECT FOR  
VARIOUS COUNTY ROADS  
AT GATEWAY OF THE AMERICAS  
COUNTY PROJECT NO. 6622GTW

LOS ALAMOS ROAD

REFERENCE  
R-999

PAGE  
3 OF 21



**TYPE II SLURRY SEAL**

**2" GRIND AND AC OVERLAY**

**DIG OUT AREA. NEW AC AND CLASS II BASE**



**MATCH LINE - STA 17+00  
SEE BOTTOM LEFT**

- 2) EXISTING WATER VALVE TO REMAIN
- 3) EXISTING SIDEWALK TO REMAIN
- 4) EXISTING CURB AND GUTTER TO REMAIN.
- 5) EXISTING POWER/TELEPHONE OR LIGHT POLE TO REMAIN
- 6) EXISTING SIGN TO REMAIN.
- 7) ~~EXISTING CATCH BASIN TO REMAIN~~
- 8) EXISTING STORM DRAIN PIPE/MANHOLE TO REMAIN
- 9) EXISTING WATER METER TO REMAIN.
- 11) ~~EXISTING WATER FIRE HYDRANT TO REMAIN~~
- 11) EXISTING WATER LINE TO REMAIN
- 12) ~~EXISTING SEWER LINE/MANHOLE TO REMAIN~~
- 13) EXISTING UTILITY MANHOLE TO REMAIN
- 13) EXISTING ELECTRICAL METER TO REMAIN
- 19) EXISTING UTILITY BOX/METER TO REMAIN
- 19) EXISTING AC DIKE TO REMAIN
- 17) EXISTING STRIPING OR MARKING TO REMAIN

- 1) INSTALL TYPE II SLURRY SEAL PRIOR TO INSTALLATION OF SLURRY SEAL PROVIDE CRACK SEALANT. SEE CONSTRUCTION NOTES.
- 2) INSTALL 12 INCH WHITE LIMIT LINE PER CALTRANS STANDARD PLAN A24E.
- 3) INSTALL "STOP" PAVEMENT LEGEND PER CALTRANS STANDARD PLAN A24D.
- 4) PROTECT IN PLACE, CONTRACTOR TO PROTECT MANHOLES, VALVES, SURVEY MONUMENTS AND MISCELLANEOUS FRAMES AND COVERS.
- 5) INSTALL YELLOW CENTER LINE PER CALTRANS STANDARD PLAN A20A DETAIL 1.
- 6) COLD PLANE EXISTING A.C. PAVEMENT FOR A THICKNESS OF 0.20-FOOT PER CONSTRUCTION PAVEMENT EXTENSION JOINT PER DETAIL C ON SHEET 21. REMOVE AND DISPOSE OF EXISTING A.C. PAVEMENT MATERIAL.
- 7) REMOVE EXISTING AC PAVEMENT FAILURE AREA AND UNDERLYING BASE MATERIAL AND REPLACE WITH NEW AC PAVEMENT PER CLASS II BASE PER DETAIL D (DIG OUT DETAIL) ON SHEET 21.
- 8) INSTALL FINE HYDRANT BLUE MARKER

SLURRY SEAL SHALL NOT BE APPLIED OVER ANY MANHOLE, VALVE, SURVEY MONUMENT, OR MISCELLANEOUS FRAMES AND COVERS. ANY MATERIAL USED TO PROTECT SUCH DEVICES SHALL BE REMOVED AND DISPOSED OF LAWFULLY BY THE CONTRACTOR.

WORK SHALL BE COMPLETED IN TWO PARTS (HALF STREET EACH PART) TO ALLOW FOR INGRESS TO TRAFFIC.

ALL ROADS WHERE SLURRY SEAL WILL BE APPLIED SHALL BE PROPERLY SWEEP AND BE FREE FROM DUST, MOISTURE, DEBRIS AND LOOSE PARTICLES PRIOR TO SLURRY SEAL PLACEMENT.

ALL ROADS WHERE SLURRY SEAL IS APPLIED SHALL BE FULLY SWEEP 5 TO 8 DAYS AFTER SLURRY IS COMPLETE, WITH RESIDUAL MATERIAL REMOVED AND DISPOSED TO A LEGAL DISPOSAL SITE.

PRIOR TO APPLYING CRACK SEALANT, THE PAVED SURFACE SHALL BE DRY, CRACKS SHALL BE CLEANED USING APPROPRIATE ROUTING, BRUSHING OR BLOWING OPERATIONS TO PROVIDE SUFFICIENT CONTACT BONDING SURFACES. CRACKS SHALL BE FREE FROM DUST, MOISTURE, DEBRIS, LOOSE PARTICLES AND OTHER CONTAMINANTS.

SURVEY MONUMENTS WITHIN SLURRY AREA

A) PER SECTION 871(1)B OF THE BUSINESS AND PROFESSIONAL CODE, A PERSON AUTHORIZED TO PRACTICE LAND SURVEYING SHALL BE RESPONSIBLE FOR THE MAINTENANCE OF A CORNER RECORD OF THE REFERENCE SHALL BE FILED PRIOR TO CONSTRUCTION.

PER SECTION 871(1)C OF THE BUSINESS AND PROFESSIONAL CODE, ANY SURVEY MONUMENT THAT IS DESTROYED, DAMAGED, COVERED OR OBLITERATED SHALL BE REPLACED BY A PERSON AUTHORIZED TO PRACTICE LAND SURVEYING AND A CORNER RECORD OF THE REPLACEMENT SHALL BE FILED PRIOR TO A CERTIFICATE OF COMPLETION OF THE PROJECT IS ISSUED.



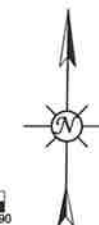

SEE ABOVE RIGHT  
MATCH LINE - STA 17+00

SEE SHEET 5  
MATCH LINE - ROOD RD STA 10+50



The logo for Dynamic Consulting Engineers is enclosed in a rectangular border. The word "Dynamic" is written in a large, blue, sans-serif font. To its right, the words "CONSULTING ENGINEERS" are written in a smaller, black, sans-serif font, arranged in two lines. Below this, the company's services are listed: "CIVIL ENGINEERING - LAND SURVEYING - CONSTRUCTION MANAGEMENT". The address "2415 IMPERIAL BUSINESS PARK DRIVE, SUITE B., IMPERIAL, CA. 92251" is printed in a smaller font. At the bottom, the telephone number "TEL. (760) 545-0162" is on the left and the fax number "FAX (760) 545-0183" is on the right.

REV.	DATE	REVISION DESCRIPTION		PREPARED UNDER THE DIRECT SUPERVISION OF:		COUNTY OF IMPERIAL PUBLIC WORKS DEPARTMENT APPROVED FOR CONSTRUCTION BY:	 PUBLIC WORKS DEPARTMENT <b>COUNTY OF IMPERIAL</b> EL CENTRO, CALIFORNIA	DATE	5/14/2025	<b>ROAD REHABILITATION PROJECT FOR VARIOUS COUNTY ROADS AT GATEWAY OF THE AMERICAS</b>  <b>COUNTY PROJECT NO. 6622GTW</b>	<b>PAN AMERICAN ROAD</b>	
				69121		62028		DB, PM	REFERENCE		<b>R-999</b>	<b>PAGE 4 OF 21</b>
				CARLOS BELTRAN, P.E.		JOHN A. GAY, P.E.		AS SHOWN				
				DATE		DATE		CB				



SEE MIDDLE RIGHT  
MATCH LINE - STA 25+50

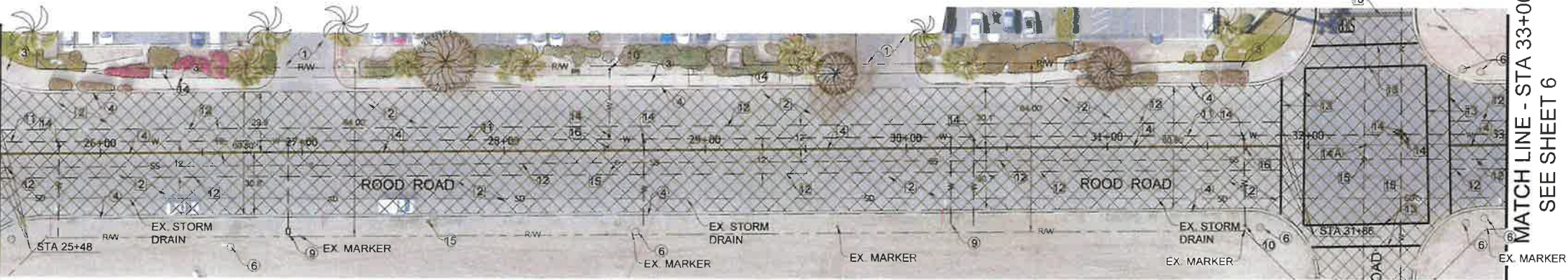

ROAD ROAD STA 10+50 TO STA 33+00	
REFERENCE <b>R-999</b>	PAGE 5 OF 21



MATCH LINE - STA 33+00 SEE SHEET 6

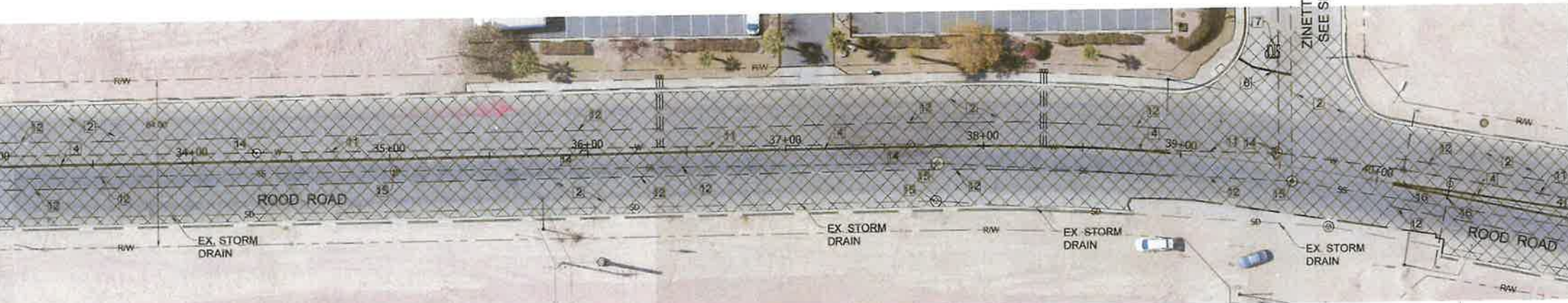

MATCH LINE - STA 41+00  
SEE BOTTOM LEFT

SEE TOP RIGHT  
MATCH LINE - STA 41+00

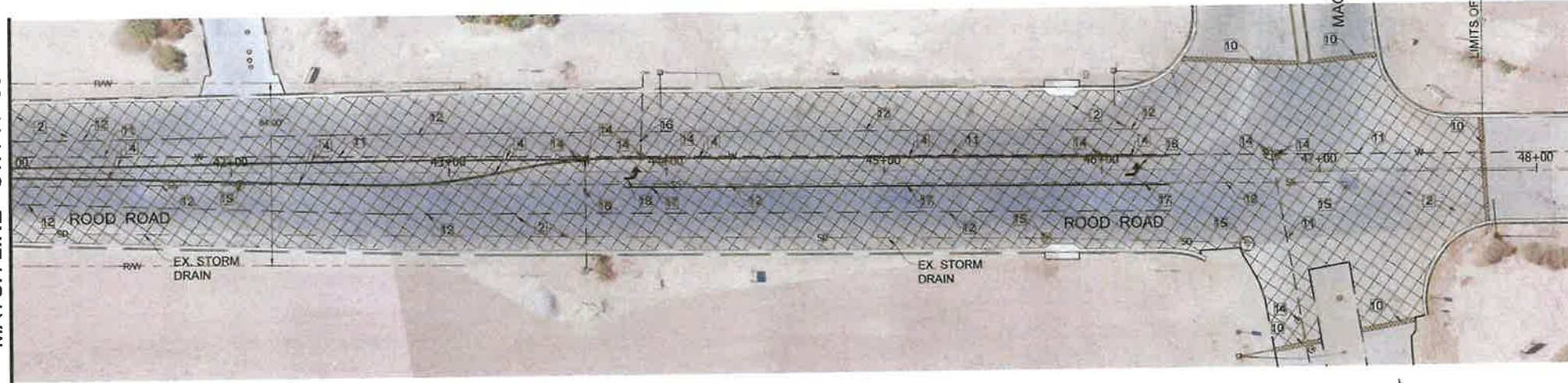

## LEGEND

TYPE II SLURRY SEAL

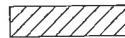

2" GRIND AND AC OVERLAY



DIG OUT AREA. NEW AC AND  
CLASS II BASE



### SURVEY MONUMENTS WITHIN SLURRY AREA

A PER SECTION 8771(b) OF THE BUSINESS AND PROFESSIONAL CODE, A PERSON AUTHORIZED TO PRACTICE LAND SURVEYING SHALL REFERENCE SURVEY MONUMENTS AND A CORNER RECORD OF THE REFERENCE SHALL BE FILED PRIOR TO CONSTRUCTION.

PER SECTION 8771(c) OF THE BUSINESS AND PROFESSIONAL CODE, ANY SURVEY MONUMENT THAT IS DESTROYED, DAMAGED, COVERED OR OBLITERATED SHALL BE REPLACED BY A PERSON AUTHORIZED TO PRACTICE LAND SURVEYING AND A CORNER RECORD OF THE MONUMENT SHALL BE FILED PRIOR TO A CERTIFICATE OF COMPLETION OF THE PROJECT IS ISSUED.

### CONSTRUCTION NOTES

SLURRY SEAL SHALL NOT BE APPLIED OVER ANY MANHOLE, VALVE, SURVEY MONUMENT, OR MISCELLANEOUS FRAMES AND COVERS. ANY MATERIAL USED TO PROTECT SUCH DEVICES SHALL BE REMOVED AND DISPOSED OF LAWFULLY BY THE CONTRACTOR.

WORK SHALL BE COMPLETED IN TWO PARTS (HALF STREET EACH PART) TO ALLOW FOR INGRESS TO TRAFFIC.

ALL ROADS WHERE SLURRY SEAL WILL BE APPLIED SHALL BE PROPERLY SWEEPED AND BE FREE FROM DUST, MOISTURE, DEBRIS AND LOOSE PARTICLES PRIOR TO SLURRY SEAL PLACEMENT.

ALL ROADS WHERE SLURRY SEAL IS APPLIED SHALL BE FULLY SWEEPED 5 TO 8 DAYS AFTER SLURRY SEAL IS COMPLETE, WITH RESIDUAL MATERIAL REMOVED AND DISPOSED TO A LEGAL DISPOSAL SITE.

PRIOR TO APPLYING CRACK SEALANT, THE PAVEMENT SURFACE SHALL BE DRY. CRACKS AND JOINTS SHALL BE CLEANED USING APPROPRIATE ROUTING, BRUSHING OR BLOWING OPERATIONS TO PROVIDE SUFFICIENT CONTACT BONDING SURFACES. CRACKS SHALL BE FREE FROM DUST, MOISTURE, DEBRIS, LOOSE PARTICLES AND OTHER CONTAMINANTS.

- ② EXISTING WATER VALVE TO REMAIN
- ③ EXISTING SIDEWALK TO REMAIN
- ④ EXISTING CURB AND GUTTER TO REMAIN
- ⑤ EXISTING POWER/TELEPHONE OR LIGHT POLE TO REMAIN
- ⑥ EXISTING SIGN TO REMAIN
- ⑦ EXISTING CATCH BASIN TO REMAIN
- ⑧ EXISTING STORM DRAIN PIPE/MAHOLE TO REMAIN
- ⑨ EXISTING WATER METER TO REMAIN
- ⑩ EXISTING WATER FIRE HYDRANT TO REMAIN
- ⑪ EXISTING WATER LINE TO REMAIN
- ⑫ EXISTING SEWER LINE/MAHOLE TO REMAIN
- ⑬ EXISTING UTILITY MANHOLE TO REMAIN
- ⑭ EXISTING ELECTRICAL METER TO REMAIN
- ⑮ EXISTING UTILITY BOX/METER TO REMAIN
- ⑯ EXISTING AC DIKE TO REMAIN
- ⑰ EXISTING STRIPING OR MARKING TO REMAIN

### CONSTRUCTION KEYNOTES

- 1) INSTALL TYPE II SLURRY SEAL. PRIOR TO INSTALLATION OF SLURRY SEAL PROVIDE CRACK SEALANT. SEE CONSTRUCTION NOTES.
- 2) COLD PLANE EXISTING A.C. PAVEMENT FOR A THICKNESS OF 2 INCHES. REMOVE AND DISPOSE OF EXISTING A.C. PAVEMENT MATERIAL. AFTER THE COLD PLANING PROCESS HAS BEEN COMPLETED, CLEAN AND SWEEP ROADWAY. ALL CRACKS SHALL BE CLEANED FROM DEBRIS. AFTER SWEEPING ACTIVITIES HAVE BEEN COMPLETED CRACK SEAL THE EXISTING A.C. PAVEMENT. AFTER CRACK SEALANT AND STREET CLEANING HAS BEEN COMPLETED, INSTALL 2 INCHES OF TYPE A 1 1/2" ASPHALT CONCRETE MIX.
- 3) INSTALL DOUBLE YELLOW NO PASSING LINE PER CALTRANS STANDARD PLAN A20A DETAIL 21.
- 4) INSTALL DOUBLE YELLOW NO PASSING LINE PER CALTRANS STANDARD PLAN A20A DETAIL 22.
- 5) INSTALL WHITE RIGHT EDGE LINE PER CALTRANS STANDARD PLAN A20B DETAIL 27B.
- 6) INSTALL 12 INCH WHITE LIMIT LINE PER CALTRANS STANDARD PLAN A24E.
- 7) INSTALL "STOP" PAVEMENT LEGEND PER CALTRANS STANDARD PLAN A24D.
- 8) PROTECT IN PLACE. CONTRACTOR TO PROTECT MANHOLES, VALVES, SURVEY MONUMENTS AND MISCELLANEOUS FRAMES AND COVERS.
- 9) INSTALL YELLOW CENTER LINE PER CALTRANS STANDARD PLAN A20A DETAIL 1.
- 10) COLD PLANE EXISTING A.C. PAVEMENT FOR A THICKNESS OF 0.20 FOOT PER CONSTRUCTION PAVEMENT EXTENSION JOINT PER DETAIL C ON SHEET 21. REMOVE AND DISPOSE OF EXISTING A.C. PAVEMENT MATERIAL.
- 11) REMOVE EXISTING AC PAVEMENT FAILURE AREA AND UNDERLYING BASE MATERIAL AND REPLACE WITH NEW AC PAVEMENT OVER CLASS II BASE PER DETAIL D (DIG OUT DETAIL) ON SHEET 21.
- 12) INSTALL WHITE LANELINE PER CALTRANS STANDARD PLAN A20A DETAIL 6.
- 13) INSTALL 12 INCH WHITE CROSSWALK PER CA VEHICLE CODE 21368.
- 14) CONTRACTOR TO LOWER THE WATER VALVE RISER FRAME AND COVER TO 0.30 FEET BELOW GRADE PRIOR TO PAVING ACTIVITIES. THE CONTRACTOR SHALL ADJUST THE EXISTING WATER VALVE RISER TO FINISH GRADE AFTER PAVING OPERATIONS ARE COMPLETE. CONTRACTOR TO PLACE AN 12-INCH DEEP BY 12-INCH WIDE 4,500 PSI CONCRETE RING AROUND THE EXTERIOR CIRCUMFERENCE OF THE VALVE RISER. SEE DETAIL B SHEET 21.
- 15) CONTRACTOR TO LOWER EXISTING SANITARY SEWER/STORM DRAIN MANHOLE FRAME AND COVER TO 0.30 FEET BELOW GRADE PRIOR TO PAVING ACTIVITIES. THE CONTRACTOR SHALL ADJUST THE EXISTING SANITARY SEWER MANHOLE TO FINISH GRADE AFTER PAVING OPERATIONS ARE COMPLETE. CONTRACTOR TO PLACE AN 12-INCH DEEP BY 12-INCH WIDE 4,500 PSI CONCRETE RING AROUND THE EXTERIOR CIRCUMFERENCE OF THE MANHOLE PER DETAIL A ON SHEET 21.
- 16) INSTALL FIRE HYDRANT BLUE MARKER
- 17) INSTALL 8" CHANNELIZING LINE PER CALTRANS STANDARD PLAN A20D DETAIL 38.
- 18) INSTALL TRAFFIC ARROW PER PAVEMENT MARKINGS LEGEND THIS SHEET.
- 19) INSTALL "AHEAD" OR "SIGNAL" PAVEMENT LEGEND PER CALTRANS STANDARD PLAN A24D.

REV.	DATE	REVISION DESCRIPTION



PREPARED UNDER THE DIRECT SUPERVISION OF:

CARLOS BELTRAN, P.E.  
6/2/25  
DATE

89121  
R.C.E. No.  
06/30/2026  
REG. EXP.



COUNTY OF IMPERIAL PUBLIC WORKS DEPARTMENT  
APPROVED FOR CONSTRUCTION BY:

John A. Gay, P.E.  
6/2/25  
DATE

62028  
R.C.E. No.  
09/30/2025  
REG. EXP.



DATE 5/14/2025  
DRAWN DB, FM  
SCALE AS SHOWN  
CHECKED CB

ROAD REHABILITATION PROJECT FOR  
VARIOUS COUNTY ROADS  
AT GATEWAY OF THE AMERICAS  
COUNTY PROJECT NO. 6622GTW

**Dynamic** CONSULTING ENGINEERS

CIVIL ENGINEERING - LAND SURVEYING - CONSTRUCTION MANAGEMENT  
2415 IMPERIAL BUSINESS PARK DRIVE, SUITE B,  
IMPERIAL, CA. 92251

TEL (760) 545-0162 FAX (760) 545-0163

ROAD ROAD  
STA 33+00 TO STA 47+75

REFERENCE  
R-999

PAGE  
6 OF 21



LEGEND

- TYPE II SLURRY SEAL
- 2" GRIND AND AC OVERLAY
- DIG OUT AREA, NEW AC AND CLASS II BASE

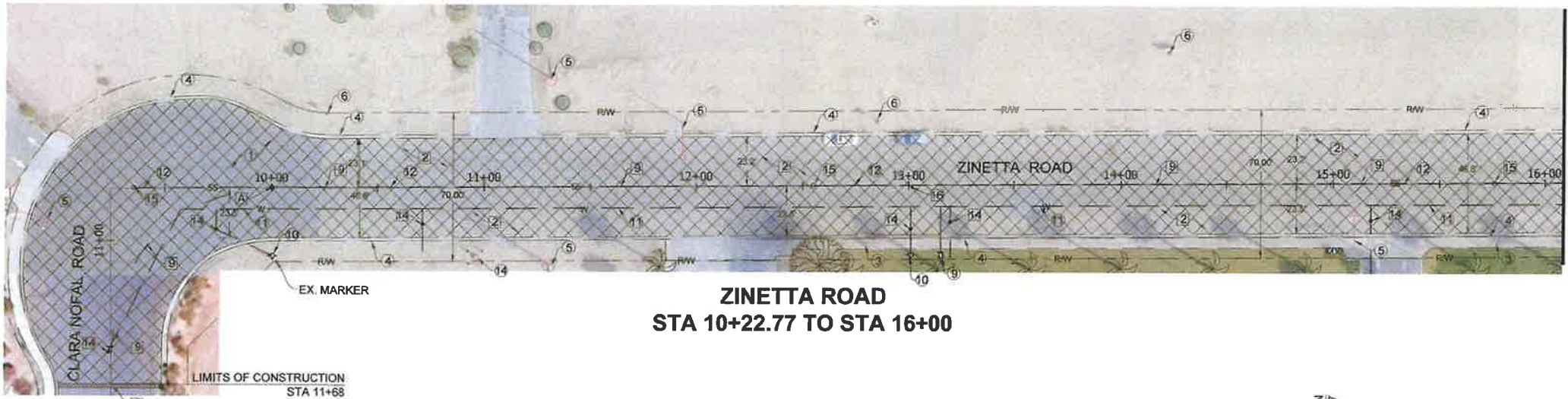

MATCH LINE - STA 16+00  
SEE BOTTOM LEFT

SEE ABOVE RIGHT  
MATCH LINE - STA 16+00

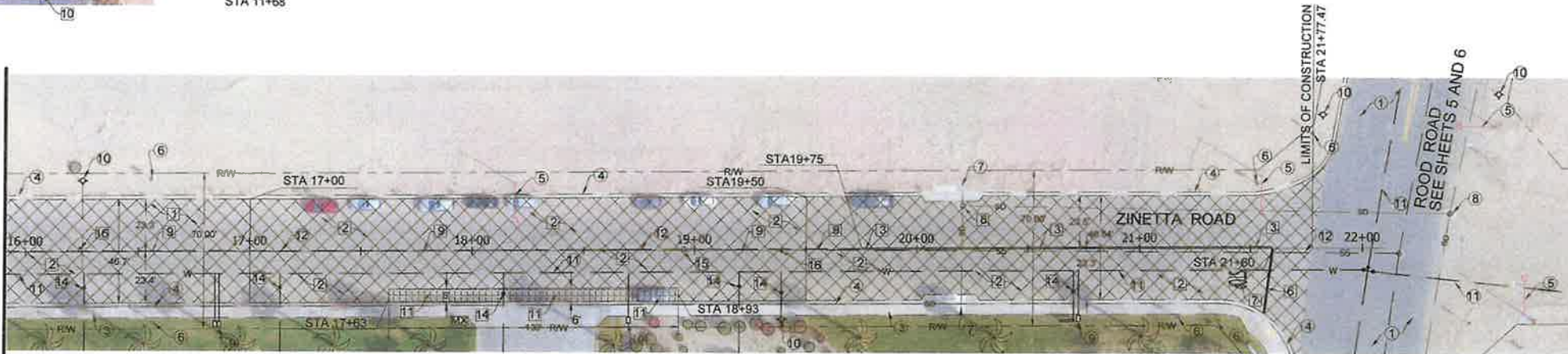

SURVEY MONUMENTS WITHIN SLURRY AREA

PER SECTION 8771(b) OF THE BUSINESS AND PROFESSIONAL CODE, A PERSON AUTHORIZED TO PRACTICE LAND SURVEYING SHALL REFERENCE SURVEY MONUMENTS AND A CORNER RECORD OF THE REFERENCE SHALL BE FILED PRIOR TO CONSTRUCTION.

PER SECTION 8771(c) OF THE BUSINESS AND PROFESSIONAL CODE, ANY SURVEY MONUMENT THAT IS DESTROYED, DAMAGED, COVERED OR OBLITERATED SHALL BE REPLACED BY A PERSON AUTHORIZED TO PRACTICE LAND SURVEYING AND A CORNER RECORD OF THE MONUMENT SHALL BE FILED PRIOR TO A CERTIFICATE OF COMPLETION OF THE PROJECT IS ISSUED.



- 2 EXISTING WATER VALVE TO REMAIN
- 3 EXISTING SIDEWALK TO REMAIN
- 4 EXISTING CURB AND GUTTER TO REMAIN
- 5 EXISTING POWER/TELEPHONE OR LIGHT POLE TO REMAIN
- 6 EXISTING SIGN TO REMAIN
- 7 EXISTING CATCH BASIN TO REMAIN
- 8 EXISTING STORM DRAIN PIPE/MANHOLE TO REMAIN
- 9 EXISTING WATER METER TO REMAIN
- 10 EXISTING WATER FIRE HYDRANT TO REMAIN
- 11 EXISTING WATER LINE TO REMAIN
- 12 EXISTING SEWER LINE/MANHOLE TO REMAIN
- 13 EXISTING UTILITY MANHOLE TO REMAIN
- 14 EXISTING ELECTRICAL METER TO REMAIN
- 15 EXISTING UTILITY BOX/METER TO REMAIN
- 16 EXISTING AC DIKE TO REMAIN
- 17 EXISTING STRIPING OR MARKING TO REMAIN
- CONSTRUCTION KEYNOTES
- 1 INSTALL TYPE II SLURRY SEAL. PRIOR TO INSTALLATION OF SLURRY SEAL PROVIDE CRACK SEALANT. SEE CONSTRUCTION NOTES.
- 2 COLD PLANE EXISTING A.C. PAVEMENT FOR A THICKNESS OF 2-INCHES. REMOVE AND DISPOSE OF EXISTING A.C. PAVEMENT MATERIAL. AFTER THE COLD PLANING PROCESS HAS BEEN COMPLETED, CLEAN AND SWEEP ROADWAY. ALL CRACKS SHALL BE CLEANED FROM DEBRIS. AFTER SWEEPING ACTIVITIES HAVE BEEN COMPLETED CRACK SEAL THE EXISTING A.C. PAVEMENT. AFTER CRACK SEALANT AND STREET CLEANING HAS BEEN COMPLETED, INSTALL 2 INCHES OF TYPE A 3/4" ASPHALT CONCRETE MIX.
- 3 INSTALL DOUBLE YELLOW NO PASSING LINE PER CALTRANS STANDARD PLAN A20A DETAIL 21.
- 4 INSTALL DOUBLE YELLOW NO PASSING LINE PER CALTRANS STANDARD PLAN A20A DETAIL 22.
- 5 INSTALL WHITE RIGHT EDGE LINE PER CALTRANS STANDARD PLAN A20B DETAIL 27B.
- 6 INSTALL 12 INCH WHITE LIMIT LINE PER CALTRANS STANDARD PLAN A24E.
- 7 INSTALL "STOP" PAVEMENT LEGEND PER CALTRANS STANDARD PLAN A24D.
- 8 PROTECT IN PLACE. CONTRACTOR TO PROTECT MANHOLES, VALVES, SURVEY MONUMENTS AND MISCELLANEOUS FRAMES AND COVERS.
- 9 INSTALL YELLOW CENTER LINE PER CALTRANS STANDARD PLAN A20A DETAIL 1.
- 10 COLD PLANE EXISTING A.C. PAVEMENT FOR A THICKNESS OF 0.30 FEET PER CONSTRUCTION PAVEMENT EXTENSION JOINT PER DETAIL C ON SHEET 21. REMOVE AND DISPOSE OF EXISTING A.C. PAVEMENT MATERIAL.
- 11 REMOVE EXISTING AC PAVEMENT FAILURE AREA AND UNDERLYING BASE MATERIAL AND REPLACE WITH NEW AC PAVEMENT OVER CLASS II BASE PER DETAIL D (DIG OUT DETAIL) ON SHEET 21.
- 12 INSTALL WHITE LANELINE PER CALTRANS STANDARD PLAN A20A DETAIL 8.
- 13 INSTALL 12 INCH WHITE CROSSWALK PER CA VEHICLE CODE 21308.
- 14 CONTRACTOR TO LOWER THE WATER VALVE RISER FRAME AND COVER TO 0.30 FEET BELOW GRADE PRIOR TO PAVING ACTIVITIES. THE CONTRACTOR SHALL ADJUST THE EXISTING WATER VALVE RISER TO FINISH GRADE AFTER PAVING OPERATIONS ARE COMPLETE. CONTRACTOR TO PLACE AN 12-INCH DEEP BY 12-INCH WIDE 4,500 PSI CONCRETE RING AROUND THE EXTERIOR CIRCUMFERENCE OF THE VALVE RISER. SEE DETAIL B SHEET 21.
- 15 CONTRACTOR TO LOWER EXISTING SANITARY SEWER/STORM DRAIN MANHOLE FRAME AND COVER TO 0.30 FEET BELOW GRADE PRIOR TO PAVING ACTIVITIES. THE CONTRACTOR SHALL ADJUST THE EXISTING SANITARY SEWER MANHOLE TO FINISH GRADE AFTER PAVING OPERATIONS ARE COMPLETE. CONTRACTOR TO PLACE AN 12-INCH DEEP BY 12-INCH WIDE 4,500 PSI CONCRETE RING AROUND THE EXTERIOR CIRCUMFERENCE OF THE MANHOLE PER DETAIL A ON SHEET 21.
- 16 INSTALL FIRE HYDRANT BLUE MARKER

CONSTRUCTION NOTES:

SLURRY SEAL SHALL NOT BE APPLIED OVER ANY MANHOLE, VALVE, SURVEY MONUMENT, OR MISCELLANEOUS FRAMES AND COVERS. ANY MATERIAL USED TO PROTECT SUCH DEVICES SHALL BE REMOVED AND DISPOSED OF LAWFULLY BY THE CONTRACTOR.

WORK SHALL BE COMPLETED IN TWO PARTS (HALF STREET EACH PART) TO ALLOW FOR INGRESS TO TRAFFIC.

ALL ROADS WHERE SLURRY SEAL WILL BE APPLIED SHALL BE PROPERLY SWEEPED AND BE FREE FROM DUST, MOISTURE, DEBRIS AND LOOSE PARTICLES PRIOR TO SLURRY SEAL PLACEMENT.

ALL ROADS WHERE SLURRY SEAL IS APPLIED SHALL BE FULLY SWEEPED 5 TO 8 DAYS AFTER SLURRY IS COMPLETE, WITH RESIDUAL MATERIAL REMOVED AND DISPOSED TO A LEGAL DISPOSAL SITE.

PRIOR TO APPLYING CRACK SEALANT, THE PAVEMENT SURFACE SHALL BE DRY. CRACKS AND JOINTS SHALL BE CLEANED USING APPROPRIATE ROUTING, BRUSHING OR BLOWING OPERATIONS TO PROVIDE SUFFICIENT CONTACT BONDING SURFACES. CRACKS SHALL BE FREE FROM DUST, MOISTURE, DEBRIS, LOOSE PARTICLES AND OTHER CONTAMINANTS.

**Dynamic** CONSULTING ENGINEERS

CIVIL ENGINEERING - LAND SURVEYING - CONSTRUCTION MANAGEMENT  
2415 IMPERIAL BUSINESS PARK DRIVE, SUITE B.,  
IMPERIAL, CA 92251

TEL (760) 545-0182 FAX (760) 545-0183

REV.	DATE	REVISION DESCRIPTION



PREPARED UNDER THE DIRECT SUPERVISION OF:

CARLOS BELTRAN, P.E.

69121 R.C.E. No.

06/30/2026 REG. EXP.



COUNTY OF IMPERIAL PUBLIC WORKS DEPARTMENT  
APPROVED FOR CONSTRUCTION BY:

JOHN A. GAY, P.E.

6/2/25 DATE

62028 R.C.E. No.

09/30/2025 REG. EXP.



DATE 5/14/2025  
DRAWN DB, FM  
SCALE AS SHOWN  
CHECKED CB

ROAD REHABILITATION PROJECT FOR  
VARIOUS COUNTY ROADS  
AT GATEWAY OF THE AMERICAS  
COUNTY PROJECT NO. 6622GTW

ZINETTA ROAD	
REFERENCE	PAGE
R-999	7 OF 21



TYPE II SLURRY SEAL

2" GRIND AND AC OVERLAY

INSTALL TYPE I 24' ARROWS PER CALTRANS STANDARD PLAN A24A

INSTALL TYPE III (L) ARROW PER CALTRANS STANDARD PLAN A24B

INSTALL TYPE III (R) ARROW PER CALTRANS STANDARD PLAN A24B

INSTALL TYPE II (R) ARROW PER CALTRANS STANDARD PLAN A24B

STRIPING TO BE THERMOPLASTIC

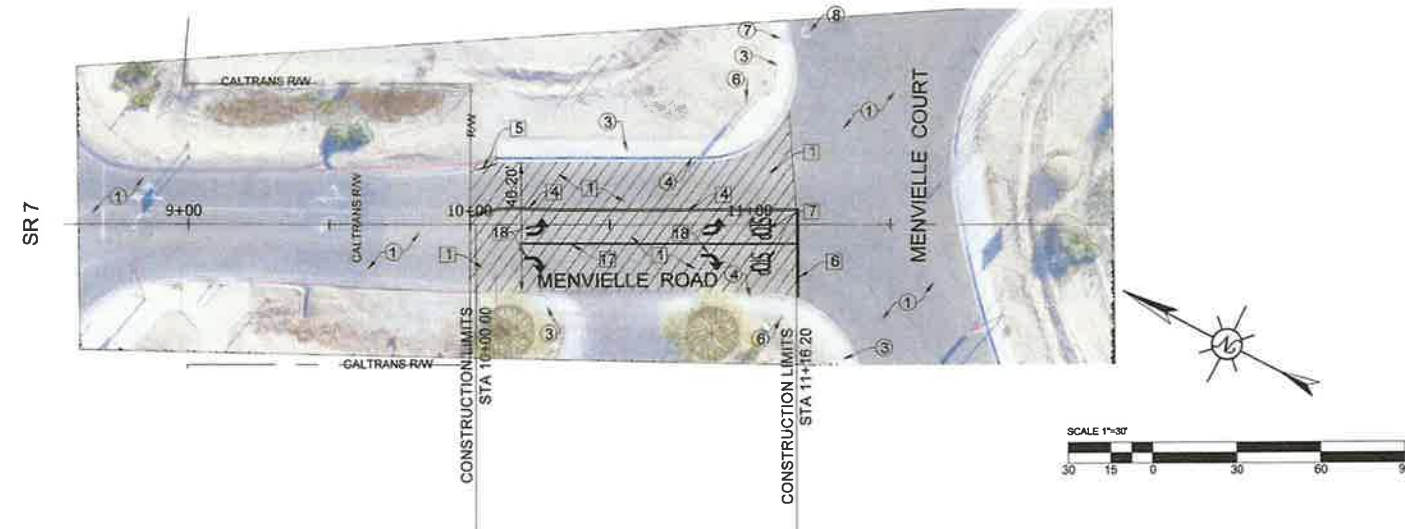

**MENVIELLE ROAD IMPROVEMENTS TO BE COMPLETED IN TWO PHASES.**

- TYPE II SLURRY SEAL NORTH SIDE OF MENVIELE ROAD.

- VEHICULAR ACCESS TO BE ON THE SOUTH SIDE OF MENVIELLE ROAD.

- TYPE II SLURRY SEAL SOUTH SIDE OF MENVIELLE ROAD.

- VEHICULAR ACCESS TO BE ON THE NORTH SIDE OF MENVILLE ROAD. ACCESS TO EXISTING BUSINESSES ALONG MENVILLE ROAD SHALL BE FROM MENVILLE COURT DURING PHASE 2 CONSTRUCTION.

SLURRY SEAL SHALL NOT BE APPLIED OVER ANY MANHOLE, VALVE, SURVEY MONUMENT, OR MISCELLANEOUS FRAMES AND COVERS. ANY MATERIAL USED TO PROTECT SUCH DEVICES SHALL BE REMOVED AND DISPOSED OF LAWFULLY BY THE CONTRACTOR.

WORK SHALL BE COMPLETED IN TWO PARTS (HALF STREET EACH PART) TO ALLOW FOR INGRESS TO TRAFFIC.

ALL ROADS WHERE SLURRY SEAL WILL BE APPLIED SHALL BE PROPERLY SWEEPED AND BE FREE FROM DUST, MOISTURE, DEBRIS AND LOOSE PARTICLES PRIOR TO SLURRY SEAL PLACEMENT.

ALL ROADS WHERE SLURRY SEAL IS APPLIED SHALL BE FULLY SWEEPED 5 TO 8 DAYS AFTER SLURRY IS COMPLETE. WITH RESIDUAL MATERIAL REMOVED AND DISPOSED TO A LEGAL DISPOSAL SITE.

PRIOR TO APPLYING CRACK SEALANT, THE PAVEMENT SURFACE SHALL BE DRY. CRACKS AND JOINTS SHALL BE CLEANED USING APPROPRIATE ROUTING, BRUSHING OR BLOWING OPERATIONS TO PROVIDE SUFFICIENT CONTACT BONDING SURFACES. CRACKS SHALL BE FREE FROM DUST, MOISTURE, DEBRIS, LOOSE PARTICLES AND OTHER CONTAMINANTS.

**A** PER SECTION 8771(b) OF THE BUSINESS AND PROFESSIONAL CODE, A PERSON AUTHORIZED TO PRACTICE LAND SURVEYING SHALL REFERENCE SURVEY MONUMENTS AND A CORNER RECORD OF THE REFERENCE SHALL BE FILED PRIOR TO CONSTRUCTION.

PER SECTION 8771(c) OF THE BUSINESS AND PROFESSIONAL CODE,  
ANY SURVEY MONUMENT THAT IS DESTROYED, DAMAGED, COVERED  
OR OBLITERATED SHALL BE REPLACED BY A PERSON AUTHORIZED TO  
PRACTICE LAND SURVEYING AND A CORNER RECORD OF THE  
MONUMENT SHALL BE FILED PRIOR TO A CERTIFICATE OF  
COMPLETION OF THE PROJECT IS ISSUED.

**Dynamic** CONSULTING  
ENGINEERS  
CIVIL ENGINEERING - LAND SURVEYING - CONSTRUCTION MANAGEMENT  
2415 IMPERIAL BUSINESS PARK DRIVE, SUITE B.,  
IMPERIAL CA. 92251  
TEL (760) 545-0162 FAX (760) 545-0163

REV.	DATE	REVISION DESCRIPTION

CARLOS BELTRAN  
No. 60121  
EXP. 6-30-06  
CIVIL  
STATE OF CALIFORNIA

PREPARED UNDER THE DIRECT SUPERVISION OF:

[Signature]                      60121  
CARLOS BELTRAN, P.E.       R.C.E. No.

6/6/05                          06/30/2026  
DATE                             REG. EXP.

PUBLIC WORKS DEPARTMENT  
COUNTY OF IMPERIAL  
EL CENTRO, CALIFORNIA

COUNTY OF IMPERIAL PUBLIC WORKS DEPARTMENT  
APPROVED FOR CONSTRUCTION BY:

[Signature]                      62028  
JOHN A. GAY, P.E.       R.C.E. No.

6/2/05                          09/30/2025  
DATE                             REG. EXP.

PUBLIC WORKS DEPARTMENT  
COUNTY OF IMPERIAL  
EL CENTRO, CALIFORNIA

DATE	5/14/2025
DRAWN	DB, FM
SHEET NO.	AS SHOWN
CHECKED	CB

## ROAD REHABILITATION PROJECT FOR VARIOUS COUNTY ROADS AT GATEWAY OF THE AMERICAS

### COUNTY PROJECT NO. 6622GTW

MENVILLE ROAD	
REFERENCE <b>R-999</b>	PAGE 8 OF 21



LEGEND

- TYPE II SLURRY SEAL
- 2" GRIND AND AC OVERLAY

PAVEMENT MARKINGS LEGEND:

- INSTALL TYPE I 24" ARROWS PER CALTRANS STANDARD PLAN A24A
- INSTALL TYPE III (L) ARROW PER CALTRANS STANDARD PLAN A24B
- INSTALL TYPE III (R) ARROW PER CALTRANS STANDARD PLAN A24B
- INSTALL TYPE II (R) ARROW PER CALTRANS STANDARD PLAN A24B
- STRIPING TO BE THERMOPLASTIC

NINA LEE ROAD IMPROVEMENTS TO BE COMPLETED IN THREE PHASES.

PHASE 1 CONSTRUCTION:

- 2 INCH COLD PLANE THE NORTH-EAST HALF OF NINA ROAD.
- VEHICULAR ACCESS TO BE ON THE SOUTH-WEST SIDE OF NINA ROAD ROAD.

PHASE 2 CONSTRUCTION:

- 2 INCH COLD PLANE THE SOUTH-WEST HALF OF NINA ROAD. CRACK SEAL AND PLACE NEW ASPHALT CONCRETE PAVEMENT.

PHASE 3 CONSTRUCTION:

- CRACK SEAL AND PLACE NEW ASPHALT CONCRETE PAVEMENT ON THE NORTH-EAST HALF OF NINA ROAD.
- VEHICULAR ACCESS TO BE ON THE SOUTH-WEST SIDE OF NINA ROAD ROAD.

EXISTING KEYNOTES:

- EXISTING A.C. PAVEMENT TO REMAIN
- EXISTING WATER VALVE TO REMAIN
- EXISTING SIDEWALK TO REMAIN
- EXISTING CURB AND GUTTER TO REMAIN
- EXISTING POWER/TELEPHONE OR LIGHT POLE TO REMAIN
- EXISTING SIGN TO REMAIN
- EXISTING CATCH BASIN TO REMAIN
- EXISTING STORM DRAIN PIPE/MANHOLE TO REMAIN
- EXISTING WATER METER TO REMAIN
- EXISTING WATER FIRE HYDRANT TO REMAIN
- EXISTING WATER LINE TO REMAIN
- EXISTING SEWER LINE/MANHOLE TO REMAIN
- EXISTING UTILITY MANHOLE TO REMAIN
- EXISTING ELECTRICAL METER TO REMAIN
- EXISTING UTILITY BOX/METER TO REMAIN
- EXISTING AC DIKE TO REMAIN
- EXISTING STRIPING OR MARKING TO REMAIN

CONSTRUCTION KEYNOTES

- INSTALL TYPE II SLURRY SEAL. PRIOR TO INSTALLATION OF SLURRY SEAL PROVIDE CRACK SEALANT. SEE CONSTRUCTION NOTES.
- COLD PLANE EXISTING A.C. PAVEMENT FOR A THICKNESS OF 2 INCHES. REMOVE AND DISPOSE OF EXISTING A.C. PAVEMENT MATERIAL. AFTER THE COLD PLANING PROCESS HAS BEEN COMPLETED, CLEAN AND SWEEP ROADWAY. ALL CRACKS SHALL BE CLEANED FROM DEBRIS. AFTER SWEEPING ACTIVITIES HAVE BEEN COMPLETED CRACK SEAL THE EXISTING A.C. PAVEMENT. AFTER CRACK SEALANT AND STREET CLEANING HAS BEEN COMPLETED, INSTALL 2 INCHES OF TYPE A 1/2" ASPHALT CONCRETE MIX.
- INSTALL DOUBLE YELLOW NO PASSING LINE PER CALTRANS STANDARD PLAN A20A DETAIL 22.
- INSTALL WHITE RIGHT EDGELINE PER CALTRANS STANDARD PLAN A20B DETAIL 27B.
- INSTALL 12 INCH WHITE LIMIT LINE PER CALTRANS STANDARD PLAN A24E.
- INSTALL "STOP" PAVEMENT LEGEND PER CALTRANS STANDARD PLAN A24D.
- PROTECT IN PLACE. CONTRACTOR TO PROTECT MANHOLES, VALVES, SURVEY MONUMENTS AND MISCELLANEOUS FRAMES AND COVERS.
- INSTALL YELLOW CENTER LINE PER CALTRANS STANDARD PLAN A20A DETAIL 1.
- COLD PLANE EXISTING A.C. PAVEMENT FOR A THICKNESS OF 0.20-FOOT PER CONSTRUCTION PAVEMENT EXTENSION JOINT PER DETAIL C ON SHEET 21. REMOVE AND DISPOSE OF EXISTING A.C. PAVEMENT MATERIAL.
- INSTALL 8" CHANNELIZING LINE PER CALTRANS STANDARD PLAN A20D DETAIL 38.
- INSTALL TRAFFIC ARROW PER PAVEMENT MARKINGS LEGEND THIS SHEET.
- INSTALL "AHEAD" OR "SIGNAL" PAVEMENT LEGEND PER CALTRANS STANDARD PLAN A24D.

CONSTRUCTION NOTES:

SLURRY SEAL SHALL NOT BE APPLIED OVER ANY MANHOLE, VALVE, SURVEY MONUMENT, OR MISCELLANEOUS FRAMES AND COVERS. ANY MATERIAL USED TO PROTECT SUCH DEVICES SHALL BE REMOVED AND DISPOSED OF LAWFULLY BY THE CONTRACTOR.

WORK SHALL BE COMPLETED IN TWO PARTS (HALF STREET EACH PART) TO ALLOW FOR INGRESS TO TRAFFIC

ALL ROADS WHERE SLURRY SEAL WILL BE APPLIED SHALL BE PROPERLY SWEEPED AND BE FREE FROM DUST, MOISTURE, DEBRIS AND LOOSE PARTICLES PRIOR TO SLURRY SEAL PLACEMENT.

ALL ROADS WHERE SLURRY SEAL IS APPLIED SHALL BE FULLY SWEEPED 5 TO 8 DAYS AFTER SLURRY IS COMPLETE, WITH RESIDUAL MATERIAL REMOVED AND DISPOSED TO A LEGAL DISPOSAL SITE.

PRIOR TO APPLYING CRACK SEALANT, THE PAVEMENT SURFACE SHALL BE DRY. CRACKS AND JOINTS SHALL BE CLEANED USING APPROPRIATE ROUTING, BRUSHING OR BLOWING OPERATIONS TO PROVIDE SUFFICIENT CONTACT BONDING SURFACES. CRACKS SHALL BE FREE FROM DUST, MOISTURE, DEBRIS, LOOSE PARTICLES AND OTHER CONTAMINANTS.

SURVEY MONUMENTS WITHIN SLURRY AREA

PER SECTION 8771(b) OF THE BUSINESS AND PROFESSIONAL CODE, A PERSON AUTHORIZED TO PRACTICE LAND SURVEYING SHALL REFERENCE SURVEY MONUMENTS AND A CORNER RECORD OF THE REFERENCE SHALL BE FILED PRIOR TO CONSTRUCTION.

PER SECTION 8771(c) OF THE BUSINESS AND PROFESSIONAL CODE, ANY SURVEY MONUMENT THAT IS DESTROYED, DAMAGED, COVERED OR OBLITERATED SHALL BE REPLACED BY A PERSON AUTHORIZED TO PRACTICE LAND SURVEYING AND A CORNER RECORD OF THE MONUMENT SHALL BE FILED PRIOR TO A CERTIFICATE OF COMPLETION OF THE PROJECT IS ISSUED.

**Dynamic** CONSULTING ENGINEERS

CIVIL ENGINEERING - LAND SURVEYING - CONSTRUCTION MANAGEMENT  
2415 IMPERIAL BUSINESS PARK DRIVE, SUITE B,  
IMPERIAL, CA. 92251

TEL (760) 545-0162

FAX (760) 545-0163

CARR ROAD  
STA 10+00  
STA 10+14.33  
BEGIN GRINDING OPERATIONS

NINA LEE ROAD  
STA 10+00 TO STA 19+00

REV.	DATE	REVISION DESCRIPTION



PREPARED UNDER THE DIRECT SUPERVISION OF:  
**CARLOS BELTRAN, P.E.**  
6/1/25  
DATE

69121  
R.C.E. No.  
06/30/2026  
REG. EXP.



COUNTY OF IMPERIAL PUBLIC WORKS DEPARTMENT  
APPROVED FOR CONSTRUCTION BY:  
**JOHN A. GAY, P.E.**  
6/2/25  
DATE

62028  
R.C.E. No.  
09/30/2026  
REG. EXP.

PUBLIC WORKS DEPARTMENT  
**COUNTY OF IMPERIAL**  
EL CENTRO, CALIFORNIA

DATE: 5/14/2025  
DRAWN: CB, FM  
SCALE: AS SHOWN  
CHECKED: CB

ROAD REHABILITATION PROJECT FOR  
VARIOUS COUNTY ROADS  
AT GATEWAY OF THE AMERICAS  
COUNTY PROJECT NO. 6622GTW

NINA LEE ROAD	
REFERENCE	PAGE
R-999	9 OF 21



LEGEND

- TYPE II SLURRY SEAL
- 2" GRIND AND AC OVERLAY

EXISTING KEYNOTES:

- 1 EXISTING A C PAVEMENT TO REMAIN
- 2 EXISTING WATER VALVE TO REMAIN
- 3 EXISTING SIDEWALK TO REMAIN
- 4 EXISTING CURB AND GUTTER TO REMAIN
- 5 EXISTING POWER/TELEPHONE OR LIGHT POLE TO REMAIN
- 6 EXISTING SIGN TO REMAIN
- 7 EXISTING CATCH BASIN TO REMAIN
- 8 EXISTING STORM DRAIN PIPE/MAHOLE TO REMAIN
- 9 EXISTING WATER METER TO REMAIN
- 10 EXISTING WATER FIRE HYDRANT TO REMAIN
- 11 EXISTING WATER LINE TO REMAIN
- 12 EXISTING SEWER LINE/MAHOLE TO REMAIN
- 13 EXISTING UTILITY MANHOLE TO REMAIN
- 14 EXISTING ELECTRICAL METER TO REMAIN
- 15 EXISTING UTILITY BOX/METER TO REMAIN
- 16 EXISTING AC DIKE TO REMAIN
- 17 EXISTING STRIPING OR MARKING TO REMAIN

CONSTRUCTION KEYNOTES

- 1 INSTALL TYPE II SLURRY SEAL PRIOR TO INSTALLATION OF SLURRY SEAL PROVIDE CRACK SEALANT. SEE CONSTRUCTION NOTES.
- 2 COLD PLANE EXISTING A C PAVEMENT FOR A THICKNESS OF 2-INCHES. REMOVE AND DISPOSE OF EXISTING A.C. PAVEMENT MATERIAL. AFTER THE COLD PLANING PROCESS HAS BEEN COMPLETED, CLEAN AND SWEEP ROADWAY. ALL CRACKS SHALL BE CLEANED FROM DEBRIS. AFTER SWEEPING ACTIVITIES HAVE BEEN COMPLETED CRACK SEAL THE EXISTING A C PAVEMENT. AFTER CRACK SEALANT AND STREET CLEANING HAS BEEN COMPLETED, INSTALL 2 INCHES OF TYPE A 3/4" ASPHALT CONCRETE MIX.
- 4 INSTALL DOUBLE YELLOW NO PASSING LINE PER CALTRANS STANDARD PLAN A20A DETAIL 22.
- 5 INSTALL WHITE RIGHT EDGE LINE PER CALTRANS STANDARD PLAN A20B DETAIL 27B.
- 6 INSTALL 12 INCH WHITE LIMIT LINE PER CALTRANS STANDARD PLAN A24E.
- 7 INSTALL "STOP" PAVEMENT LEGEND PER CALTRANS STANDARD PLAN A24D.
- 8 PROTECT IN PLACE. CONTRACTOR TO PROTECT MANHOLES, VALVES, SURVEY MONUMENTS AND MISCELLANEOUS FRAMES AND COVERS.
- 16 INSTALL FIRE HYDRANT BLUE MARKER
- 17 INSTALL 8" CHANNELIZING LINE PER CALTRANS STANDARD PLAN A20D DETAIL 38
- 18 INSTALL TRAFFIC ARROW PER PAVEMENT MARKINGS LEGEND THIS SHEET.
- 19 INSTALL "AHEAD" OR "SIGNAL" PAVEMENT LEGEND PER CALTRANS STANDARD PLAN A24D.

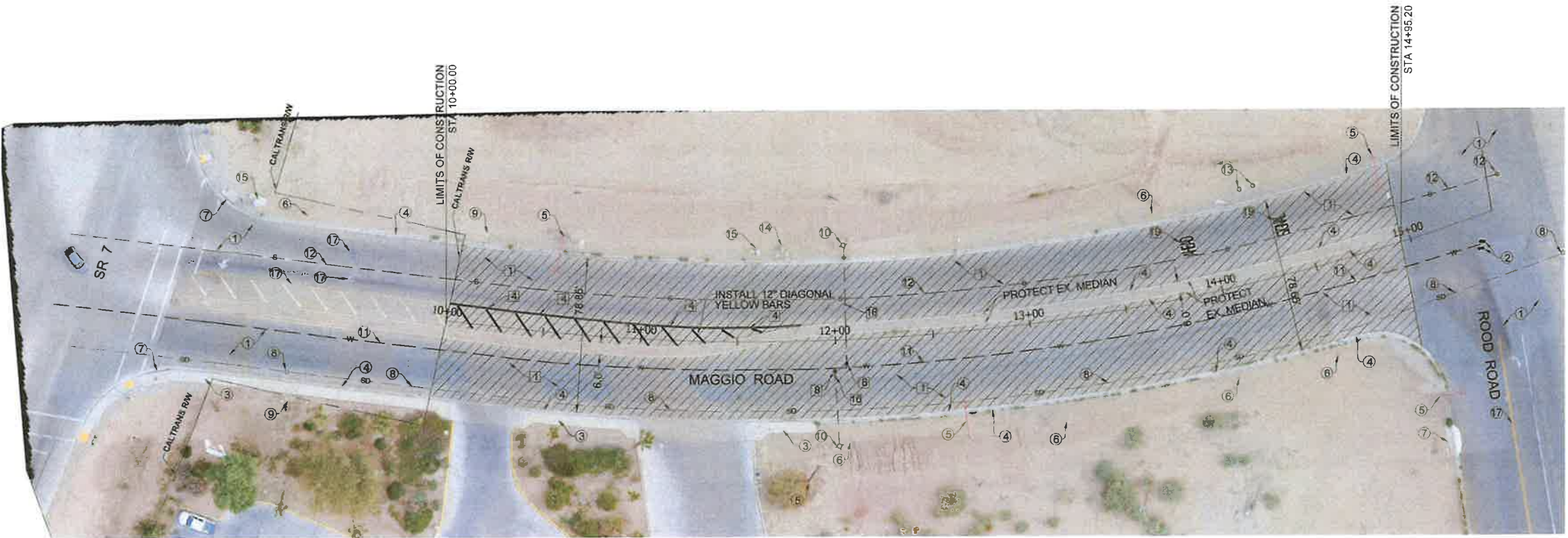

MAGGIO ROAD  
STA 10+00 TO STA 15+00

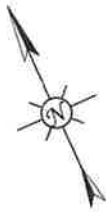

MAGGIO ROAD IMPROVEMENTS TO BE COMPLETED IN TWO PHASES.

PHASE 1 CONSTRUCTION:

- TYPE II SLURRY SEAL NORTH SIDE OF MAGGIO ROAD (NORTH OF EXISTING MEDIAN).
- VEHICULAR ACCESS TO BE ON THE SOUTH SIDE OF MAGGIO ROAD (SOUTH OF EXISTING MEDIAN).

PHASE 2 CONSTRUCTION:

- TYPE II SLURRY SEAL SOUTH SIDE OF MAGGIO ROAD (SOUTH OF EXISTING MEDIAN).
- VEHICULAR ACCESS TO BE ON THE NORTH SIDE OF MAGGIO ROAD (SOUTH OF EXISTING MEDIAN). ACCESS TO EXISTING BUSINESS ALONG MAGGIO ROAD SHALL BE FROM ROOD ROAD DURING PHASE 2 CONSTRUCTION.

CONSTRUCTION NOTES:

SLURRY SEAL SHALL NOT BE APPLIED OVER ANY MANHOLE, VALVE, SURVEY MONUMENT, OR MISCELLANEOUS FRAMES AND COVERS. ANY MATERIAL USED TO PROTECT SUCH DEVICES SHALL BE REMOVED AND DISPOSED OF LAWFULLY BY THE CONTRACTOR.

WORK SHALL BE COMPLETED IN TWO PARTS (HALF STREET EACH PART) TO ALLOW FOR INGRESS TO TRAFFIC.

ALL ROADS WHERE SLURRY SEAL WILL BE APPLIED SHALL BE PROPERLY SWEEPED AND BE FREE FROM DUST, MOISTURE, DEBRIS AND LOOSE PARTICLES PRIOR TO SLURRY SEAL PLACEMENT.

ALL ROADS WHERE SLURRY SEAL IS APPLIED SHALL BE FULLY SWEEPED 5 TO 8 DAYS AFTER SLURRY IS COMPLETE WITH RESIDUAL MATERIAL REMOVED AND DISPOSED TO A LEGAL DISPOSAL SITE.

PRIOR TO APPLYING CRACK SEALANT, THE PAVEMENT SURFACE SHALL BE DRY. CRACKS AND JOINTS SHALL BE CLEANED USING APPROPRIATE ROUTING, BRUSHING OR BLOWING OPERATIONS TO PROVIDE SUFFICIENT CONTACT BONDING SURFACES. CRACKS SHALL BE FREE FROM DUST, MOISTURE, DEBRIS, LOOSE PARTICLES AND OTHER CONTAMINANTS.

SURVEY MONUMENTS WITHIN SLURRY AREA

A PER SECTION 8771(b) OF THE BUSINESS AND PROFESSIONAL CODE, A PERSON AUTHORIZED TO PRACTICE LAND SURVEYING SHALL REFERENCE SURVEY MONUMENTS AND A CORNER RECORD OF THE REFERENCE SHALL BE FILED PRIOR TO CONSTRUCTION.

PER SECTION 8771(c) OF THE BUSINESS AND PROFESSIONAL CODE, ANY SURVEY MONUMENT THAT IS DESTROYED, DAMAGED, COVERED OR OBLITERATED SHALL BE REPLACED BY A PERSON AUTHORIZED TO PRACTICE LAND SURVEYING AND A CORNER RECORD OF THE MONUMENT SHALL BE FILED PRIOR TO A CERTIFICATE OF COMPLETION OF THE PROJECT IS ISSUED.

**Dynamic** CONSULTING  
ENGINEERS

CIVIL ENGINEERING - LAND SURVEYING - CONSTRUCTION MANAGEMENT  
2415 IMPERIAL BUSINESS PARK DRIVE, SUITE B.,  
IMPERIAL, CA. 92251

TEL (760) 545-0162

FAX (760) 545-0163

REV.	DATE	REVISION DESCRIPTION



PREPARED UNDER THE DIRECT SUPERVISION OF:

*Carlos Beltran*  
CARLOS BELTRAN, P.E.

69121  
R.C.E. No.

06/30/2026  
REG. EXP.



COUNTY OF IMPERIAL PUBLIC WORKS DEPARTMENT  
APPROVED FOR CONSTRUCTION BY:

*John A. Gay*  
JOHN A. GAY, P.E.

6/2/25  
DATE

62028  
R.C.E. No.

09/30/2025  
REG. EXP.



DATE 5/14/2025  
DRAWN DB, FM  
SCALE AS SHOWN  
CHECKED CB

ROAD REHABILITATION PROJECT FOR  
VARIOUS COUNTY ROADS  
AT GATEWAY OF THE AMERICAS  
COUNTY PROJECT NO. 6622GTW

MAGGIO ROAD

REFERENCE  
R-999

PAGE  
10 OF 21



NOTES:

1. Barricades shall be Type III for lane closures.
2. Each "ROAD WORK AHEAD" sign shall be equipped with at least two flags for daytime closure. Each flag shall be at least 16" x 16" in size and shall be orange or fluorescent red-orange in color.
3. All cones used for closures during the hours of darkness shall be fitted with retroreflective bands (or sleeves).
4. Portable delineators, placed at one-half the spacing indicated for traffic cones, may be used instead of cones for daytime closures only.
5. At least one person shall be assigned to provide full time maintenance of traffic control devices, unless otherwise directed by the Engineer.

TRAFFIC CONTROL LEGEND

- Portable Flashing Beacon
- Portable Delineator (42 in) with Retroreflective Bands
- Cone (28 in Min) with Retroreflective Bands
- Temporary Sign
- Barricades
- K-Rail
- Direction of Travel
- Turn Arrow
- Work Area
- Signalized Intersection
- Flagger
- Temporary Sign with Traffic Cone

TRAFFIC SIGNS

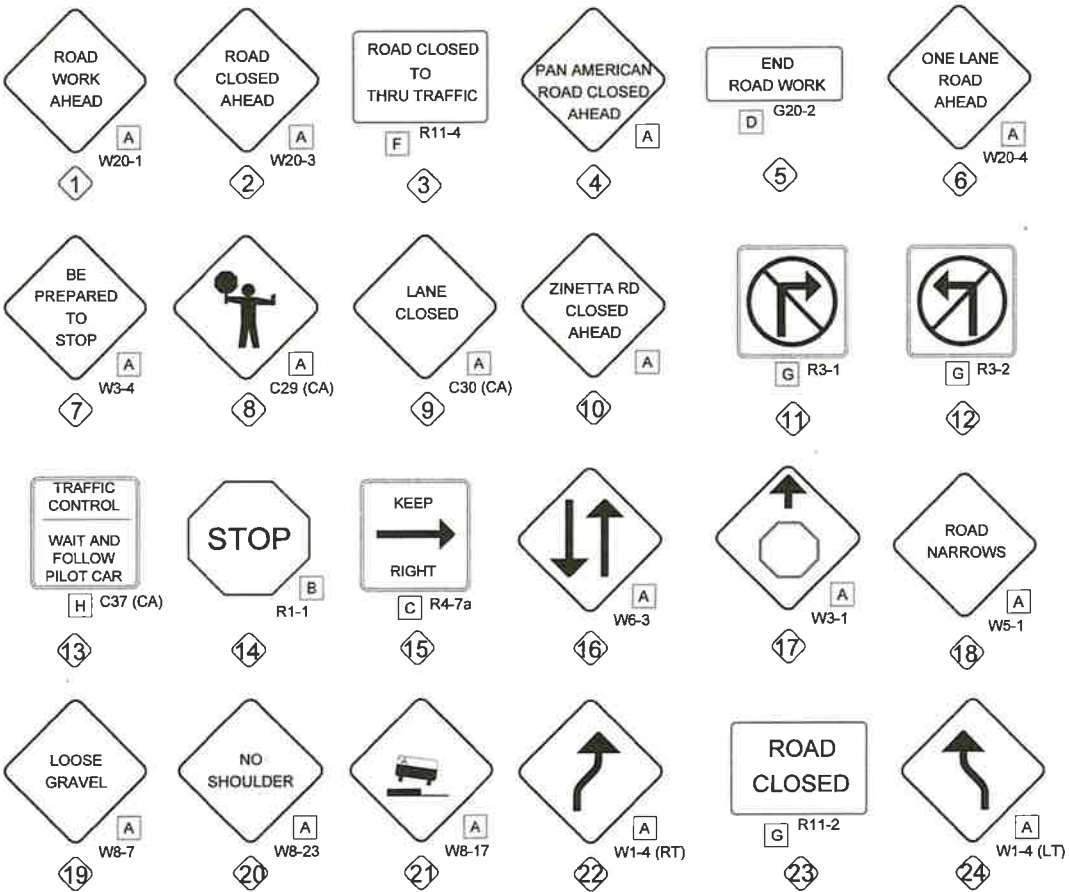

SIGN PANEL SIZE (Min)

A	48" x 48"	G	36" x 36"
B	30" x 30"	H	36" x 42"
C	24" x 30"	G	48" x 30"
D	48" x 24"		
E	30" x 36"		
F	60" x 30"		

NOTES:

Unless otherwise specified in the special provisions, all temporary warning signs shall have black legend on orange background.

California code are designated by (CA). Otherwise, Federal (MUTCD) codes are shown.

GENERAL TRAFFIC CONTROL NOTES:

- ALL TRAFFIC CONTROL DEVICES FOR THIS PROJECT SHALL BE IN ACCORDANCE WITH THE LATEST VERSION OF CALIFORNIA MANUAL OF UNIFORM TRAFFIC CONTROL DEVICES (CA MUTCD) AND CA MUTCD SUPPLEMENT UNLESS SPECIFIED OTHERWISE, AND THE LATEST VERSION OF THE CALTRANS STANDARD PLANS.
- TRAFFIC CONTROL SHOWN HEREIN IS THE MINIMUM REQUIRED. ADDITIONAL TRAFFIC CONTROL MAY BE REQUIRED TO FACILITATE PUBLIC SAFETY AND TRAFFIC FLOW IF DEEMED NECESSARY BY IMPERIAL COUNTY PUBLIC WORKS DEPARTMENT REPRESENTATIVE, CALTRANS REPRESENTATIVE, OR THE RESIDENT ENGINEER. THESE CHANGES MAY BE DONE IN THE FIELD.
- TRAFFIC CONTROL DEVICES SHOWN ON PLANS ARE LOCATED APPROXIMATELY AND SHALL BE ADJUSTED AS REQUIRED TO MEET FIELD CONDITIONS. ALL SUCH CHANGES MADE DUE TO FIELD CONDITIONS SHALL BE IN ACCORDANCE WITH THE LATEST VERSION OF CALTRANS STANDARD PLANS, CA MUTCD, CA MUTCD SUPPLEMENT, CALTRANS STANDARDS AND SPECIFICATIONS AND IMPERIAL COUNTY PUBLIC WORKS REQUIREMENTS.
- THROUGHOUT EACH WORK PERIOD, CONTRACTOR SHALL INSPECT TRAFFIC CONTROL (SIGNS, BARRICADES AND DELINEATORS) AND MAINTAIN SAME IN ACCORDANCE WITH TRAFFIC CONTROL PLANS.
- ACCESS TO PRIVATE PROPERTY SHALL BE MAINTAINED AT ALL TIMES.
- ALL SIGNS SHALL BE HIGH INTENSITY REFLECTIVE. ALL TRAFFIC CONTROL DEVICES SHALL BE REFLECTIVE. FLASHING LIGHTS SHALL BE PROVIDED FOR ALL BARRICADES AT EACH END OF THE LANE CLOSURE.
- THE INTENSITY AND DISTRIBUTION OF LIGHT FROM EACH ILLUMINATED SIGNAL LENS SHOULD CONFORM TO THE CURRENT "STANDARDS FOR VEHICLE TRAFFIC CONTROL SIGNAL HEADS" AND "TRAFFIC SIGNAL LAMPS" (SEE SECTION 1A.11 OF LATEST VERSION OF CA MUTCD). IF A SIGNAL INDICATION IS OPERATED IN THE FLASHING MODE FOR NIGHTTIME OPERATION AND THE SIGNAL INDICATION IS SO BRIGHT AS TO CAUSE EXCESSIVE GLARE, SOME FORM OF AUTOMATIC DIMMING SHOULD BE USED TO REDUCE THE BRILLIANCE OF THE SIGNAL INDICATION.
- REFER TO THE LATEST REVISION OF CA MUTCD AND CALTRANS STANDARD PLANS REGARDING THE NOTES FOR EACH TYPICAL APPLICATION CALLED OUT ON THIS PLAN.
- CONTRACTOR SHALL INSPECT TRAFFIC CONTROL AT THE BEGINNING AND AT THE END OF EACH WORKING DAY TO ENSURE COMPLIANCE WITH THESE PLANS.
- CONTRACTOR SHALL INSTALL ADA COMPLIANT TEMPORARY RAMPS BETWEEN THE EDGE OF THE EXISTING CURB RETURN/ HANDICAP RAMP AND EXCAVATED SURFACE AT THE END OF EACH WORK DAY.
- NO STREET PARKING SHALL BE ALLOWED ALONG THE CONSTRUCTION ZONES DURING THE PROJECT CONSTRUCTION PERIOD. CONTRACTOR SHALL INSTALL NO PARKING SIGNS (R8-3A) AT ALL REQUIRED AREAS AT LEAST ONE WEEK PRIOR TO BEGINNING OF CONSTRUCTION.
- CONTRACTOR SHALL INSTALL TEMPORARY TRAFFIC CONTROL DEVICES ACCORDING TO TYPICAL APPLICATION CA MUTCD 2014, FIGURE 6H-29 (TA-29): CROSSWALK CLOSURES AND PEDESTRIAN DETOURS IF REQUIRED TO PROVIDE TEMPORARY PEDESTRIAN ACCESS AT ALL INTERSECTIONS AFFECTED BY THE PROPOSED CONSTRUCTION ACTIVITIES. IF NECESSARY CONTRACTOR SHALL PROVIDE FLAG PERSONNEL FOR ADDITIONAL TRAFFIC CONTROL AS NEEDED.
- IF A PORTION OF THE CONSTRUCTION AREA MUST REMAIN OPEN AT THE END OF EACH WORK DAY, EACH EXPOSED SECTION MUST BE COMPLETELY FILLED WITH CLASS 2 BASE MATERIAL AND SURROUNDED WITH BARRICADES AND TAPE OR AS APPROVED BY THE COUNTY ENGINEER.
- ALL ADJACENT BUSINESSES, RESIDENCES, SCHOOLS AND CHURCHES SHALL BE DULY NOTIFIED BY THE CONTRACTOR, IN WRITING, OF HIS PROPOSED OPERATIONS. NOTICE SHALL BE DELIVERED AT LEAST TWO (2) WORKING WEEKS PRIOR TO START OF CONSTRUCTION ACTIVITIES. THE CONTRACTOR SHALL BE RESPONSIBLE FOR REPRODUCTION OF NOTIFICATION LETTERS. THE NOTIFICATION LETTERS SHALL BE WRITTEN IN ENGLISH AND SPANISH LANGUAGES. RE-NOTIFICATION WILL BE REQUIRED IF THE CONTRACTOR'S SCHEDULE IS ALTERED OR OTHER DELAYS OCCUR WHICH AFFECT THE PROJECT SCHEDULE.
- THE CONTRACTOR SHALL MAKE ACCOMMODATIONS TO ALLOW REGULARLY SCHEDULED SOLID WASTE DISPOSAL PICK UP ALONG THE AFFECTED STREET SECTIONS DURING THE PROJECT CONSTRUCTION PERIOD.
- CONTRACTOR SHALL COVER EXISTING TRAFFIC SIGNS, TRAFFIC SIGNALS, OR PEDESTRIAN SIGNAL INDICATIONS SHOULD SAID CONTROLS CONFLICT WITH TEMPORARY TRAFFIC CONTROL PLAN OR AS DIRECTED BY THE COUNTY PUBLIC WORKS DEPARTMENT.
- WHENEVER THE WORK CAUSES OBLITERATION OF PAVEMENT DELINEATION, TEMPORARY OR PERMANENT PAVEMENT DELINEATION SHALL BE IN PLACE PRIOR TO OPENING THE TRAVELED WAY TO PUBLIC TRAFFIC. LANE LINES AND CENTERLINE PAVEMENT DELINEATION SHALL BE PROVIDED AT ALL TIMES FOR TRAVELED WAYS OPEN TO THE PUBLIC TRAFFIC.
- CONTRACTOR SHALL REPLACE/REPAIR ANY AND ALL STRIPING, PAVEMENT MARKINGS, RAISED PAVEMENT MARKERS, AND CURB PAINT DISRUPTED OR REMOVED DURING THE CONSTRUCTION TO THE SATISFACTION OF THE COUNTY ENGINEER.
- ALL ADVANCED WARNING SIGNS SHALL BE EQUIPPED WITH FLAGS FLASHING YELLOW BEACONS, TYPE-B SHALL BE USED ON ALL W20-1, W20-2, C-19 SIGNS AND ON ALL TYPE-III AND TYPE-II BARRICADES GUARDING THE WORK AREA OVERNIGHT.

**Dynamic**

CONSULTING  
ENGINEERS

CIVIL ENGINEERING - LAND SURVEYING - CONSTRUCTION MANAGEMENT  
2415 IMPERIAL BUSINESS PARK DRIVE, SUITE B,  
IMPERIAL CA. 92251  
TEL: (760) 545-0152 FAX: (760) 545-0163

REV. DATE REVISION DESCRIPTION

CARLOS BELTRAN  
No. 69121  
EXP. 6-30-26  
CIVIL  
STATE OF CALIFORNIA

PREPARED UNDER THE DIRECT SUPERVISION OF:  
CARLOS BELTRAN, P.E.  
DATE

69121  
R.C.E. No.  
06/30/2026  
REG. EXP.

COUNTY OF IMPERIAL PUBLIC WORKS DEPARTMENT  
APPROVED FOR CONSTRUCTION BY:  
JOHN A. GAY, P.E.  
DATE

62028  
R.C.E. No.  
09/30/2025  
REG. EXP.

PUBLIC WORKS DEPARTMENT  
COUNTY OF IMPERIAL  
EL CENTRO, CALIFORNIA

DATE: 5/14/2025  
DRAWN: DB, FM  
SCALE: AS SHOWN  
CHECKED: CB

ROAD REHABILITATION PROJECT FOR  
VARIOUS COUNTY ROADS  
AT GATEWAY OF THE AMERICAS  
COUNTY PROJECT NO. 6622GTW

TRAFFIC CONTROL PLAN  
GENERAL NOTES  
REFERENCE  
R-999

PAGE  
11 OF 21





PAN AMERICAN ROAD

NOTE: PLAN NOT TO SCALE (NTS)

TRAFFIC CONTROL LEGEND

- \* Portable Flashing Beacon
- Portable Delineator (42 in) with Retroreflective Bands
- ▲ Cone (28 in Min) with Retroreflective Bands
- ┆ Temporary Sign
- ⚡ Barricades
- K-Rail
- ➡ Direction of Travel
- ↩ Turn Arrow
- ▨ Work Area
- Ⓢ Signalized Intersection
- 🚧 Flagger
- ⚡ Temporary Sign with Traffic Cone

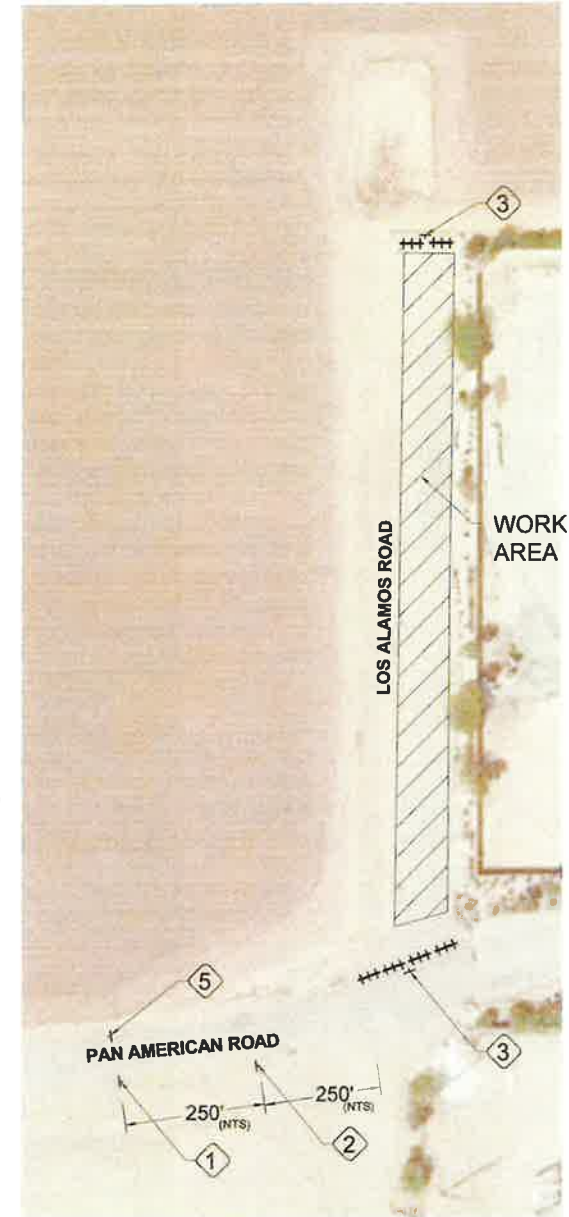





NOTE: PLAN NOT TO SCALE (NTS)

LOS ALAMOS ROAD

NOTE:  
CONTRACTOR TO NOTIFY BUSINESS OWNERS CONSTRUCTION ACTIVITIES, ROAD CLOSURE AND SCHEDULE TWO WEEKS PRIOR TO START WORK ON PAN AMERICAN ROAD AND LOS ALAMOS ROAD.

**Dynamic** CONSULTING ENGINEERS

CIVIL ENGINEERING - LAND SURVEYING - CONSTRUCTION MANAGEMENT  
2415 IMPERIAL BUSINESS PARK DRIVE, SUITE B,  
IMPERIAL, CA 92251  
TEL (760) 545-0162 FAX (760) 545-0163

REV.			DATE	REVISION DESCRIPTION			PREPARED UNDER THE DIRECT SUPERVISION OF:				COUNTY OF IMPERIAL PUBLIC WORKS DEPARTMENT APPROVED FOR CONSTRUCTION BY:				DATE 5/14/2025	DRAWN DB, FM	SCALE AS SHOWN	CHECKED CB	ROAD REHABILITATION PROJECT FOR VARIOUS COUNTY ROADS AT GATEWAY OF THE AMERICAS  COUNTY PROJECT NO. 6622GTW		TRAFFIC CONTROL PLAN PAN AMERICAN RD & LOS ALAMOS RD	
							CARLOS BELTRAN No. 89121 EXP 8-30-28 CIVIL STATE OF CALIFORNIA	 CARLOS BELTRAN, P.E. 6/2/25 DATE	89121 R.C.E. No. 06/30/2026 REG. EXP.			 JOHN A. GAY, P.E. 6/2/25 DATE	62028 R.C.E. No. 06/30/2025 REG. EXP.	PUBLIC WORKS DEPARTMENT COUNTY OF IMPERIAL EL CENTRO, CALIFORNIA							REFERENCE R-999	PAGE 12 OF 21



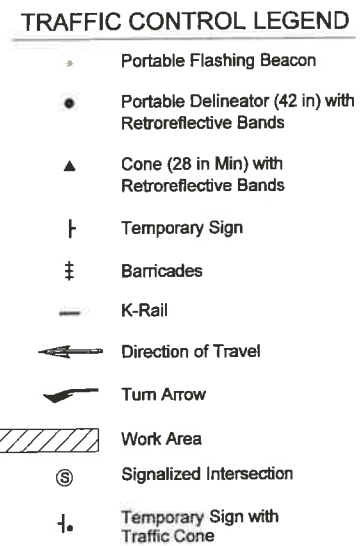







**Dynamic** CONSULTING  
ENGINEERS

CIVIL ENGINEERING - LAND SURVEYING - CONSTRUCTION MANAGEMENT

2415 IMPERIAL BUSINESS PARK DRIVE, SUITE B.,  
IMPERIAL CA. 92251

TEL (760) 545-0162 FAX (760) 545-0183

REV.			DATE			REVISION DESCRIPTION					PREPARED UNDER THE DIRECT SUPERVISION OF:  CARLOS BELTRAN, P.E. No. 68121 EXP. 6-30-26 		68121 R.C.E. No. 06/30/2026 REG. EXP.				COUNTY OF IMPERIAL PUBLIC WORKS DEPARTMENT APPROVED FOR CONSTRUCTION BY:  JOHN A. GAY, P.E. No. 62028 R.C.E. No. 09/30/2025 REG. EXP.		 PUBLIC WORKS DEPARTMENT <b>COUNTY OF IMPERIAL</b> EL CENTRO, CALIFORNIA		DATE: 5/14/2025 DRAWN: DB, FM BY: AS SHOWN CHECKED: CB		<b>ROAD REHABILITATION PROJECT FOR VARIOUS COUNTY ROADS AT GATEWAY OF THE AMERICAS</b>  <b>COUNTY PROJECT NO. 6622GTW</b>		<b>TRAFFIC CONTROL PLAN ZINETTA ROAD</b>  REFERENCE: <b>R-999</b> PAGE: <b>13 OF 21</b>	
------	--	--	------	--	--	----------------------	--	--	--	--	---	--	--	--	---	--	--	--	---	--	---	--	---	--	--	--



TYPICAL LANE CLOSURE WITH REVERSIBLE CONTROL

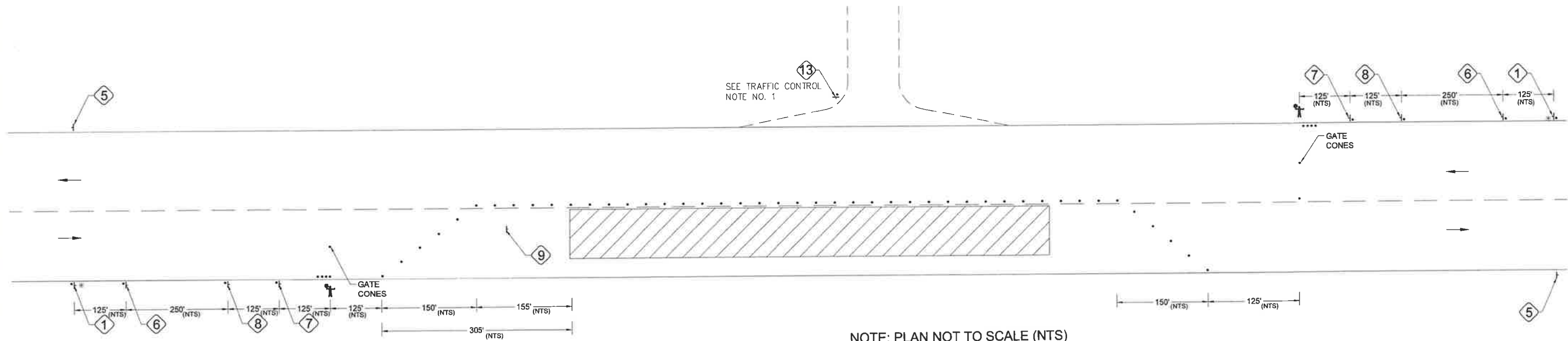

NOTE: PLAN NOT TO SCALE (NTS)

TRAFFIC CONTROL NOTE

1. WHEN A PILOT CAR IS USED, PLACE A C37(CA) "TRAFFIC CONTROL - WAIT AND FOLLOW PILOT CAR" SIGN WITH BLACK LEGEND ON WHITE BACKGROUND AT ALL INTERSECTIONS, DRIVEWAYS AND ALLEYS WITHOUT A FLAGGER WITHIN TRAFFIC CONTROL AREAS. SIGNS SHALL BE CLEAN AND VISIBLE AT ALL TIMES. WHERE TRAFFIC CAN NOT BE EFFECTIVELY SELF-REGULATED, AT LEAST ONE FLAGGER SHALL BE USED AT EACH INTERSECTION WITHIN TRAFFIC CONTROL AREAS.

PORTABLE DELINEATORS PLACED AT ONE-HALF THE SPACING INDICATED FOR TRAFFIC CONES MAY BE USED INSTEAD OF CONES FOR DAYTIME CLOSURES ONLY.

SIGN MUST BE EQUIPPED WITH AT LEAST TWO FLAGS FOR DAYTIME CLOSURES. FLAGS MUST BE ORANGE IN COLOR AND AT LEAST 16 INCHES BY 16 INCHES IN SIZE.

PLACE FLASHING BEACONS AS SHOWN FOR CLOSURES DURING HOURS OF DARKNESS.

A G20-2 "END ROAD WORK" SIGN, SHALL BE PLACED AT THE END OF THE LANE CLOSURE UNLESS THE END OF WORK AREA IS OBVIOUS OR ENDS WITHIN THE LARGER PROJECT'S LIMITS.

AN OPTIONAL C29(CA) SIGN MAY BE PLACED BELOW THE C9A(CA) SIGN.

PLACE C39(CA) "LANE CLOSED" SIGN AT 500' TO 1000' INTERVALS THROUGHOUT EXTENDED WORK AREA. THEY ARE OPTIONAL IF THE WORK AREA IS VISIBLE FROM THE FLAGGER STATION.

LENGTH MAY BE REDUCED BY THE ENGINEER TO ADDRESS SITE CONDITIONS.

EITHER TRAFFIC CONES OR BARRICADES SHALL BE PLACED ON THE TAPER. BARRICADES SHALL BE TYPE I, II, OR III.

IF C45(CA) IS NOT USED, MEASURE DISTANCE C FROM W20-4.

TYPICAL TRAFFIC CONTROL SYSTEM FOR LANE CLOSURE ON TWO LANE STREET/CONVENTINAL HIGHWAY

TYPICAL TRAFFIC CONTROL PLAN

ROAD ROAD: PILOT CAR WILL BE REQUIRED

NOTE:  
CONTRACTOR TO NOTIFY BUSINESS OWNERS CONSTRUCTION ACTIVITIES, ROAD CLOSURE AND SCHEDULE TWO WEEKS PRIOR TO START WORK.

TRAFFIC CONTROL LEGEND

- \* Portable Flashing Beacon
- Portable Delineator (42 in) with Retroreflective Bands
- ▲ Cone (28 in Min) with Retroreflective Bands
- † Temporary Sign
- ‡ Barricades
- K-Rail
- ← Direction of Travel
- ↩ Turn Arrow
- ▨ Work Area
- Ⓢ Signalized Intersection
- 🚧 Flagger
- † Temporary Sign with Traffic Cone

**Dynamic** CONSULTING ENGINEERS  
CIVIL ENGINEERING - LAND SURVEYING - CONSTRUCTION MANAGEMENT  
2415 IMPERIAL BUSINESS PARK DRIVE, SUITE B.,  
IMPERIAL CA, 92251  
TEL: (760) 545-0182 FAX: (760) 545-0183

REV.	DATE	REVISION DESCRIPTION	PREPARED UNDER THE DIRECT SUPERVISION OF:		COUNTY OF IMPERIAL PUBLIC WORKS DEPARTMENT APPROVED FOR CONSTRUCTION BY:		DATE		ROAD REHABILITATION PROJECT FOR VARIOUS COUNTY ROADS AT GATEWAY OF THE AMERICAS		TRAFFIC CONTROL PLAN ROAD RD	
			CARLOS BELTRAN, P.E.		JOHN A. GAY, P.E.		5/14/2025		COUNTY PROJECT NO. 6622GTW		REFERENCE	
			6/2/25		6/2/25		DB, FM				R-999	
			06/30/2026		06/30/2025		AS SHOWN				PAGE	
			REG. EXP.		REG. EXP.		CB				14 OF 21	



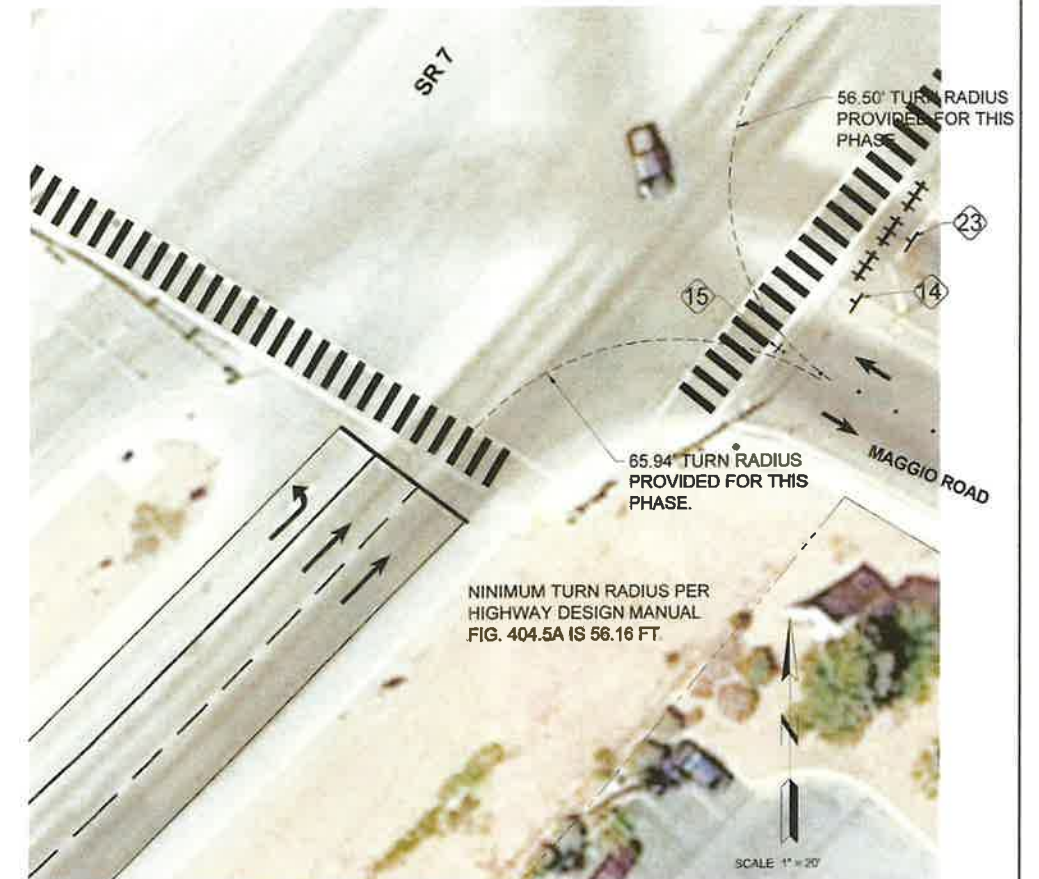
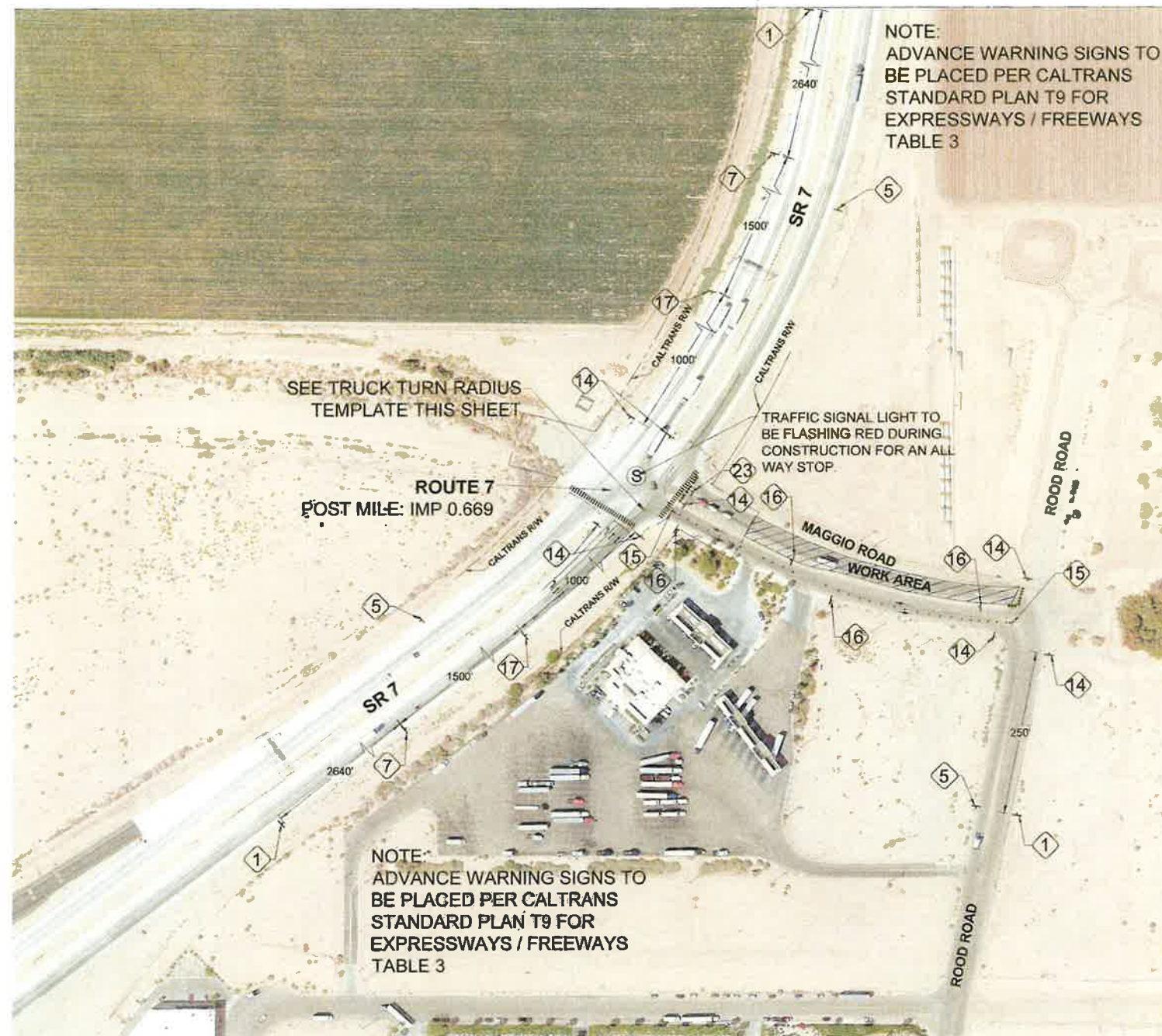

TRUCK TURN RADIUS TEMPALTE

#### LEGEND

- ◆ Portable Flashing Beacon
- Portable Delineator (42 in) Spaced 10 ft Apart with Retroreflective Bands
- ▲ Cone (28 in Min) with Retroreflective Bands
- ⊥ Temporary Sign
- ⚡ Barricades
- K-Rail
- ← Direction of Travel
- ↩ Turn Arrow
- ▨ Road Closure
- Ⓢ Signalized Intersection
- ⊥ Temporary Sign with Traffic Cone

MAGGIO ROAD IMPROVEMENTS TO BE COMPLETED IN TWO PHASES.

#### PHASE 1 CONSTRUCTION:



- TYPE II SLURRY SEAL NORTH SIDE OF MAGGIO ROAD (NORTH OF EXISTING MEDIAN).
- VEHICULAR ACCESS TO BE ON THE SOUTH SIDE OF MAGGIO ROAD (SOUTH OF EXISTING MEDIAN).
- MINIMUM TRAVEL LANE WIDTH SHALL BE NO LESS THAN 11.0 FT.

**ROAD CLOSURE NOTE:**  
CONTRACTOR TO NOTIFY BUSINESS OWNERS CONSTRUCTION ACTIVITIES, ROAD CLOSURE AND SCHEDULE TWO WEEKS PRIOR TO START WORK.

**Dynamic CONSULTING ENGINEERS**  
CIVIL ENGINEERING - LAND SURVEYING - CONSTRUCTION MANAGEMENT  
2415 IMPERIAL BUSINESS PARK DRIVE, SUITE B.,  
IMPERIAL CA. 92251  
TEL (760) 545-0162 FAX (760) 545-0163

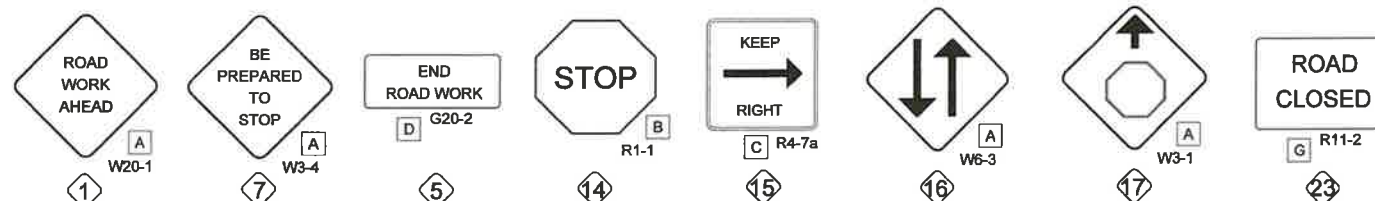
#### TRAFFIC SIGNS



REV.	DATE	REVISION DESCRIPTION	PREPARED UNDER THE DIRECT SUPERVISION OF:		COUNTY OF IMPERIAL PUBLIC WORKS DEPARTMENT APPROVED FOR CONSTRUCTION BY:		PUBLIC WORKS DEPARTMENT		ROAD REHABILITATION PROJECT FOR VARIOUS COUNTY ROADS AT GATEWAY OF THE AMERICAS COUNTY PROJECT NO. 6622GTW	TRAFFIC CONTROL PLAN MAGGIO RD PHASE 1	
				CARLOS BELTRAN, P.E. DATE: 6/2/25	66121 R.C.E. No. 06/30/2026 REG. EXP.		JOHN A. GAY, P.E. DATE: 6/2/25	62028 R.C.E. No. 06/30/2026 REG. EXP.		REFERENCE R-999	PAGE 15 OF 21



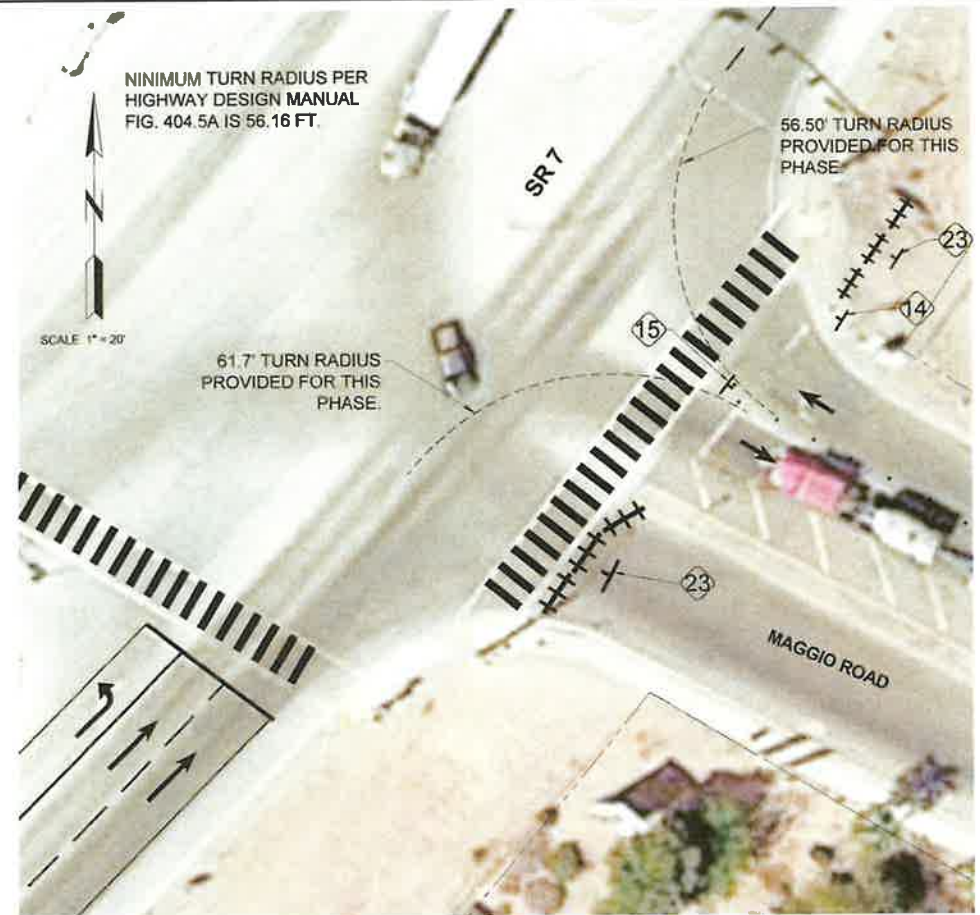
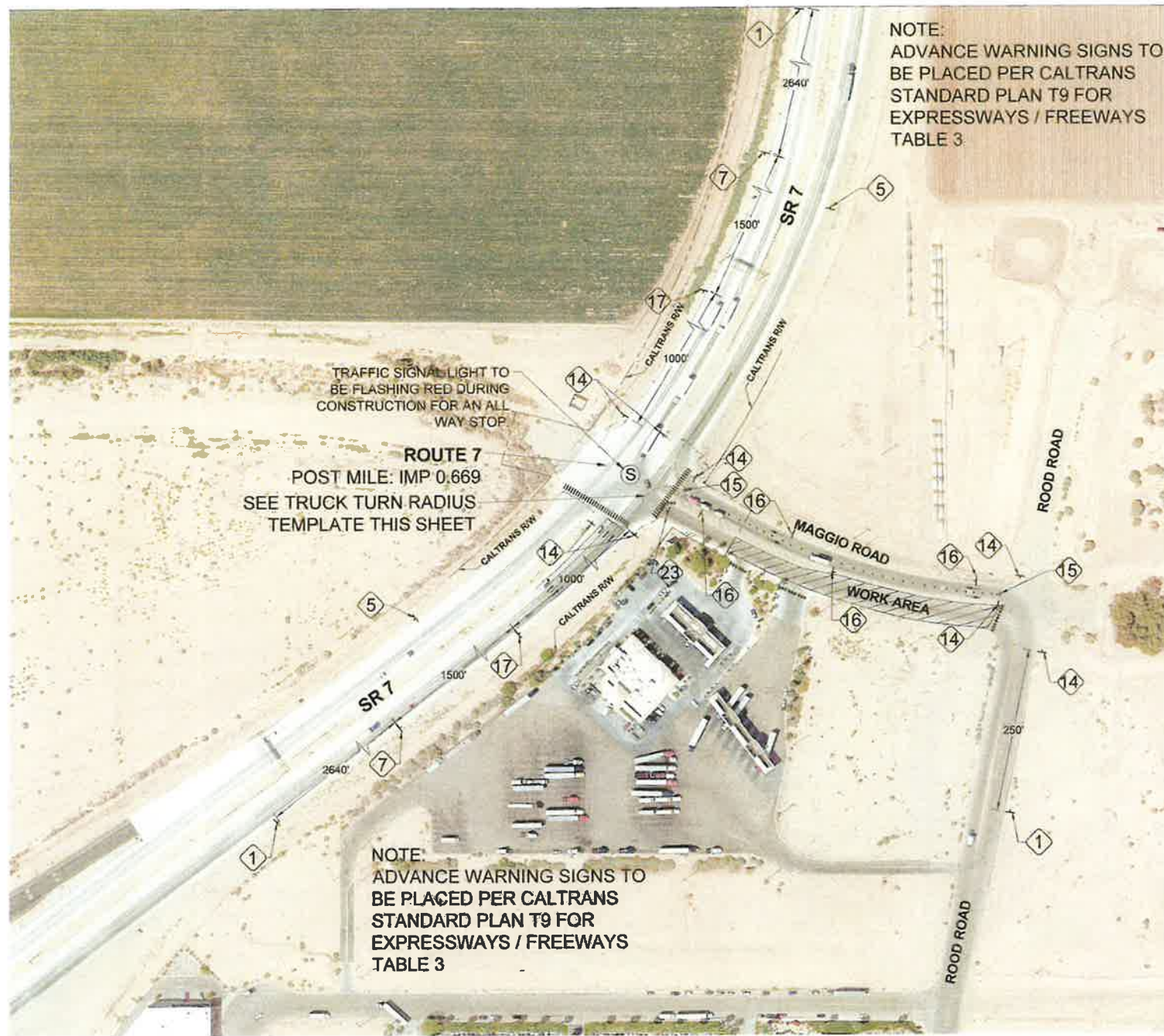

TRUCK TURN RADIUS TEMPALTE

LEGEND

- Portable Flashing Beacon
- Portable Delineator (42 in) Spaced 10 ft Apart with Retroreflective Bands
- ▲ Cone (28 in Min) with Retroreflective Bands
- † Temporary Sign
- ‡ Barricades
- K-Rail
- ← Direction of Travel
- ↩ Turn Arrow
- ▨ Road Closure
- Ⓢ Signalized Intersection
- † Temporary Sign with Traffic Cone

MAGGIO ROAD IMPROVEMENTS TO BE COMPLETED IN TWO PHASES.

PHASE 2 CONSTRUCTION:

- TYPE II SLURRY SEAL SOUTH SIDE OF MAGGIO ROAD (SOUTH OF EXISTING MEDIAN).
- VEHICULAR ACCESS TO BE ON THE NORTH SIDE OF MAGGIO ROAD (SOUTH OF EXISTING MEDIAN). ACCESS TO EXISTING BUSINESS ALONG MAGGIO ROAD SHALL BE FROM ROAD ROAD DURING PHASE 2 CONSTRUCTION.
- MINIMUM TRAVEL LANE WIDTH SHALL BE NO LESS THAN 11.0 FT.

**ROAD CLOSURE NOTE:**  
CONTRACTOR TO NOTIFY BUSINESS OWNERS CONSTRUCTION ACTIVITIES, ROAD CLOSURE AND SCHEDULE TWO WEEKS PRIOR TO START WORK.

TRAFFIC SIGNS

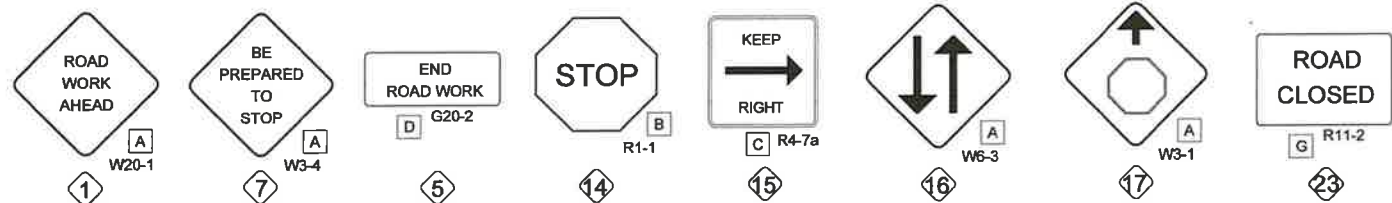

REV.	DATE	REVISION DESCRIPTION

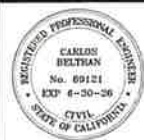

PREPARED UNDER THE DIRECT SUPERVISION OF:  
  
 CARLOS BELTRAN, P.E.  
 69121 R.C.E. No.  
 06/30/2026 REG. EXP.



COUNTY OF IMPERIAL PUBLIC WORKS DEPARTMENT  
 APPROVED FOR CONSTRUCTION BY:  
  
 JOHN A. GAY, P.E.  
 62028 R.C.E. No.  
 09/30/2025 REG. EXP.



DATE 5/14/2025  
 DRAWN DB, FM  
 SCALE AS SHOWN  
 CHECKED CB

**ROAD REHABILITATION PROJECT FOR  
 VARIOUS COUNTY ROADS  
 AT GATEWAY OF THE AMERICAS**  
 COUNTY PROJECT NO. 6622GTW

**Dynamic CONSULTING ENGINEERS**  
 CIVIL ENGINEERING - LAND SURVEYING - CONSTRUCTION MANAGEMENT  
 2415 IMPERIAL BUSINESS PARK DRIVE, SUITE B.,  
 IMPERIAL CA 92251  
 TEL (760) 545-0182 FAX (760) 545-0183

TRAFFIC CONTROL PLAN  
 MAGGIO RD PHASE 2

REFERENCE  
**R-999**  
 PAGE  
 16 OF 21



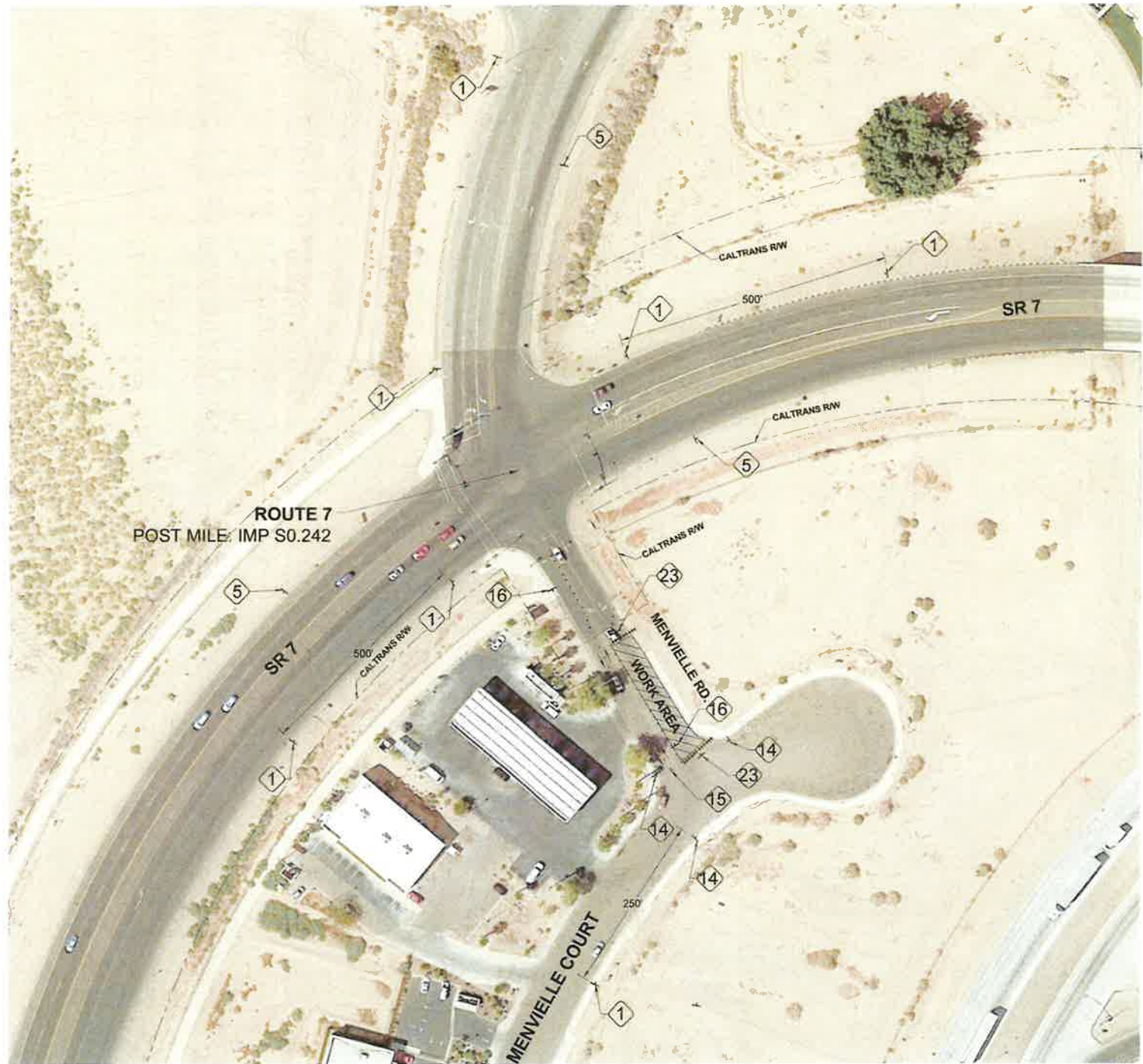

MENVILLE ROAD IMPROVEMENTS TO BE COMPLETED IN TWO PHASES.

PHASE 1 CONSTRUCTION:

- TYPE II SLURRY SEAL NORTH SIDE OF MENVILLE ROAD.
- VEHICULAR ACCESS TO BE ON THE SOUTH SIDE OF MENVILLE ROAD.
- MINIMUM TRAVEL LANE WIDTH SHALL BE NO LESS THAN 11.0 FT.

LEGEND

- Portable Flashing Beacon
- Portable Delineator (42 in) Spaced 10 ft Apart with Retroreflective Bands
- ▲ Cone (28 in Min) with Retroreflective Bands
- ┆ Temporary Sign
- ‡ Barricades
- K-Rail
- ➔ Direction of Travel
- ➔ Turn Arrow
- ▨ Road Closure
- Ⓢ Signalized Intersection
- ┆ Temporary Sign with Traffic Cone

ROAD CLOSURE NOTE:  
CONTRACTOR TO NOTIFY BUSINESS OWNERS CONSTRUCTION ACTIVITIES, ROAD CLOSURE AND SCHEDULE TWO WEEKS PRIOR TO START WORK.

TRAFFIC SIGNS

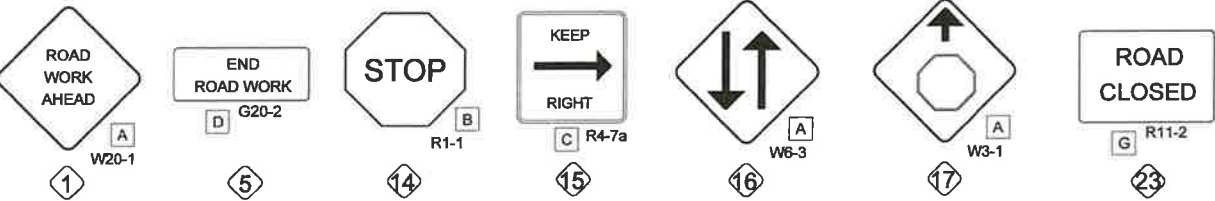

**Dynamic** CONSULTING ENGINEERS  
CIVIL ENGINEERING-LAND SURVEYING-CONSTRUCTION MANAGEMENT  
2415 IMPERIAL BUSINESS PARK DRIVE, SUITE B.,  
IMPERIAL, CA. 92251  
TEL. (760) 545-0182 FAX (760) 545-0163

REV.	DATE	REVISION DESCRIPTION



PREPARED UNDER THE DIRECT SUPERVISION OF:  
**CARLOS BELTRAN, P.E.**  
DATE: 6/2/25  
69121 R.C.E. No.  
09/30/2026 REG. EXP.



COUNTY OF IMPERIAL PUBLIC WORKS DEPARTMENT  
APPROVED FOR CONSTRUCTION BY:  
**JOHN A. GAY, P.E.**  
DATE: 6/2/25  
62028 R.C.E. No.  
09/30/2026 REG. EXP.



DATE	5/14/2025
DRAWN	DB, FM
SCALE	AS SHOWN
CHECKED	CB

ROAD REHABILITATION PROJECT FOR  
VARIOUS COUNTY ROADS  
AT GATEWAY OF THE AMERICAS  
COUNTY PROJECT NO. 6622GTW

TRAFFIC CONTROL PLAN MENVILLE RD PHASE 1	
REFERENCE <b>R-999</b>	PAGE 17 OF 21





MENVILLE ROAD IMPROVEMENTS TO BE COMPLETED IN TWO PHASES.

- PHASE 2 CONSTRUCTION:**
- TYPE II SLURRY SEAL SOUTH SIDE OF MENVILLE ROAD.
  - VEHICULAR ACCESS TO BE ON THE NORTH SIDE OF MENVILLE ROAD. ACCESS TO EXISTING BUSINESSES ALONG MENVILLE ROAD SHALL BE FROM MENVILLE COURT DURING PHASE 2 CONSTRUCTION.
  - MINIMUM TRAVEL LANE WIDTH SHALL BE NO LESS THAN 11.0 FT.

**LEGEND**

- \* Portable Flashing Beacon
- Portable Delineator (42 in) Spaced 10 ft Apart with Retroreflective Bands
- ▲ Cone (28 in Min) with Retroreflective Bands
- † Temporary Sign
- ‡ Barricades
- K-Rail
- Direction of Travel
- ↪ Turn Arrow
- ▨ Road Closure
- Ⓢ Signalized Intersection
- †• Temporary Sign with Traffic Cone

**ROAD CLOSURE NOTE:**  
CONTRACTOR TO NOTIFY BUSINESS OWNERS CONSTRUCTION ACTIVITIES, ROAD CLOSURE AND SCHEDULE TWO WEEKS PRIOR TO START WORK.

**TRAFFIC SIGNS**

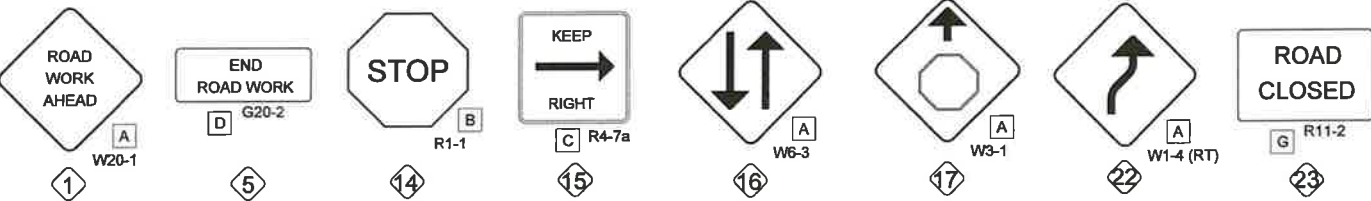

REV.	DATE	REVISION DESCRIPTION



PREPARED UNDER THE DIRECT SUPERVISION OF:  
  
CARLOS BELTRAN, P.E.  
6/2/25  
DATE



COUNTY OF IMPERIAL PUBLIC WORKS DEPARTMENT  
APPROVED FOR CONSTRUCTION BY:  
JOHN A. GAY, P.E.  
6/2/25  
DATE



DATE	5/14/2025
DRAWN	DB, FM
SCALE	AS SHOWN
CHECKED	CB

**ROAD REHABILITATION PROJECT FOR  
VARIOUS COUNTY ROADS  
AT GATEWAY OF THE AMERICAS**  
  
COUNTY PROJECT NO. 6622GTW

**Dynamic** CONSULTING ENGINEERS

CIVIL ENGINEERING - LAND SURVEYING - CONSTRUCTION MANAGEMENT  
2415 IMPERIAL BUSINESS PARK DRIVE, SUITE B.,  
IMPERIAL, CA. 92251  
TEL. (760) 545-0162 FAX (760) 545-0163

TRAFFIC CONTROL PLAN MENVILLE RD PHASE 2	
REFERENCE <b>R-999</b>	PAGE <b>18 OF 21</b>





**TRAFFIC CONTROL NOTE:**  
CALTRANS STANDARD PLAN T12 DOES NOT APPLY TO THIS SPECIFIC PORTION OF THE WORK SINCE SINCE T12 IS FOR TRAFFIC CONTROL FOR WORK ON MULTILANE HIGHWAYS AND EXPRESSWAYS. THE WORK IN THIS PHASE IS ON A LOCAL COUNTY ROAD. STERGIOS RD.

NINA LEE ROAD IMPROVEMENTS TO BE COMPLETED IN THREE PHASES.

**PHASE 1 CONSTRUCTION:**

- 2 INCH COLD PLANE THE NORTH-EAST HALF OF NINA ROAD.
- VEHICULAR ACCESS TO BE ON THE SOUTH-WEST SIDE OF NINA ROAD ROAD.

**PHASE 3 CONSTRUCTION:**

- CRACK SEAL AND PLACE NEW ASPHALT CONCRETE PAVEMENT ON THE NORTH-EAST HALF OF NINA ROAD.
- VEHICULAR ACCESS TO BE ON THE SOUTH-WEST SIDE OF NINA ROAD ROAD.

**LEGEND**

- \* Portable Flashing Beacon
- Portable Delineator (42 in) Spaced 10 ft Apart with Retroreflective Bands
- ▲ Cone (28 in Min) with Retroreflective Bands
- † Temporary Sign
- ‡ Barricades
- K-Rail
- Direction of Travel
- ↪ Turn Arrow
- ▨ Road Closure
- Ⓢ Signalized Intersection
- †• Temporary Sign with Traffic Cone

**ROAD CLOSURE NOTE:**  
CONTRACTOR TO NOTIFY BUSINESS OWNERS CONSTRUCTION ACTIVITIES, ROAD CLOSURE AND SCHEDULE TWO WEEKS PRIOR TO START WORK.

**TRAFFIC SIGNS**

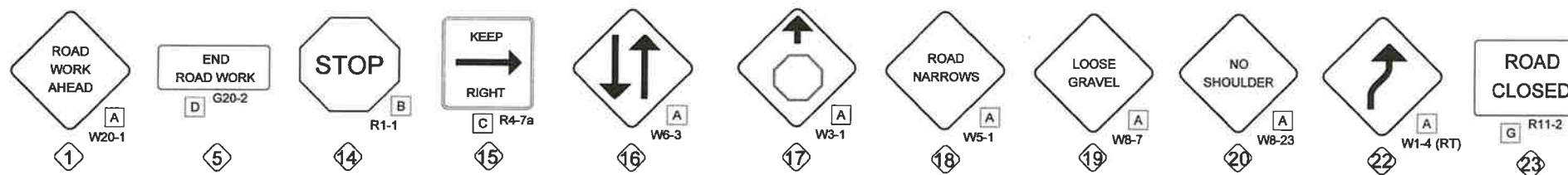

**Dynamic CONSULTING ENGINEERS**  
CIVIL ENGINEERING - LAND SURVEYING - CONSTRUCTION MANAGEMENT  
2415 IMPERIAL BUSINESS PARK DRIVE, SUITE B,  
IMPERIAL, CA. 92251  
TEL. (760) 545-0182 FAX (760) 545-0183

REV.	DATE	REVISION DESCRIPTION	PREPARED UNDER THE DIRECT SUPERVISION OF:	APPROVED FOR CONSTRUCTION BY:	COUNTY OF IMPERIAL PUBLIC WORKS DEPARTMENT	DATE	ROAD REHABILITATION PROJECT FOR VARIOUS COUNTY ROADS AT GATEWAY OF THE AMERICAS	TRAFFIC CONTROL PLAN NINA LEE RD PHASE 1 AND 3
			CARLOS BELTRAN, P.E.	JOHN A. GAY, P.E.	PUBLIC WORKS DEPARTMENT	5/14/2025	COUNTY PROJECT NO. 6622GTW	REFERENCE R-999
			6/2/25	6/2/25	EL CENTRO, CALIFORNIA	DB, FM		PAGE 19 OF 21
			06/30/2026	09/30/2025		SCALE AS SHOWN		
						CHECKED CB		





**TRAFFIC CONTROL NOTE:**  
CALTRANS STANDARD PLAN T12 DOES NOT APPLY TO THIS SPECIFIC PORTION OF THE WORK SINCE SINCE T12 IS FOR TRAFFIC CONTROL FOR WORK ON MULTILANE HIGHWAYS AND EXPRESSWAYS. THE WORK IN THIS PHASE IS ON A LOCAL COUNTY ROAD. STERGIOS RD.

NINA LEE ROAD IMPROVEMENTS TO BE COMPLETED IN THREE PHASES.

**PHASE 2 CONSTRUCTION:**

- 2 INCH COLD PLANE THE SOUTH-WEST HALF OF NINA ROAD. CRACK SEAL AND PLACE NEW ASPHALT CONCRETE PAVEMENT.
- VEHICULAR ACCESS TO BE ON THE NORTH-EAST SIDE OF NINA ROAD ROAD.

**LEGEND**

- \* Portable Flashing Beacon
- Portable Delineator (42 in) Spaced 10 ft Apart with Retroreflective Bands
- ▲ Cone (28 in Min) with Retroreflective Bands
- † Temporary Sign
- ± Barricades
- K-Rail
- Direction of Travel
- ↪ Turn Arrow
- ▨ Road Closure
- Ⓢ Signalized Intersection
- †• Temporary Sign with Traffic Cone

**ROAD CLOSURE NOTE:**  
CONTRACTOR TO NOTIFY BUSINESS OWNERS CONSTRUCTION ACTIVITIES, ROAD CLOSURE AND SCHEDULE TWO WEEKS PRIOR TO START WORK.

**TRAFFIC SIGNS**

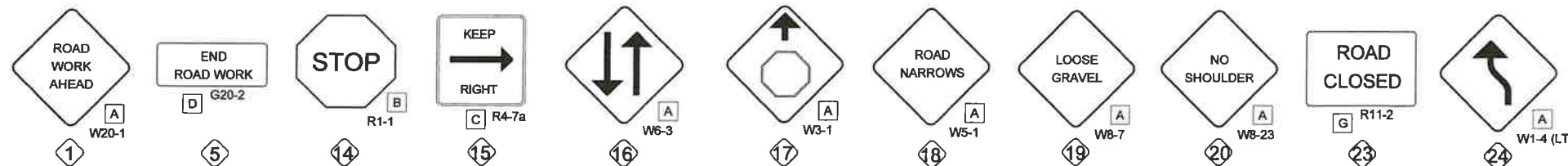

**Dynamic CONSULTING ENGINEERS**  
CIVIL ENGINEERING - LAND SURVEYING - CONSTRUCTION MANAGEMENT  
2415 IMPERIAL BUSINESS PARK DRIVE, SUITE B.,  
IMPERIAL CA. 92251  
TEL. (760) 645-0182 FAX (760) 645-0183

REV.	DATE	REVISION DESCRIPTION	PREPARED UNDER THE DIRECT SUPERVISION OF:		COUNTY OF IMPERIAL PUBLIC WORKS DEPARTMENT APPROVED FOR CONSTRUCTION BY:		PUBLIC WORKS DEPARTMENT COUNTY OF IMPERIAL EL CENTRO, CALIFORNIA		ROAD REHABILITATION PROJECT FOR VARIOUS COUNTY ROADS AT GATEWAY OF THE AMERICAS COUNTY PROJECT NO. 6622GTW		TRAFFIC CONTROL PLAN NINA LEE RD PHASE 2	
				CARLOS BELTRAN, P.E.	69121 R.C.E. No.		JOHN A. GAY, P.E.	62028 R.C.E. No.	DATE 5/14/2025	DB, FM	REFERENCE R-999	PAGE 20 OF 21
				DATE 6/2/25	06/30/2026 REG. EXP.		DATE 6/2/25	09/30/2025 REG. EXP.		CB		



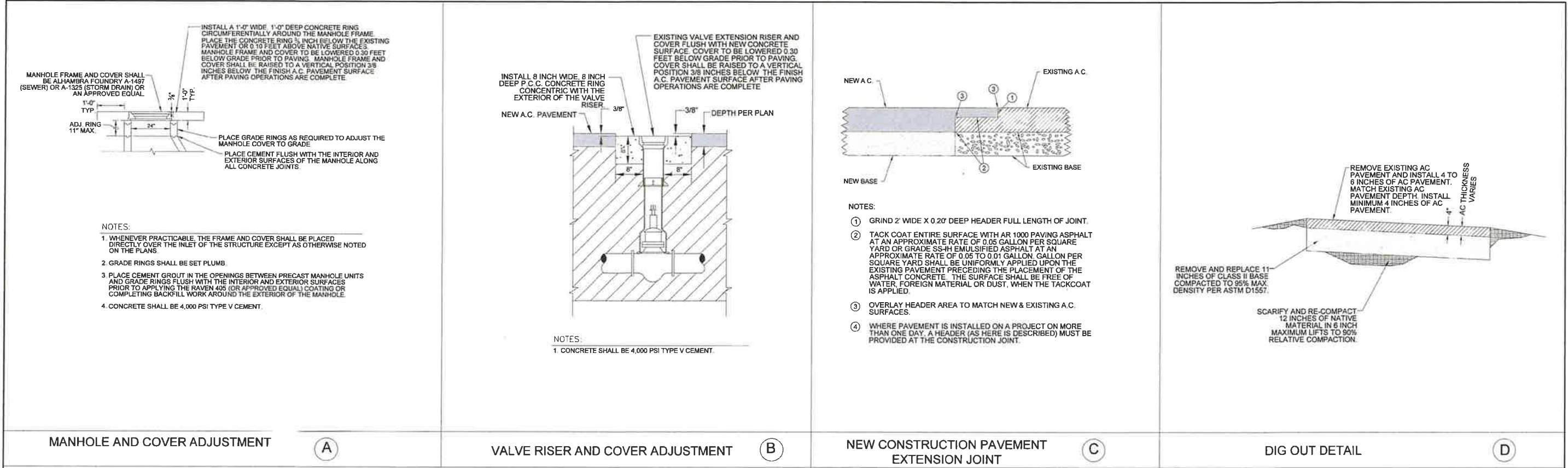

REV.	DATE	REVISION DESCRIPTION	<div><div><div>CARLOS BELTRAN No. 89121 EXP. 0-30-28 CIVIL STATE OF CALIFORNIA</div></div><div><div>PREPARED UNDER THE DIRECT SUPERVISION OF:</div><div><div>CARLOS BELTRAN, P.E.</div><div>06/12/25 DATE</div></div><div><div>89121 R.C.E. No.</div><div>06/30/2026 REG. EXP.</div></div></div></div> <td rowspan="5"><div><div><div>COUNTY OF IMPERIAL PUBLIC WORKS DEPARTMENT APPROVED FOR CONSTRUCTION BY:</div><div><div>JOHN A. GAY, P.E.</div><div>6/12/25 DATE</div></div><div><div>62028 R.C.E. No.</div><div>09/30/2025 REG. EXP.</div></div></div></div><td rowspan="5"><div><div><div>COUNTY OF IMPERIAL EL CENTRO, CALIFORNIA</div></div></div></td><td rowspan="5"><div><div><div>PUBLIC WORKS DEPARTMENT COUNTY OF IMPERIAL EL CENTRO, CALIFORNIA</div></div></div></td><td rowspan="5"><div><div><div>DATE 5/14/2025</div><div>DRAWN DB, FM</div><div>SCALE AS SHOWN</div><div>CHECKED CB</div></div></div></td><td rowspan="5"><div><div>ROAD REHABILITATION PROJECT FOR VARIOUS COUNTY ROADS AT GATEWAY OF THE AMERICAS</div><div>COUNTY PROJECT NO. 6622GTW</div></div></td><td colspan="2">DETAILS</td></td>	<div><div><div>COUNTY OF IMPERIAL PUBLIC WORKS DEPARTMENT APPROVED FOR CONSTRUCTION BY:</div><div><div>JOHN A. GAY, P.E.</div><div>6/12/25 DATE</div></div><div><div>62028 R.C.E. No.</div><div>09/30/2025 REG. EXP.</div></div></div></div> <td rowspan="5"><div><div><div>COUNTY OF IMPERIAL EL CENTRO, CALIFORNIA</div></div></div></td> <td rowspan="5"><div><div><div>PUBLIC WORKS DEPARTMENT COUNTY OF IMPERIAL EL CENTRO, CALIFORNIA</div></div></div></td> <td rowspan="5"><div><div><div>DATE 5/14/2025</div><div>DRAWN DB, FM</div><div>SCALE AS SHOWN</div><div>CHECKED CB</div></div></div></td> <td rowspan="5"><div><div>ROAD REHABILITATION PROJECT FOR VARIOUS COUNTY ROADS AT GATEWAY OF THE AMERICAS</div><div>COUNTY PROJECT NO. 6622GTW</div></div></td> <td colspan="2">DETAILS</td>	<div><div><div>COUNTY OF IMPERIAL EL CENTRO, CALIFORNIA</div></div></div>	<div><div><div>PUBLIC WORKS DEPARTMENT COUNTY OF IMPERIAL EL CENTRO, CALIFORNIA</div></div></div>	<div><div><div>DATE 5/14/2025</div><div>DRAWN DB, FM</div><div>SCALE AS SHOWN</div><div>CHECKED CB</div></div></div>	<div><div>ROAD REHABILITATION PROJECT FOR VARIOUS COUNTY ROADS AT GATEWAY OF THE AMERICAS</div><div>COUNTY PROJECT NO. 6622GTW</div></div>	DETAILS	
REFERENCE	PAGE									
R-999	21 OF 21									

Dynamic

CONSULTING  
ENGINEERS

CIVIL ENGINEERING - LAND SURVEYING - CONSTRUCTION MANAGEMENT

2415 IMPERIAL BUSINESS PARK DRIVE, SUITE B.,  
IMPERIAL CA. 92251

TEL. (760) 545-0152 FAX (760) 545-0163