

PROJECT NO.: A00GWOJ  
SPECIFICATION: WR 34945

# WESTERN REGION MAINTENANCE PROJECTS

SALTON, CA TO  
CALEXICO, CA  
FTA CABLE

RELOCATION OF CONDUITS AND CABLES  
DOGWOOD RD NEAR WILLOUGHBY RD  
COUNTY OF IMPERIAL, CA



CONSTRUCTION DRAWINGS  
DECEMBER 10, 2021

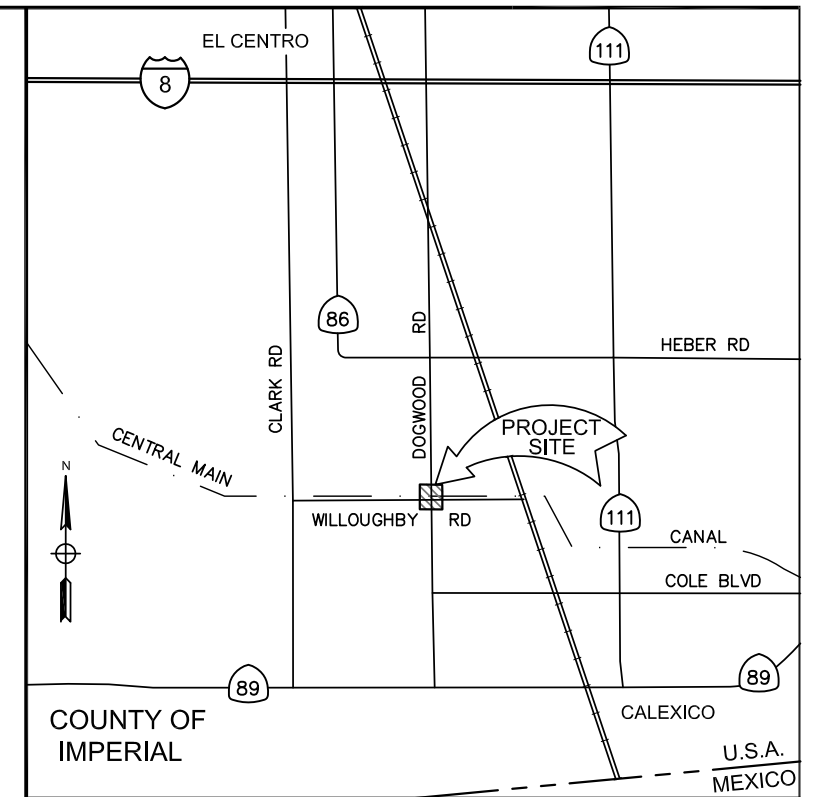

VICINITY MAP  
N.T.S.



2-17-22

FORKERT ENGINEERING & SURVEYING INC.  
22311 BROOKHURST ST., STE. 203  
HUNTINGTON BEACH, CALIFORNIA 92646  
PHONE: (714) 963-6793

LINE SYMBOLOGY

—— ———	EDGE OF PAVEMENT
—————	CENTERLINE
—————	RIGHT-OF-WAY
	RAILROAD TRACKS
—— AT&T ——	UTILITY- EXIST. AT&T FIBER OPTIC CABLE
—— G ——	UTILITY-GAS
—— T ——	UTILITY-TELEPHONE
—— F.O. ——	UTILITY-FIBER OPTIC
—————	PROPOSED AT&T F.O.
— C ——— F ———	PROP. CUT/FILL LIMITS

SYMBOLS

⊖	UTILITY POLE WITH ANCHOR
□	AT&T MANHOLE
▲	AT&T MARKER
Ⓐ	CURVE DATA
⊕	WATER VALVE
Ⓧ	SIGN

LIST OF DRAWINGS

<u>DRAWING</u>	<u>TITLE</u>
	COVER SHEET
WR 34945-232-1 THRU WR 34945-232-2	SALTON TO CALEXICO FTA CABLE LIST OF DRAWINGS AND NOTES
WR 34945-232-3 THRU WR 34945-232-6	SALTON TO CALEXICO FTA CABLE DETAIL CONSTRUCTION DRAWING

ABBREVIATIONS

ASPH.	ASPHALT	I.D.	INNER DUCTS
AT&T	AMERICAN TELEPHONE AND TELEGRAPH	INV.	INVERT
AC	ASPHALT CONCRETE	L.F.	LINEAL FEET
BLVD.	BOULEVARD	M.H.	MANHOLE
CA.	CALIFORNIA	MIN.	MINIMUM
C.B.	CATCH BASIN	MKR.	MARKER
☉	CENTERLINE	OP	OVERPASS
CLSR.	CLOSURE	PL.	PLACE
CONC.	CONCRETE	ℙ	PROPERTY LINE
CMP	CORRUGATED METAL PIPE	PED	PEDESTAL
C.S.M.	COUNTY SURVEYOR MONUMENT	PLAS.	PLASTIC
CU. FT.	CUBIC FEET	P.P.	POWER POLE
DU.	DUCT	PROP.	PROPOSED
DWG.	DRAWING	P.V.C.	POLYVINYL CHLORIDE
ENCASE.	ENCASEMENT	R.R.	RAILROAD
E.P.	EDGE OF PAVEMENT	R/W	RIGHT-OF WAY
EXIST.	EXISTING	SEC.	SECTION
EXT	EXTENSION	SMH	SEWER MANHOLE
FD.	FOUND	STA.	STATION
F. & C.	FRAME AND COVER	ST.	STREET
FG	FINISH GRADE	SQ. FT.	SQUARE FEET
F.H.	FIRE HYDRANT	TBR	TO BE REMOVED
F.O.	FIBER OPTIC	TYP.	TYPICAL
FTG	FOOTING	UP	UNDERPASS
FUT.	FUTURE	UGE	
G.I.P.	GALVANIZED IRON PIPE	W/	WITH
HDPE	HIGH DENSITY POLYETHYLENE	WL	WILD LIFE
HWY	HIGHWAY	W.M.	WATER METER
		W.V.	WATER VALVE
		W.W.	WALL TO WALL



2-17-22

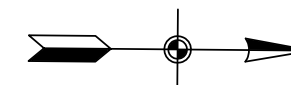

REVISIONS:

NOTES:



PREPARED FOR RECORD	
APPROVED FOR OUTSIDE PLANT	TANYA HERNANDEZ ENGINEER DATE
FORKERT ENGINEERING & SURVEYING, INC. 22311 BROOKHURST ST., SUITE 203 HUNTINGTON BEACH, CA 92646 PHONE: (714) 963-6793	
PROPRIETARY USE PURSUANT TO COMPANY INSTRUCTIONS SPECIFICATION WR 34945 PROJECT NUMBER	
OWNERSHIP:	ISD 100%
LINE CODE:	
CABLE CLLI:	SLTNCAU0010
SCALE:	1" = 20'
SALTON TO CALEXICO, CA 417 Mb/s LIGHTGUIDE SYSTEM	
SALTON TO CALEXICO FTA CABLE	
WR 34945-232-1	

## CONSTRUCTION NOTES

1. ALL COVER DEPTHS INDICATED ON DRAWINGS ARE MEASURED FROM GRADE TO TOP OF CONDUIT IN CONCRETE ENCASEMENT OR TO TOP OF DIRECT BURIED CABLE AND DIRECT BURIED CONDUIT.
2. MINIMUM COVER FOR STRUCTURE SHALL BE 42" MINIMUM BELOW PROPOSED FINISHED GRADE OR AS REQUIRED BY PERMITS ISSUED BY THE GOVERNING AGENCIES. (SEE PLANS)
3. PLACE MARKING TAPE CONTINUOUSLY ALONG THE TRENCH LINE AT 18" BELOW FINISHED SURFACE.
4. SHORE TRENCH AS REQUIRED BY O.S.H.A. STANDARDS.
5. CONTRACTOR SHALL POTHOLE EXISTING CABLE FOR LOCATION PRIOR TO CONSTRUCTION. AT&T OPERATIONS SHALL BE NOTIFIED BEFORE COMMENCING THIS OPERATION.
6. THE CONTRACTOR SHALL FURNISH A PROFESSIONAL LICENSED AND BONDED GUARD AT THE WORK SITE WHENEVER THE FIBER OPTIC CABLE IS LEFT EXPOSED DURING NON-WORKING HOURS (OVERNIGHT, WEEKENDS AND HOLIDAYS). NO ADDITIONAL COMPENSATION WILL BE ALLOWED FOR THIS WORK.

## GENERAL NOTES

1. UTILITIES AND SUBSTRUCTURES SHOWN HEREON ARE BASED ON AVAILABLE RECORDS AND ARE APPROXIMATE. THE CONTRACTOR SHALL VERIFY, LOCATE AND PROTECT IN PLACE AS REQUIRED.
2. BEFORE EXCAVATING CALL:  
DIGALERT 811 OR (800) 422-4133
3. CONTRACTOR MUST NOTIFY BLUESTAKE TWO FULL WORKING DAYS BEFORE BEGINNING EXCAVATION.
4. ALL TRAFFIC CONTROL TO BE IN ACCORDANCE WITH LOCAL PERMITTING AGENCY STANDARDS AND REQUIREMENTS.

CALL DIG ALERT AT 811 OR (800) 422-4133  
TWO FULL WORKING DAYS  
PRIOR TO CONSTRUCTION



2-17-22

## METHOD OF PROCEDURE

THIS METHOD OF PROCEDURE IS INTENDED TO OUTLINE SPECIFIC STEPS TO BE FOLLOWED WHILE INTERCEPTING AND/OR RELOCATING CONDUIT W/ FLEXIBLE INNERDUCT CONNECTED TO AN ACTIVE FIBER OPTIC CABLE. THE FOLLOWING GUIDELINES SHALL BE FOLLOWED EXPLICITLY ALONG WITH ANY ADDITIONAL MEASURES SPECIFIED BY AT&T OPERATIONS PERSONNEL.

1. AT&T OPERATIONS SHALL LOCATE AND MARK THE APPROXIMATE ALIGNMENT OF THE EXISTING LIGHTGUIDE SYSTEM.
2. THE CONTRACTOR SHALL EXCAVATE BY HAND AND/OR MECHANICAL METHOD TO EXPOSE THE ACTIVE LIGHTGUIDE SYSTEM IN A CAREFUL AND PRUDENT MANNER AND ONLY WITH THE APPROVAL AND SUPERVISION OF AT&T OPERATIONS STAFF. THE AREA OVER AND ALONG THE EXISTING ACTIVE LIGHTGUIDE SYSTEM SHALL BE EXCAVATED TO SUFFICIENT WIDTH TO ALLOW CONSTRUCTION PERSONNEL TO HANDLE THE CABLE IN A SAFE, DILIGENT AND WORKMANLIKE MANNER.
3. AFTER THE COVER HAS BEEN REMOVED, THE EXPOSED CONDUIT SYSTEM CAN BE PREPARED FOR INTERCEPTING. AT&T OPERATIONS PERSONNEL SHALL UNROCK THE CABLE COILS IN THE ADJACENT MANHOLES AND SHALL STATION THEMSELVES IN THE MANHOLE DURING THE CONDUIT LOWERING OR MOVING PROCEDURE TO OBSERVE CABLE MOVEMENT. PROTECT THE CABLE FROM DAMAGE, AND INSURE THAT EXISTING PULL ROPES ARE PROPERLY SECURED. IF, IN THE EVENT THERE IS EXTRA LENGTH OF FLEXIBLE INNERDUCT IN THE ADJACENT MANHOLES, AT&T OPERATIONS PERSONNEL SHALL ALSO OBSERVE ITS MOVEMENT AND ALLOW IT TO RETRACT INTO THE CONDUIT ONLY SO FAR AS IT IS REASONABLE PRUDENT TO DO SO. BY NO MEANS SHALL THE END OF THE INNERDUCT BE ALLOWED TO RETRACT INTO THE CONDUIT. THE END OF THE INNERDUCT MUST BE SECURED IN A MANNER SO AS NOT TO ALLOW THIS TO HAPPEN.
4. THE CONDUIT SHALL BE LOWERED GENTLY TO THE FINAL ELEVATION SHOWN ON THE DRAWINGS TO PROVIDE THE CLEARANCE REQUIRED FROM THE PROPOSED STRUCTURE.
5. TRENCH BACKFILL SHALL BE PLACED IN ACCORDANCE WITH AT&T STANDARD DETAILS AND SPECIFICATIONS AS WELL AS COMPLYING WITH THE STANDARDS AND SPECIFICATIONS FOR TRENCH BACKFILL AND COMPACTION REQUIREMENTS OF LOCAL PERMITTING AGENCY.
6. ALL WORK REQUIRING TRAFFIC CONTROL SHALL BE CONDUCTED PER THE CONDITIONS OF THE PERMIT. TRENCH CLOSURE PLATING AND DAILY SITE CLEANUP SHALL BE DONE AS SPECIFIED BY AT&T PERSONNEL.
7. CONTRACTOR SHALL REMOVE AND REPLACE CABLE MARKING RIBBON AS SPECIFIED BY THE AT&T OPERATIONS TECHNICIAN.
8. THE CONTRACTOR IS RESPONSIBLE FOR NOTIFYING ARIZONA 811 TWO FULL WORKING DAYS PRIOR TO COMMENCEMENT OF WORK AT THIS LOCATION.
9. THE CONTRACTOR IS REFERRED TO SECTION 102.03 "GUIDELINES FOR WORKING NEAR PLANT" IN PART 2 OF STANDARD CONSTRUCTION SPECIFICATIONS FOR LIGHTGUIDE CABLE CONSTRUCTION.

EXTREME CAUTION SHOULD  
BE TAKEN WHILE WORKING  
AROUND AN ACTIVE  
LIGHTGUIDE CABLE.

72 HOURS PRIOR TO WORK, CONTACT AT&T  
MAINTENANCE MANAGER, KENT CRUIZ AT  
(619) 574-2000 OR  
EMERGENCY CONTACT AT (800) 252-1133

**! CAUTION !**  
**AT&T CABLE IN VICINITY**  
NO WORK SHALL BE PERFORMED  
WITHOUT AT&T OPERATIONS  
PERSONNEL PRESENT.

**! CAUTION !**  
POWER LINES & HP GAS IN VICINITY  
CONTRACTOR SHALL LOCATE,  
VERIFY & PRIOR TO CONSTRUCTION

REVISIONS:

NOTES:



PREPARED FOR RECORD  
APPROVED FOR TANYA HERNANDEZ  
OUTSIDE PLANT ENGINEER DATE  
FORKERT ENGINEERING &  
SURVEYING, INC.  
22311 BROOKHURST ST., SUITE 203  
HUNTINGTON BEACH, CA 92646  
PHONE: (714) 963-6793  
PROPRIETARY  
USE PURSUANT TO COMPANY INSTRUCTIONS  
SPECIFICATION WR 34945  
PROJECT NUMBER  
OWNERSHIP: ISD 100%  
LINE CODE:  
CABLE CLLI: SLTNC AU0010  
SCALE: 1" = 20'  
SALTON TO  
CALEXICO, CA  
417 Mb/s  
LIGHTGUIDE SYSTEM  
SALTON TO  
CALEXICO  
FTA CABLE

WR 34945-232-2

REVISIONS:

NOTES:

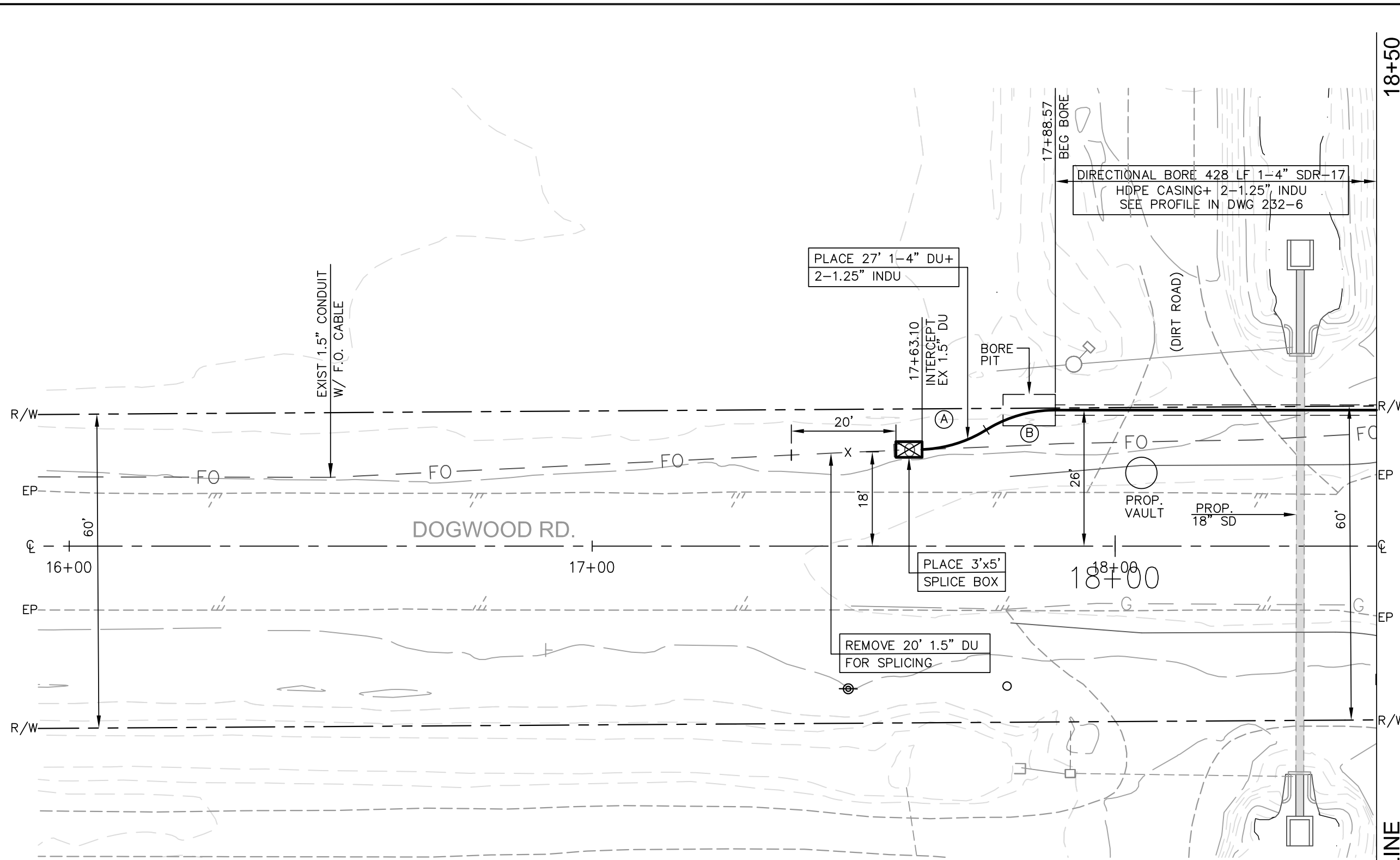

SEE DWG 232-4

MATCHLINE

CURVE	RADIUS	DELTA	LENGTH
(A)	25'	29°43'28"	12.97'
(B)	25'	31°53'47"	13.92'



2-17-22

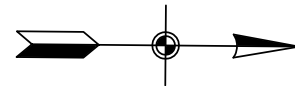

PREPARED FOR RECORD  
 APPROVED FOR TANYA HERNANDEZ  
 OUTSIDE PLANT ENGINEER DATE  
 FORKERT ENGINEERING & SURVEYING, INC.  
 22311 BROOKHURST ST., SUITE 203  
 HUNTINGTON BEACH, CA 92646  
 PHONE: (714) 963-6793

PROPRIETARY  
 USE PURSUANT TO COMPANY INSTRUCTIONS  
 SPECIFICATION WR 34945  
 PROJECT NUMBER

OWNERSHIP: ISD 100%  
 LINE CODE:  
 CABLE CLLI: SLTNC AU0010

SCALE: 1" = 20'

SALTON TO CALEXICO, CA  
 417 Mb/s  
 LIGHTGUIDE SYSTEM  
 SALTON TO CALEXICO  
 FTA CABLE

WR 34945-232-3

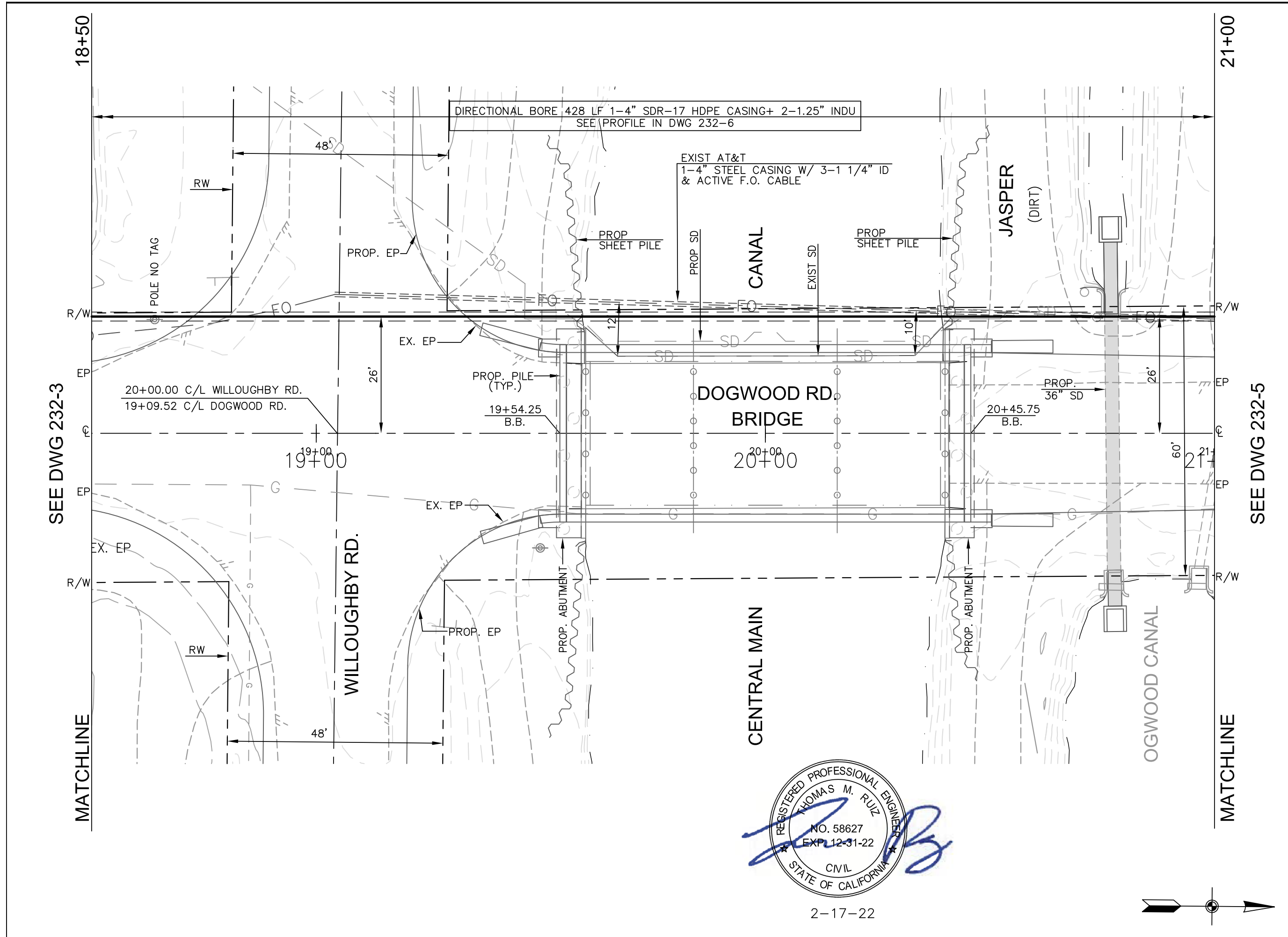

REVISIONS:

NOTES:



PREPARED FOR RECORD  
 APPROVED FOR TANYA HERNANDEZ  
 OUTSIDE PLANT ENGINEER DATE  
 FORKERT ENGINEERING & SURVEYING, INC.  
 22311 BROOKHURST ST., SUITE 203  
 HUNTINGTON BEACH, CA 92646  
 PHONE: (714) 963-6793

PROPRIETARY  
 USE PURSUANT TO COMPANY INSTRUCTIONS  
 SPECIFICATION WR 34945  
 PROJECT NUMBER

OWNERSHIP: ISD 100%  
 LINE CODE:  
 CABLE CLLI: SLTNCAU0010

SCALE: 1" = 20'

SALTON TO CALEXICO, CA  
 417 Mb/s LIGHTGUIDE SYSTEM  
 SALTON TO CALEXICO FTA CABLE

WR 34945-232-4



2-17-22

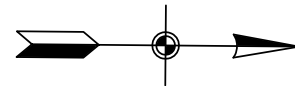

REVISIONS:

NOTES:

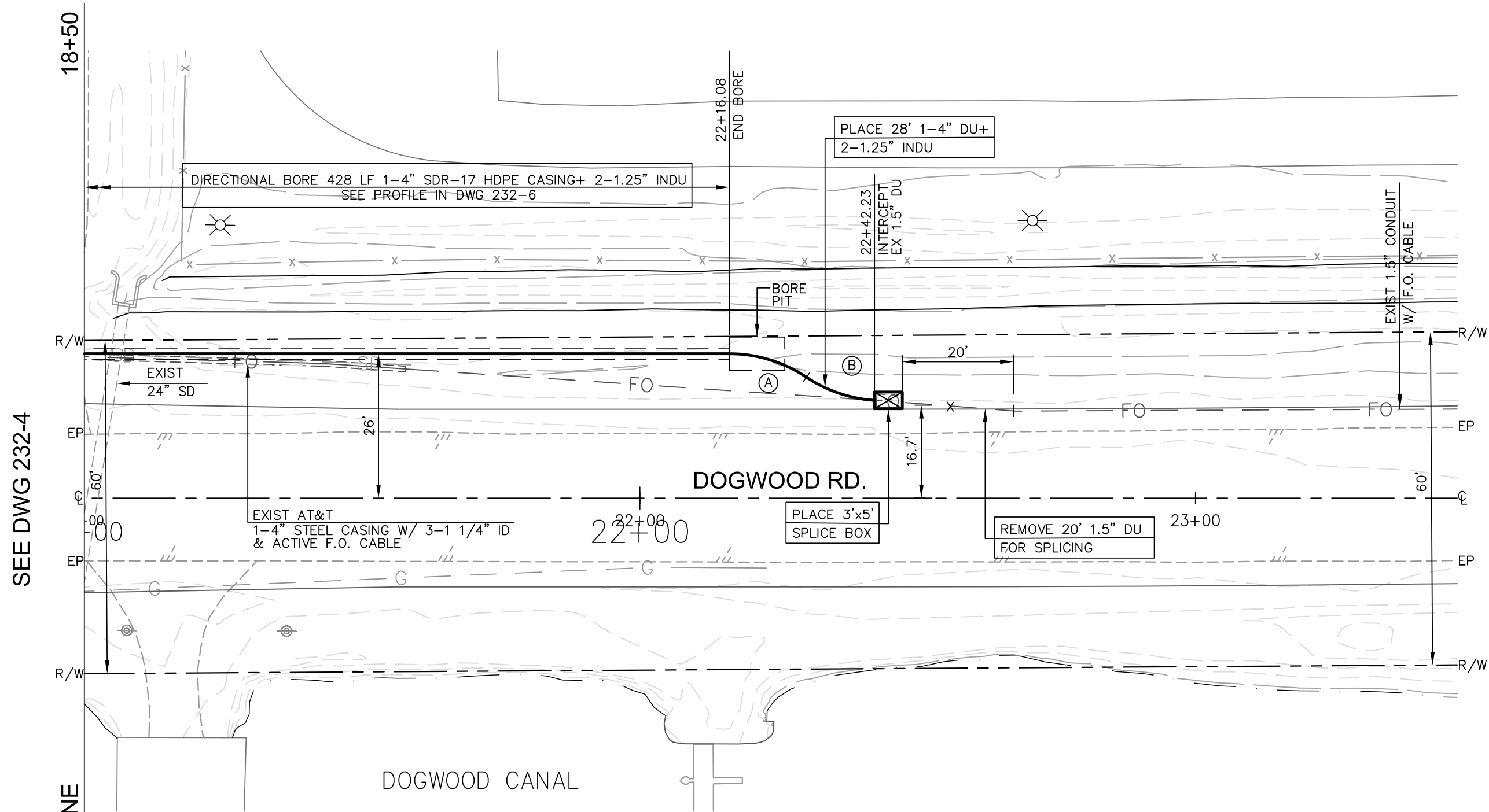

SEE DWG 232-4

MATCHLINE



CURVE	RADIUS	DELTA	LENGTH
(A)	25'	35°34'53"	15.53'
(B)	25'	31°10'36"	13.60'

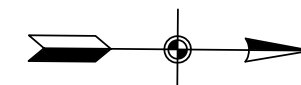

PREPARED FOR RECORD  
 APPROVED FOR TANYA HERNANDEZ  
 OUTSIDE PLANT ENGINEER DATE

FORKERT ENGINEERING & SURVEYING, INC.  
 22311 BROOKHURST ST., SUITE 203  
 HUNTINGTON BEACH, CA 92646  
 PHONE: (714) 963-6793

PROPRIETARY  
 USE PURSUANT TO COMPANY INSTRUCTIONS  
 SPECIFICATION WR 34945  
 PROJECT NUMBER

OWNERSHIP: ISD 100%  
 LINE CODE:  
 CABLE CLLI: SLTNC AU0010

SCALE: 1" = 20'

SALTON TO CALEXICO, CA  
 417 Mb/s  
 LIGHTGUIDE SYSTEM  
 SALTON TO CALEXICO  
 FTA CABLE

WR 34945-232-5

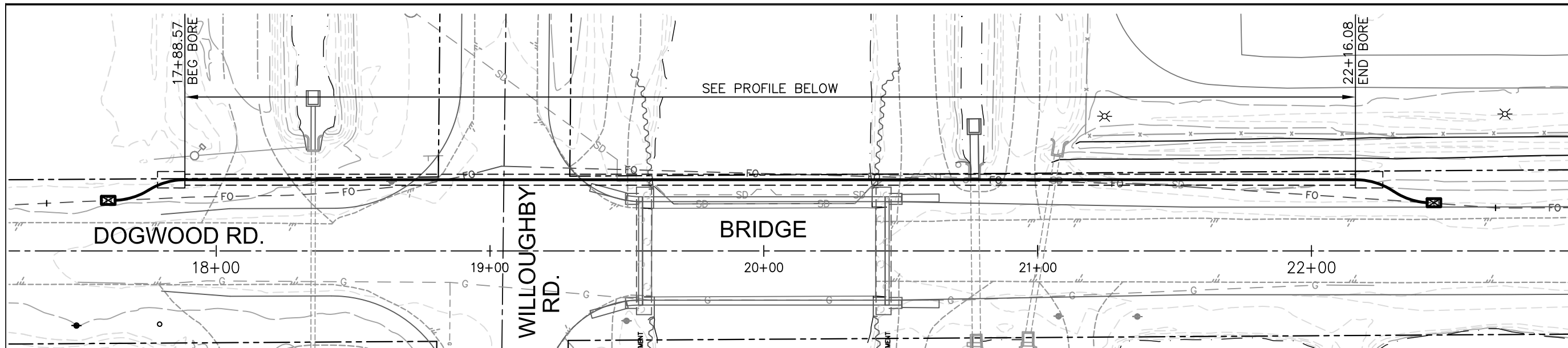

**PLAN**  
1"=40'

**BORING NOTES:**

1. POTHOLE SUBSTRUCTURES AS REQUIRED DURING BORING OPERATIONS.
2. FILL CASING WITH SLURRY AND SEAL ENDS.

ELEVATIONS ARE TO TOP OF CONDUIT

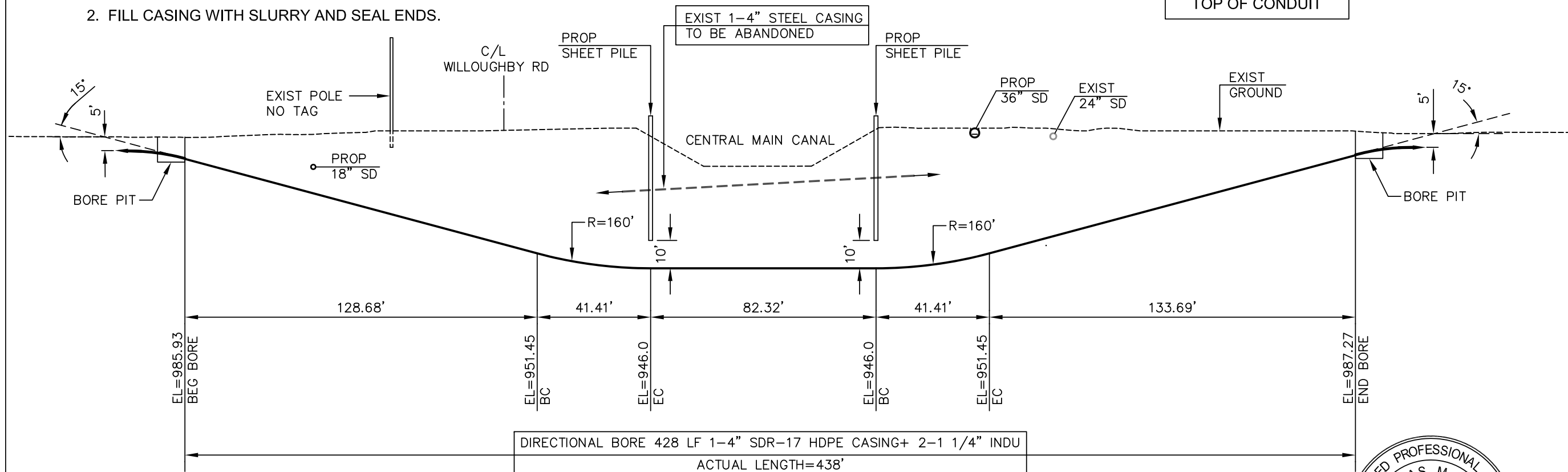

**PROFILE**  
HORZ: 1"=40'  
VERT: 1"=40'



REVISIONS:
NOTES:
PREPARED FOR RECORD
APPROVED FOR TANYA HERNANDEZ OUTSIDE PLANT ENGINEER DATE
FORKERT ENGINEERING & SURVEYING, INC. 22311 BROOKHURST ST., SUITE 203 HUNTINGTON BEACH, CA 92646 PHONE: (714) 963-6793
PROPRIETARY USE PURSUANT TO COMPANY INSTRUCTIONS SPECIFICATION WR 34945 PROJECT NUMBER
OWNERSHIP: ISD 100% LINE CODE: CABLE CLLI: SLTNC AU0010
SCALE: AS SHOWN
SALTON TO CALEXICO, CA 417 Mb/s LIGHTGUIDE SYSTEM SALTON TO CALEXICO FTA CABLE
2-17-22
WR 34945-232-6